

A project by



Harihara's **SRI SAI**
VIRADHIYA

Love. Live. Leisure



PEERZADIGUDA, UPPAL



Harihara's **SRI SAI VIRADHYA**
Love. Live. Leisure

LIVE THE LIFE YOU LOVE



HIGH RISE Gated Community, in 2 Acres.



10 Floors + 2 Basements + 1 Stilt



Total Flats: 214 (3 BHK Only)



Flat Size: 1458 sft - 2359 sft



Clubhouse 12500 Square feet



AMENITIES & FEATURES



Badminton Court



Children's Play Area



Half Basketball Court



Skating Area



Elder's Sitting Area



Intercom Facility



Electric Car Charging Station



Car Wash Facility



Lush Green Landscaping



Premium Quality Construction



Vaastu-Compliant



CRAFTED WITH LOVE TO COMPLIMENT YOUR LIFESTYLE

LITTLE LUXURIES TO PAMPER YOUR INNER EPICURE

COMFORT OF A CLUBHOUSE



Swimming Pool



Conference Hall



Dining Hall



Guest Rooms



Gymnasium



Home Theater



Indoor Games



Meeting Room



Society Office



TYPICAL FLOOR PLAN

EXPERIENCE THE LIFESTYLE MEANT FOR YOU

Spread across 2 acres, Harihara's Sri Sai Viradhya is a high rise gated community located in Peerzadiguda near Uppal within 400 meters from the Warangal Highway. The luxury 3 BHK homes with modern amenities and robust architecture enable one to live life to its fullest without giving up on desires and comfort. The community is close to the urban facilities making it more desirable for those who look for a secured and flexible housing location for their family

Harihara's SRI SAI VIRADHYA

Love. Live. Leisure

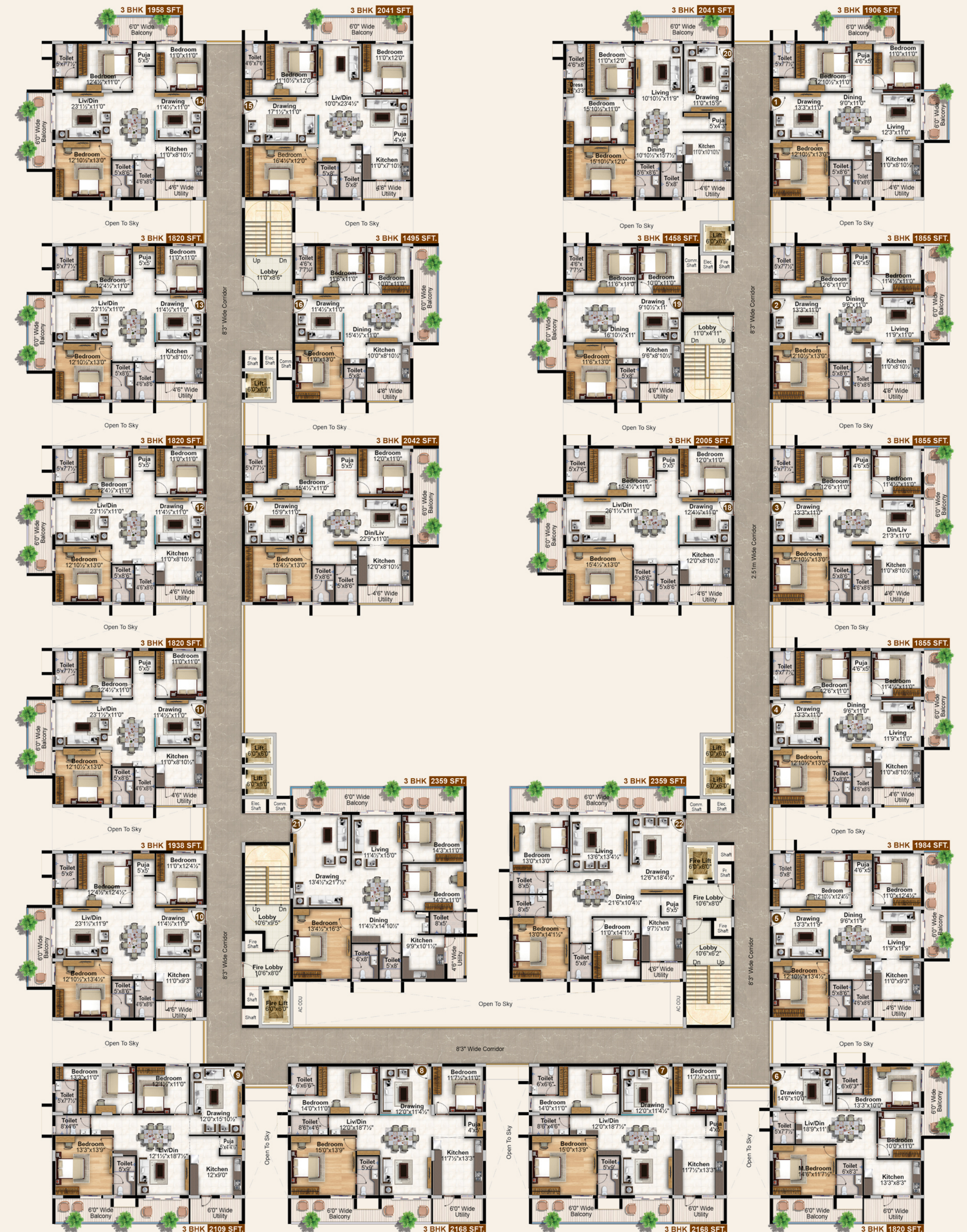

SPECIFICATIONS

FOUNDATION & STRUCTURE	RCC framed structure to withstand wind & seismic loads.
WALLS	Cement Blocks with 8" thick external walls and 4" thick internal walls Internal : Smooth cement plastering finish External : Double coat cement plastering finish
PAINTING	External: Textured finish or putty with 2 coats of exterior emulsion paint of reputed make Internal: Premium Emulsion Paint of reputed make with roller finishing over luppam finish
FLOORING	Living/drawing, dining, all bedrooms & kitchen: 800 x 800 mm size double charged vitrified tiles of reputed make Bathrooms/balcony/utility: Anti-skid vitrified/ceramic tiles of reputed make Corridors: Granite flooring as per architect design Staircase: Tandoor Polished stone
DADOING	Kitchen: Ceramic tiles up to 2'- 0" height above kitchen countertop of reputed make Utilities: Ceramic tiles of reputed make, up to 3' - 0" height of reputed make Bathrooms: Ceramic tiles of reputed make, up to 7' - 0" height of reputed make
DOORS	Main door: Teakwood frame and hardwood teak veneer shutter with polish and SS hardware of reputed make Bedroom doors: Teakwood frame and flush door shutter with laminate finish and SS hardware of reputed make Toilet & Utility Doors : Teakwood frame and flush door with PU polish and SS hardware of reputed make Balcony: UPVC sliding doors with plain glass & mosquito mesh of reputed make.
WINDOWS/GRILLS	Windows: UPVC sliding windows with plain glass & mosquito mesh. Grills: Aesthetically designed, Mild Steel (MS) grills with powder coat finish

KITCHEN/UTILITIES	Granite countertop with a single bowl, stainless steel sink with bore and municipal water connection, along with provision for water purifier and washing machine
BATHROOMS	Wash basins in all toilets, Diverter and Shower in all toilets, Wall-mounted WC in all toilets of reputed make, Premium CP fittings of reputed make, Power provision for geysers in all bathrooms
ELECTRICAL	Concealed copper wiring of reputed make Power outlets for air conditioners in all bedrooms Power outlet for cooking range chimney, refrigerator, microwave oven, mixer/grinder in kitchen Power supply for each unit Miniature Circuit Breakers (MCB) for each distribution boards, of reputed make. Switches of reputed make
TV/TELEPHONE/DATA	One TV point in living room /drawing room and master bedroom and data point in living room/drawing room Telephone & Intercom provision in living/drawing room
LIFTS	High speed automatic passenger/service lifts with rescue device of reputed make Lift lobby with granite as per architect design False Ceiling in all Lift Lobbies.
POWER BACKUP	100% DG backup for lights and fans in all flats (excluding ACs and geysers and other heavy appliances) 100% DG backup for common areas and service/utility area
FIRE & SAFETY	Fire alarm, hydrants and sprinklers as per fire regulations and norms
CAR WASH FACILITY	Provision for Car Wash facility in each cellar parking area.
ELECTRIC CHARGING STATION	Public Electric Charging Station will be provided at a feasible location in car parking area.
PARKING	Entire parking designed to suit the requisite number of car parks at stilt and basement levels.
SECURITY	1) Sophisticated round the clock security system 2) Surveillance cameras at the main security gate, entrance of each tower, passenger lifts, children play area, and appropriate common areas



PROXIMITY

SCHOOLS

- Global Indian International School
- Kendriya Vidyalaya
- Siddhartha Public School
- Sri Chaitanya Techno School

OFFICES

- Infosys
- Genpact
- Survey of India
- NGRI

CONVENIENCE STORES

- Big Bazaar
- Asian Cine Square
- Decathlon Sports
- Metro Super Market

CONNECTIVITY

- Uppal Metro Station
- Uppal Bus Station
- Secunderabad Railway Station
- Shamshabad Airport

HOSPITALS

- Spark Hospital
- Ankura Hospital
- Aditya Hospital
- APEX Hospital

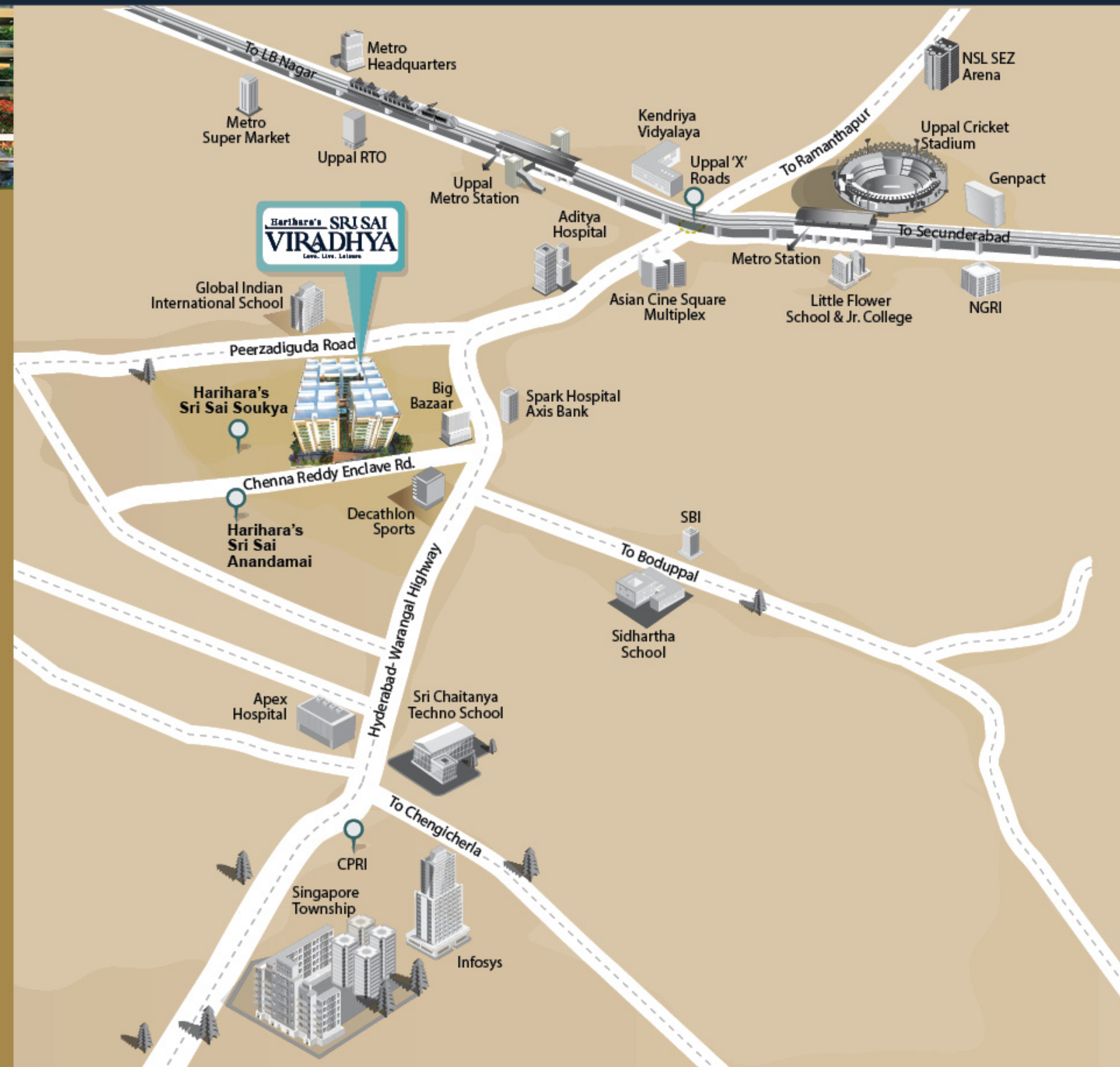

Site Address:

Chennareddy Enclave, Peerzadiguda,
Uppal Depot, Hyderabad - 500 092.

Member Of CREDAI



/hariharaestates



@HariharaEstates

Builders & Developers



SRI SAI HARIHARA ESTATES(P) LTD.

1-7-9/3, 4th Floor, Harihara Estate, Opp. ISI,
St. No. 8, Habsiguda, Hyderabad - 500 007

Contact us: +91 90667 32732, 90668 32832

e-mail: salesharihara@gmail.com,

harihara96@gmail.com

visit us at: www.hariharaestates.com

TS RERA Registration. No. P02200003663