

RESIDENTIAL & COMMERCIAL



A Project by :

**GOLDEN GATE**  
INVESTMENT

Beside Taif Nagar Garden  
Makrand Desai Road,  
VADODARA - 390 012.

For Booking :

+ 91 98250 06404

E. projectafzal01@gmail.com

Architect :

DALVI ASSOCIATES, Vadodara

Structural Consultant :

ZARNA ASSOCIATES, Vadodara

Plumbing Consultant :

AARASP AQUA ENGINEERS, Vadodara

Electrical Consultant :

ORIENTAL ELECTRICALS, Vadodara

Brochure Design :

T SQUARE MEDIA, Vadodara

**AMENITIES:**

- Elegant Society Entrance Gate.
- Security System with CCTV Surveillance.
- High Quality Passenger Lifts & Power backup for Common Areas.
- Firefighting System.
- Ample Parking Space.
- Attractive Number Plates on each Unit.
- Termite Treatment at foundation and plinth.
- Underground & Overhead water tanks with sensor for continuous water supply.



tsm 98892 66193 TANVIR

a project by GOLDEN GATE INVESTMENT









### BASEMENT FLOOR PLAN

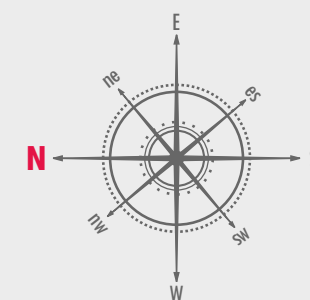

### GROUND FLOOR PLAN

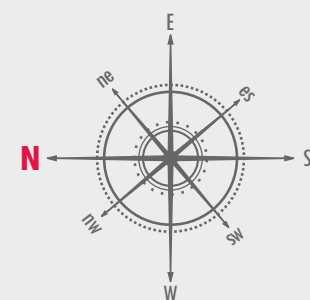
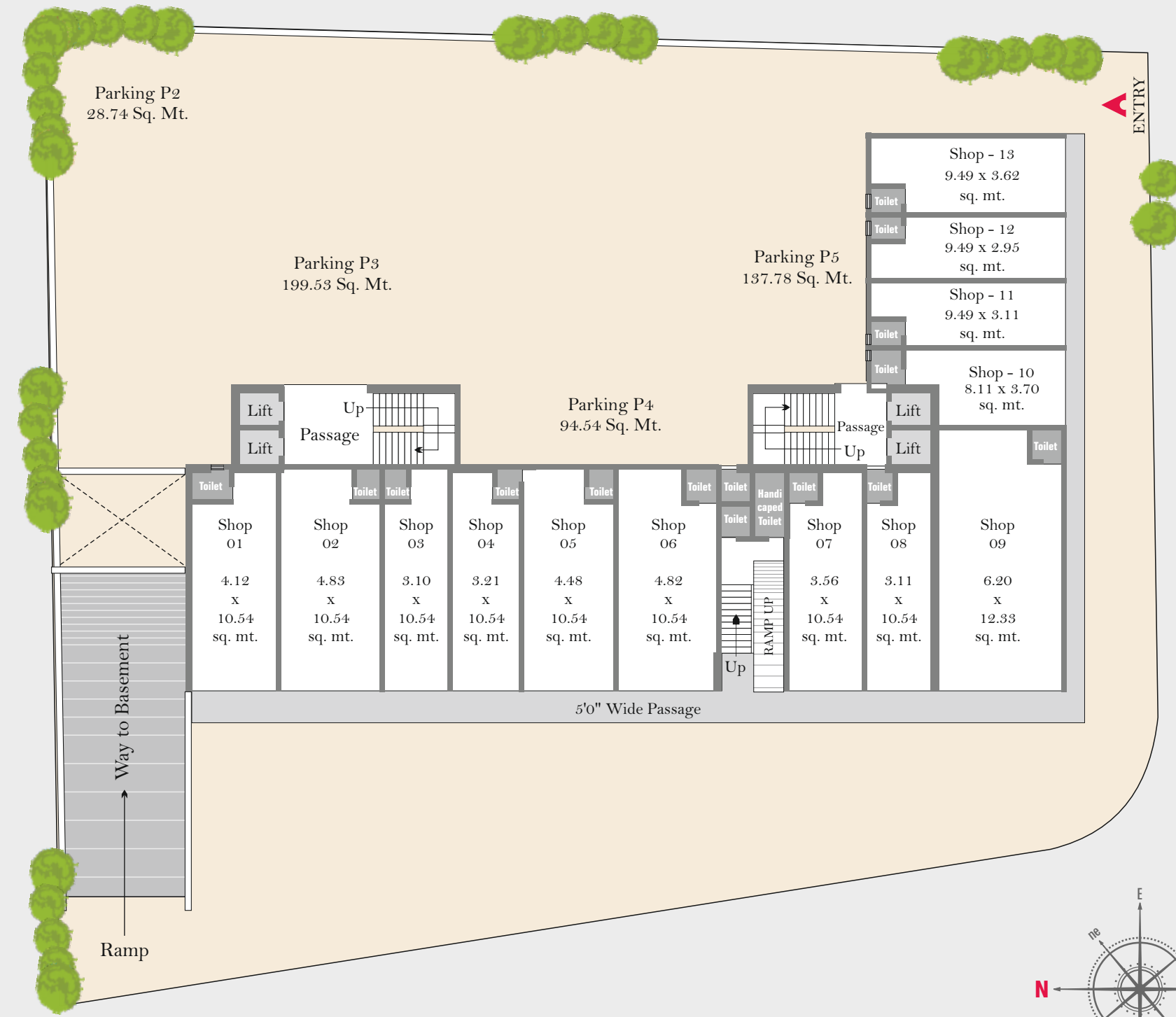



# FIRST FLOOR PLAN



# TYPICAL FLOOR PLAN

### TOWER - "B" 2 BHK

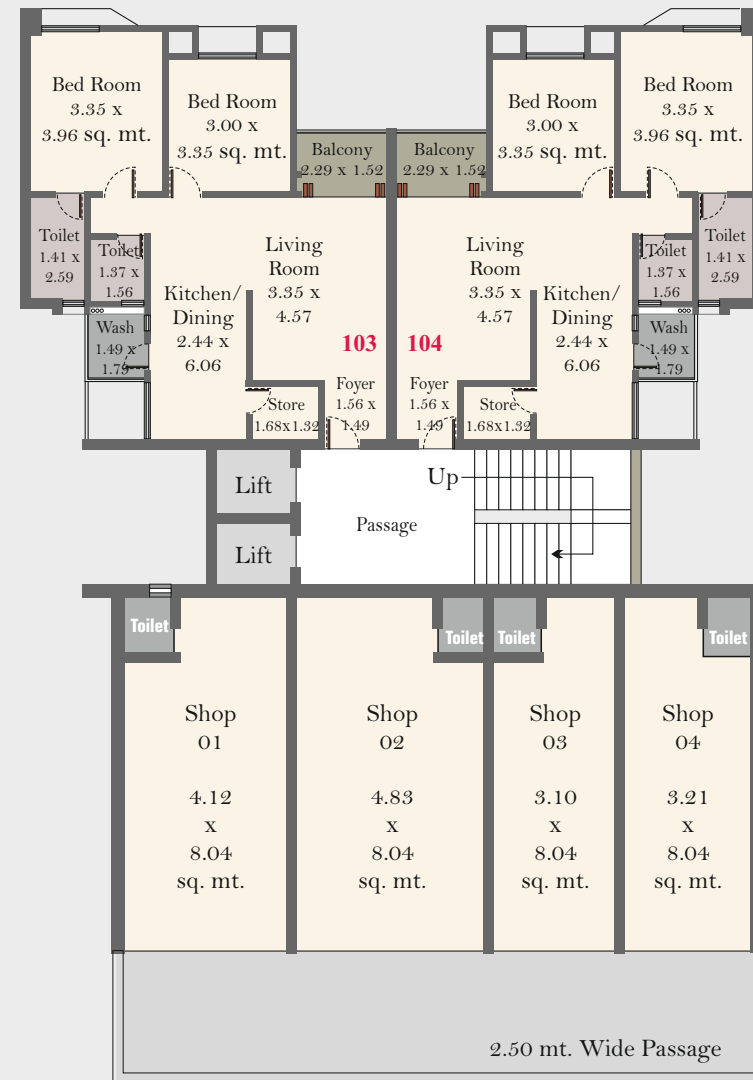

### TOWER - "A" 3 BHK



### TOWER - "B" 2 BHK

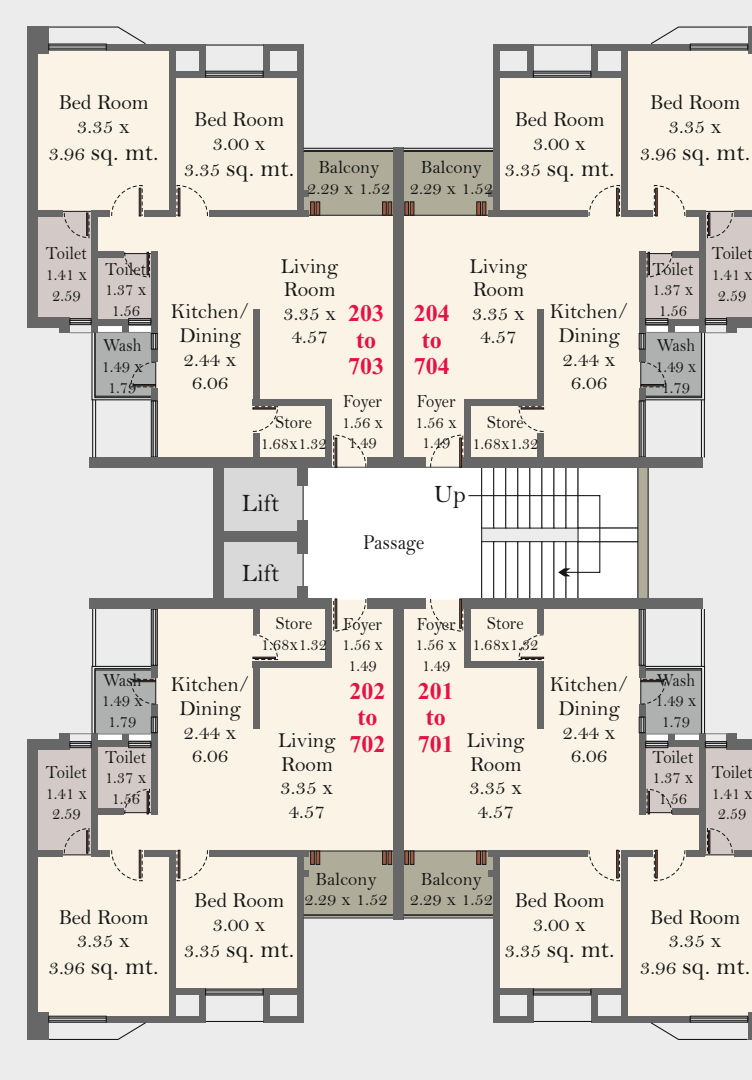

### TOWER - "A" 3 BHK

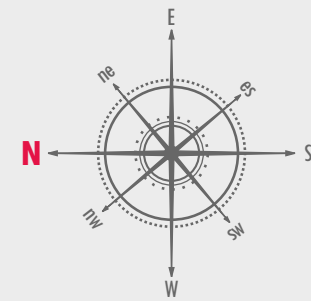





## SPECIFICATIONS

- **STRUCTURE:** Earth-Quake resistant RCC structure & Masonry work as per structural engineer's design.
- **PAINTING:** Internal walls with two coat putty & external walls finished with weatherproof paint.
- **INFRASTRUCTURE:** RCC trimix finish road with paver blocks, street lights.
- **ELECTRIFICATION:** Modular Switches with concealed copper wiring of approved quality, sufficient electrical points as per consultant's details and geyser points in attached Bathrooms.
- **DOORS & WINDOWS:** Decorative main door, Internal both side laminated flush doors & aluminum anodized sliding/openable windows with light safety bars.
- **FLOORING:** Premium Vitrified Tile Flooring.
- **TOILETS:** Designer Bathrooms with tiles upto ceiling level & standard quality sanitary ware.
- **KITCHEN:** Granite kitchen Platform with SS sink & RO point. Tile dado from platform upto ceiling level.



## KEY PLAN

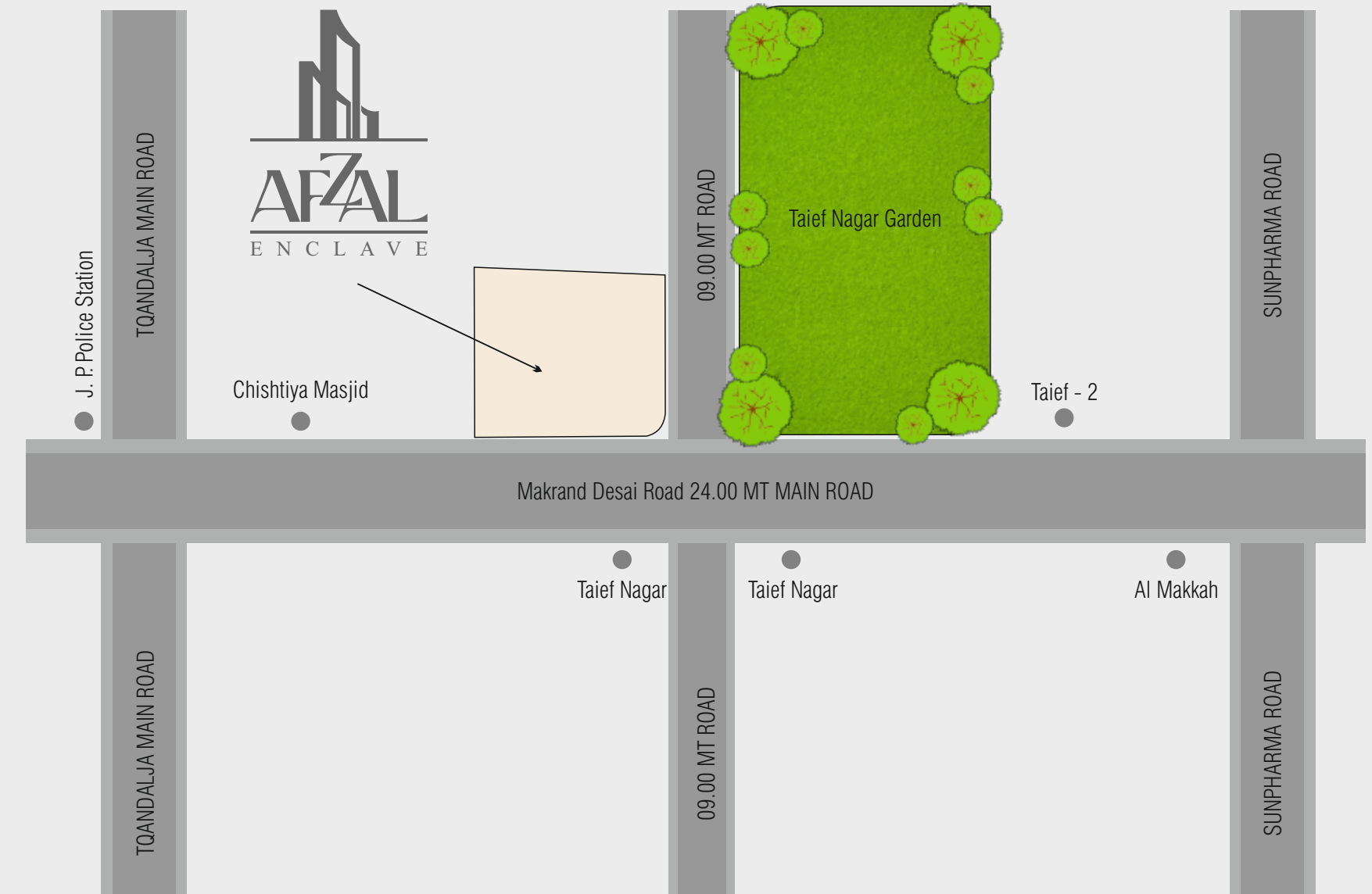

### Notes :

- Documentation charges, stamp duty, all government taxes, GST, MGVCL meter charges & maintenance charge shall be extra.
- House Tax shall be applicable from the period that corporation authority fixes.
- The developers reserve full rights to make any changes.
- In case of cancellation document charges and overheads shall be deducted and balance amount refunded after one month of recovering payment from new booking of same unit.
- Extra work, if any, shall be carried out after receiving advance payment as per estimate.
- Possession will be given after 30 days from the receipt of final payment.
- This brochure does not form a part of agreement or any legal document, it is only a display of the project.
- Subject to Vadodara Jurisdiction.

**Payment Schedule:** 10% on Booking | 20% AFS | 15% Plinth | 25% Still & Slab | 05% Flooring, Colour & Windows 05% Sanitary, Lift & Lobbies | 05% Plumbing, Plaster & Waterproofing | 10% Electric Fittings & Water Pump | 05% At the time of Possession

Above project is registered under Gujerera. Rera Reg. No. : PR/GJ/VADODARA/VADODARA/  
For Further details visit : [www.gujrera.gujarat.gov.in](http://www.gujrera.gujarat.gov.in) under registered project.