



TS RERA APPROVED
NO: P02200009326

ANVITA PARKSIDE

Exceptional 4 BHK Villas
Surrounded by Parks

RAVALKOLE, MEDCHAL

ANVITA PARKSIDE

NESTLE IN NATURE

Imagine an urban retreat with all the elements of refined living.
Imagine an abode surrounded by pure inspiration and opening
to fresh life spaces.

Imagine an idyllic haven where beauty of the wilderness
combines with sophisticated contemporary luxury.

Imagine Anvita Parkside!



ANVITA PARKSIDE

Experience the difference you only get with Parkside

Step into a world of opulence, while still being cocooned in nature. With meticulously designed villaments that reflect your taste, Anvita Parkside ensures maximum privacy, unparalleled luxury, allowing you to immerse yourself in the idyllic surroundings.

What makes Anvita Parkside so unique?

- Eco-friendly community with more than 75% open spaces
- Only 270 unique Villaments spread over 50 acres.
- Every Villament has a 20 Feet Front Yard and Backyard.
- Solar Powered Homes.
- 2.4 acre Resort like Clubhouse with abundant parking.
- Holistic, environmentally self-sustaining and health-centric Community.

75%
OPEN SPACES



ANVITA PARKSIDE

7

UNIQUE FEATURE

**75% Open spaces.
35 Acres out of 50 Acres
is open & landscaped spaces.**



ANVITA PARKSIDE



UNIQUE FEATURE



**Over 3.2 Acres
is reserved for
community farming.**



ANVITA PARKSIDE

3
UNIQUE FEATURE

800 Sq yards
with 20 feet front yard
and 20 feet backyard.



ANVITA PARKSIDE



**Over 200 dedicated
Car Parking spaces
for visitors.**



ANVITA PARKSIDE

5
UNIQUE FEATURE

**Over 75 Amenities,
including all outdoor sports
facilities are provided.**



ANVITA PARKSIDE

6
UNIQUE FEATURE

**A Resort Like Clubhouse
of Over 33,005 Sft.
Spread Over 2.5 Acres.**

With 178 Car Parking Slots
and 148 2 Wheeler Parking Slots



Over **35** Acres

of natural open spaces
offering resort-like **amenities.**



Herb/Medicinal Garden

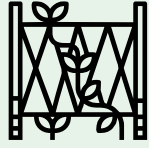

Trellis

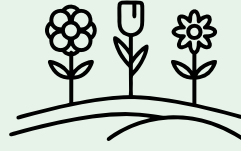

Aroma Garden



Mandala Farming



Fruit Orchard



Rain Garden

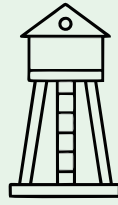

Birds Watch Tower



Temple Complex



Retention Pond

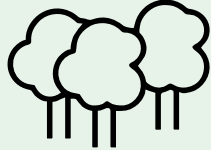

Miyawaki Forest

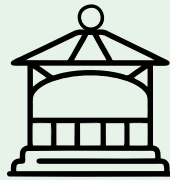

Gazebo

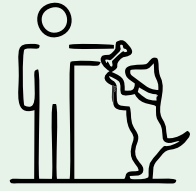

Pet Park



Yoga Decks



Meditation Lawn



Tennis Court

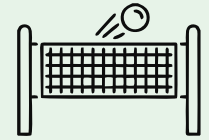

Volleyball Court



Skating Rink /
Skateboard Park



Amphitheatre
with Loft Nets

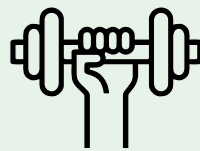

Gym Arena



Half Basketball
Court

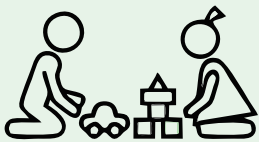

Toddler's Play Area



Adventure Play Area



Cricket
Practice Nets



Sensory Walkway

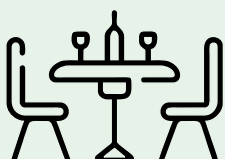

Dine Space



Seating Spaces

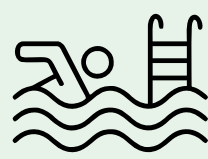

Swimming Pool

MASTER PLAN



- 14- Trim Trail
- 15- Cricket Practice Net
- 16- Gym Arena
- 17- Sports Club
- 18- Pickle Ball
- 19- Tennis Court
- 20- Badminton Court
- 21- Woods With Bird Watching Tower
- 22- Tree Deckundersapota Orchid
- 23- Hammock Under Mango Orchid
- 24- Miyawaki Forest
- 25- Bicycle Stand
- 26- Community Dine
- 27- Sand Volleyball Court
- 28- Multipurpose Court
- 29- Adventure Play Area
- 30- Labyrinth
- 31- Kabbadi Court
- 32- Bicycle Bay &seating Plaza
- 33- Half Basketball Court
- 34- Stepped Well Seating
- 35- Seating Plaza
- 36- Mandala Farming
- 37- Vegetable Beds
- 38- Children Play Area
- 39- Skating Rink
- 40- Senior Seating Plaza
- 41- Multipurpose Lawn
- 42- Utility

LEGEND

- 1- Entrance Arch
- 2- Stepped Plaza
- 3- Temple
- 4- Rain Garden & Solar Gazebo
- 5- Cycle Track
- 6- Mango Orchard
- 7- Human Level Chess
- 8- Kids Pool
- 9- Swimming Pool
- 10- Bio Pool
- 11- Yoga Deck
- 12- Sensory Jogging Track
- 13- Herb Garden

ANVITA PARKSIDE

From a warm welcome to enhanced comfort

Embrace avant-garde architectural elements that leave a lasting impression and feel instant peace the moment you enter the community. Creating a safe and accessible environment, the entrance is an embodiment of elegance, with its sleek lines, natural textures, and carefully curated artwork.



ANVITA PARKSIDE

- Project Area: **50 Acres**
- No. of Units: **270**
- Configuration: **4-BHK Triplex Villas**
with **20** feet front yard & backyard
- Type: **East, West & North** facing
- **75%** Open Spaces
- Resort like **Clubhouse** of over **33,005** Sft.

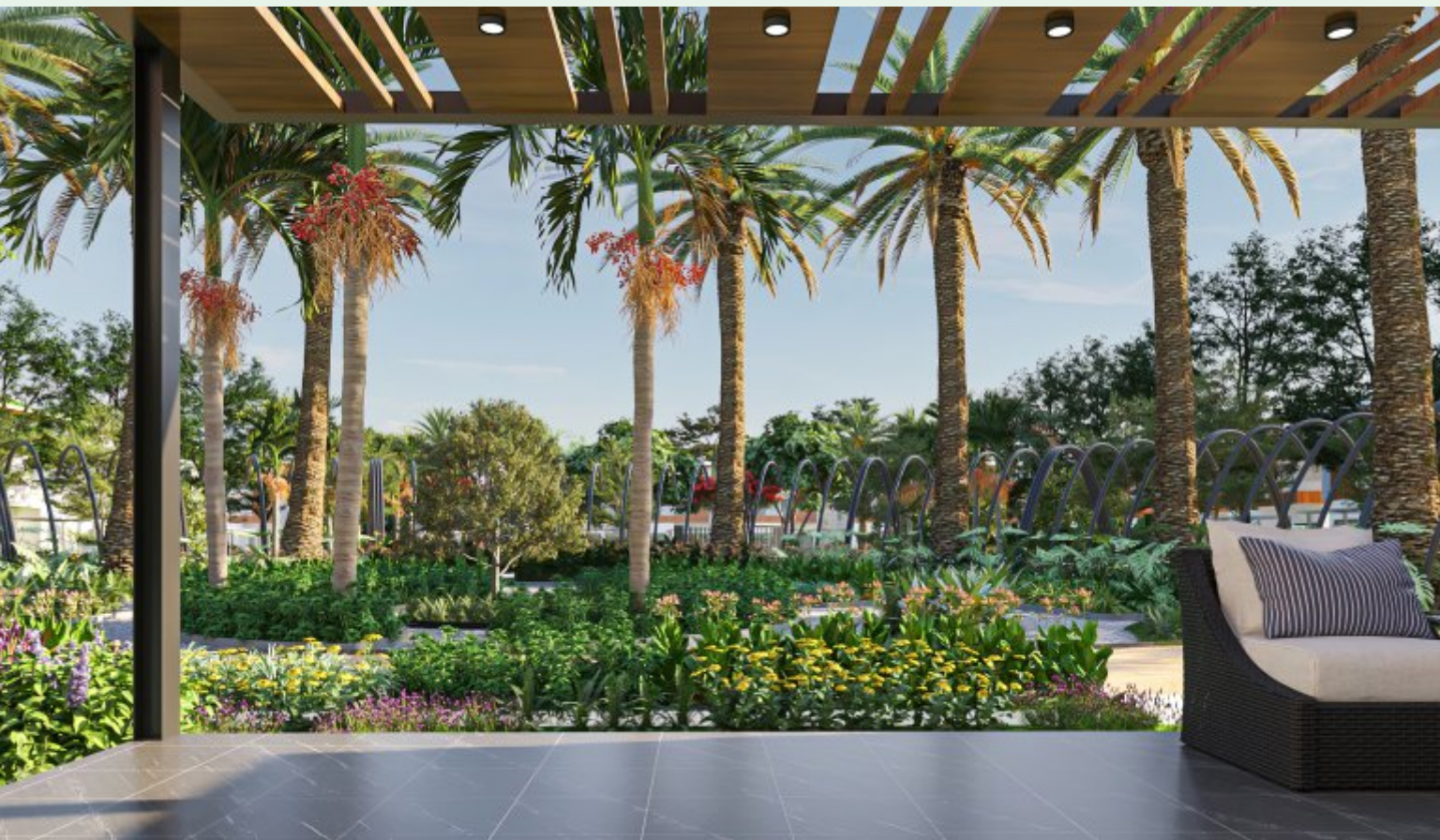



ANVITA PARKSIDE

Find bliss in every corner

Relish life in an eco-neighbourhood and fill every moment of it with peace. An array of lavish features, categorised into 5 zones, as Greenery, Community, Health, Sports and Leisure, give something for everyone in the family.

Whether you want to relax and unwind after a long day in the eternal nature, develop a sense of community, revisit your passion for sports, make way for more celebrations or enjoy a fit and healthy lifestyle at home, you'll be spoilt for choice.



Greenery

- Herb / Medicinal Garden
- Trellis
- Aroma Garden
- Putting Green
- Tree Desk Area
- Mandala Farming
- Fruit Orchard
- Vegetable Beds



Community

- Dine Space
Family Dine / Community Dine
- Seating Spaces
- Temple Complex
- Amphitheatre With Loft Nets
- Gazebo
- Pet Park



Health

- Gym Arena
- Fitness Trail
- Yoga Decks
- Meditation Lawn
- Sensory Walkway
- Pool

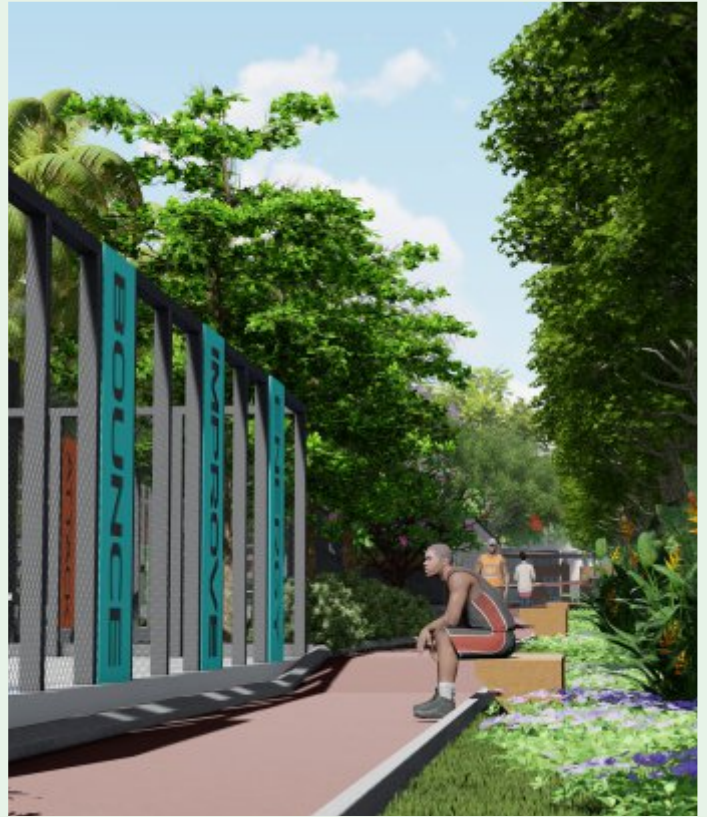

Sports

- Tennis Court
- Volley Ball Court
- Pickle Ball
- Half Basketball Court
- Cricket Practice Nets
- Adventure Play Area
- Skating Rink / Skateboard Park
- Trim Trail
- Toddler's Play Area



Leisure

- Retention Pond
- Miyawaki Forest
- Birds Watch Tower
- Kund / Stepped Well Baoli
- Machan / Labyrinth
- Rain Garden
- Solar Gazebo



North facing Villa



GROUND FLOOR PLAN



FIRST FLOOR PLAN



SECOND FLOOR PLAN



TOTAL BUILT-UP AREA: 4201 SFT.



East facing Villa



GROUND FLOOR PLAN



FIRST FLOOR PLAN



SECOND FLOOR PLAN



TOTAL BUILT-UP AREA: 4188 SFT.

West facing Villa



GROUND FLOOR PLAN



FIRST FLOOR PLAN



SECOND FLOOR PLAN



TOTAL BUILT-UP AREA: 4188 SFT.

From embracing a natural to refined modern lifestyle

Give your urban refined lifestyle a natural touch with our resort like Clubhouse. With life-enhancing amenities and the sights, sounds and smells of nature as your backdrop, the clubhouse lets you refresh your life and also enjoy a plush lifestyle.



Swimming Pool



From getting fit to staying healthy

Embark on a holistic journey towards improved well-being. Whether you are seeking fitness, relaxation, or rejuvenation, Northridge has something to offer for everyone. Every aspect has been meticulously designed to provide a complete wellness experience, from the state-of-the-art pool to the invigorating outdoor fitness areas.



Banquet Hall



From hosting celebrations to making connections

Celebrate special occasions and community events in a lavish setting and make memories amidst nature. The banquet hall, with a cozy and expansive setting, is a destination for every occasion and makes every moment a celebration of indulgence and tranquility.



Restaurant



From savouring healthy bites to refreshing drinks

Refuel and refresh with a snack, beverage or indulge in a delightful feast with your loved ones without leaving your home. The restaurant in the community is a place to stop for a quick cup of coffee or fuel up on the way to work.



Gymnasium



From living a fit to healthy lifestyle

Feel inspired to make a change in your life and set an example for all of those around you. Stay with and live a healthy lifestyle with the state-of-the-art fitness center inside the clubhouse, offering weights, machines, cardio equipment, and stunning resort like atmosphere.

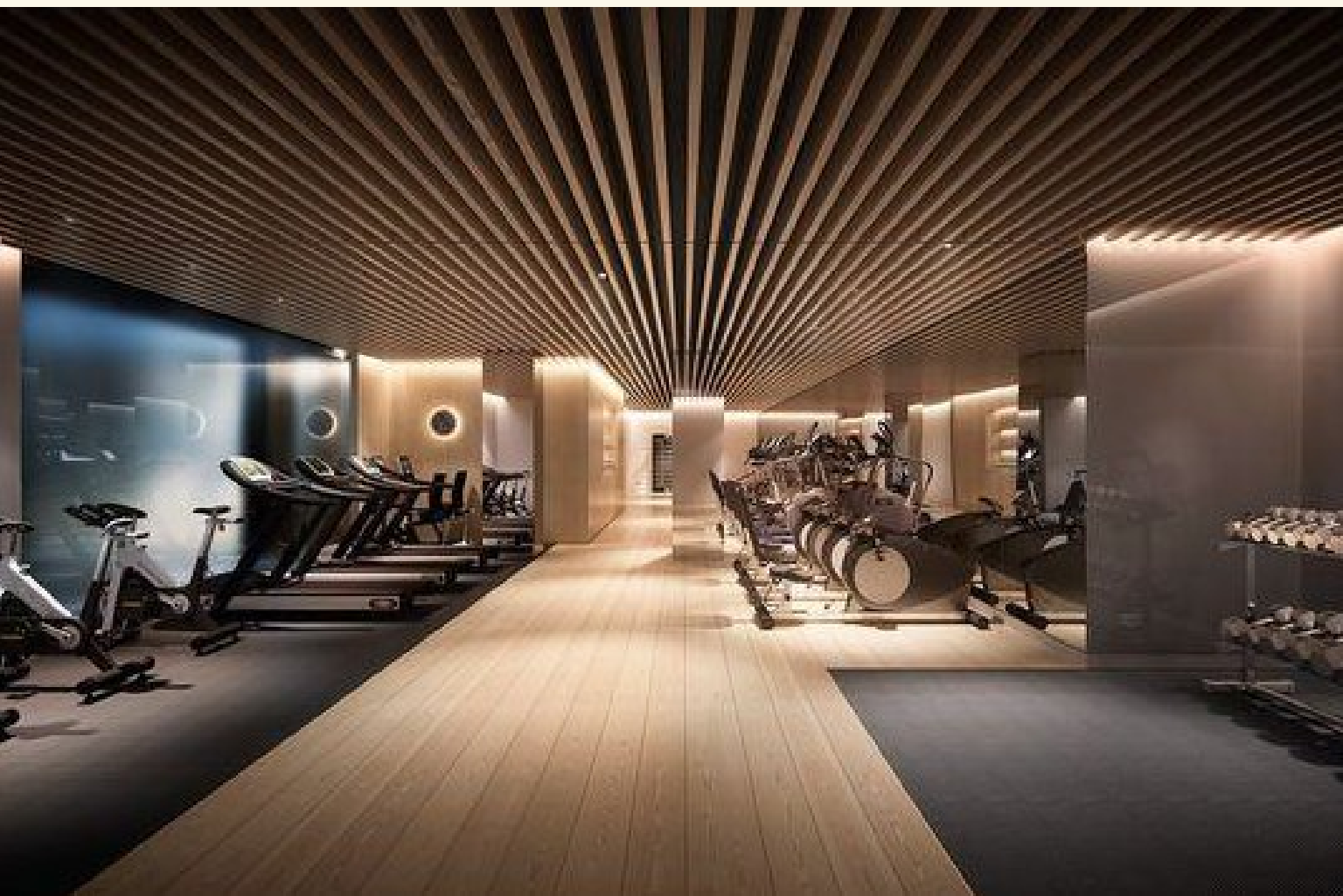



From playing engaging to entertaining games

Fight the boredom of staying inside with fun and entertaining games and activities for kids of all ages. Whether it is a rainy or sunny day that keeps you stuck inside or you are looking for an indoor game for a party, Northridge has all the fun ideas.



Yoga



From stretching to strengthening

Rediscover the purest kind of tranquillity and connection with your inner self at Northridge. The Yoga Lawn creates the right atmosphere that is essential to the journey of attaining equilibrium of the mind, body and soul.



Spa



From relaxing massages to rejuvenating body treatments

Spend the day relaxing in the comfort of your own personal haven. The in-house Spa, with an array of beauty treatments and massages tailored to your needs, will leave you feeling refreshed and renewed everyday.



Consultation Room



From personalized to community healthcare

Enjoy a dedicated space that addresses your healthcare needs whether it is just a normal health check up or emergency service. Improving the health of patients and residents, the clinic with an attached pharmacy store cares for the community, every moment, every day.





From tiny toddlers to playful preschoolers

Create a social setting that can inspire and nurture the growing minds. Catering to the varying needs of working parents, the dedicated creche helps the kids in their physical and mental growth while giving the parents a feeling of comfort.



Community Store



From leisurely shopping to convenience of time

Shop for your daily needs and also save time while doing it. Making groceries and essential supplies needed for your home available, the convenience store brings comfort and connection to the community.



Guest Bedroom



From creating privacy to a homelike feel

Give guests the opportunity to indulge in the best, feel at their best, and relax in style. The guest cottages at Northridge are created with a harmonious blend of comfort and style, with each room exuding a sense of warmth and sophistication.



Location

Medchal - from a lush, green area to a convenient location

Discover the enchanting allure of Ravalkole, located near Medchal, and indulge in the exquisite 'luxury of nature'. Here, you will find a harmonious fusion of pristine natural surroundings and vibrant and thriving neighborhood, all well connected by exceptional infrastructure.



EDUCATION



HOSPITALS



MALLS



RESTAURANTS



OFFICES

Nearby Educational Institutions

Schools

IVY League School

Geetanjali International School

Excellencia Infinitum School

Professional colleges

NALSAR University

Malla Reddy University

Siva Sivani Institute of Management

Location Highlights

- 05 min. drive to Medici Medical College & Hospital
- 05 min. drive to Rajiv Rahadaari Road
- 10 min. drive from ORR Exit No. 6 & 7
- 10 min. drive to Medchal Check-post
- 10 min. drive to Shamirpet Lake
- 10 min. drive to Leonia, Alankrita & Celebrity Resorts
- 10 min. drive to the proposed IT Park at Kandlakoya
- 15 min. drive to Genome Valley



Paradise-Medchal (22 Kmts.) & JBS-Shamirpet (23 Kmts.) are part of Hyderabad Metro Rail Phase-2 expansion plan

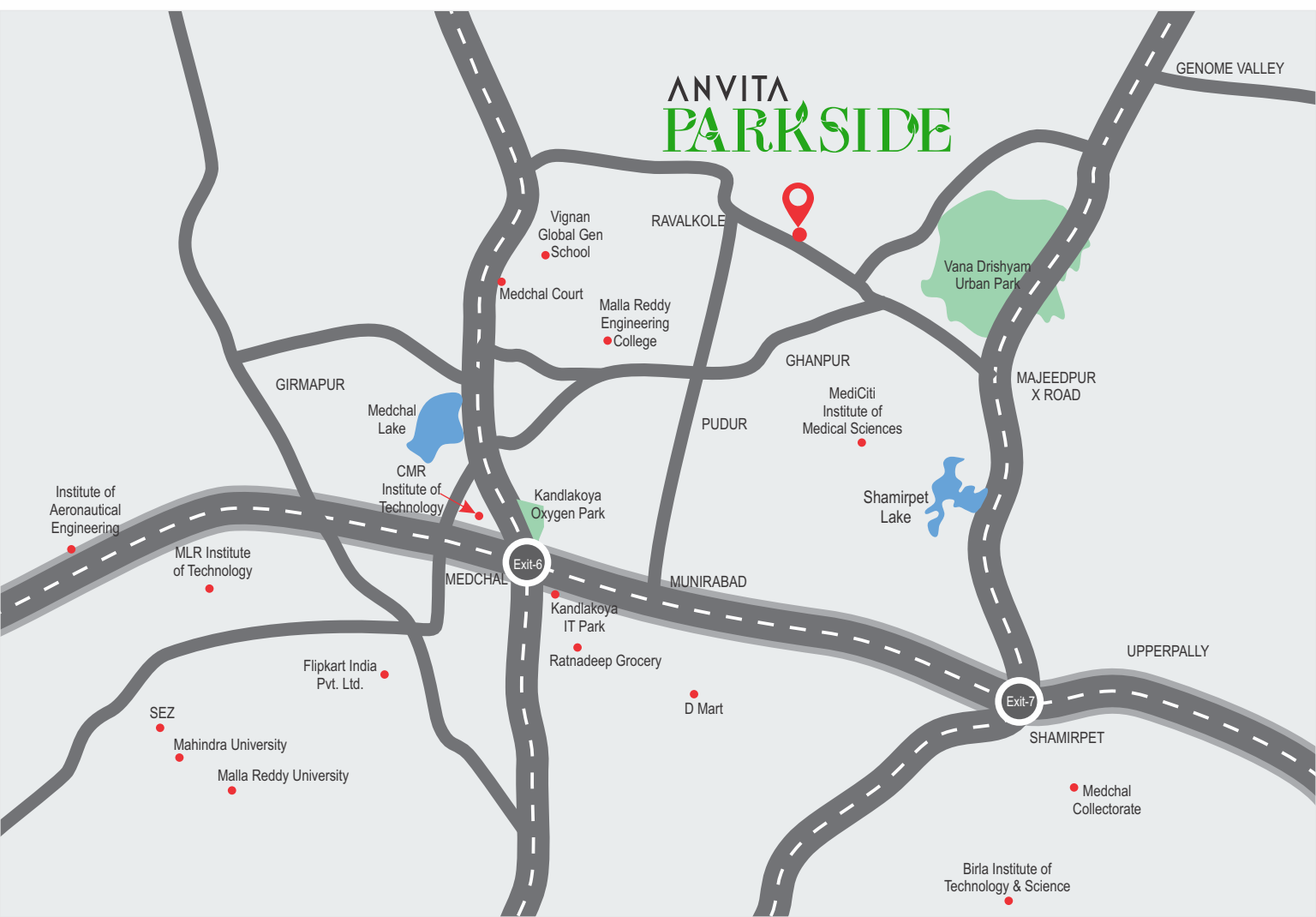

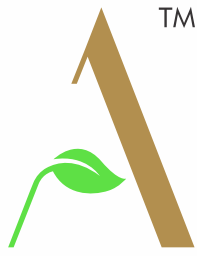

ANVITA

BUILDING HAPPINESS

With the proven track record, we started our journey in 2005. Ever since then, we have grown to become a well-respected and trusted name. We pride ourselves on our commitment to excellence and strive to achieve highest quality on every project.

Our team of dedicated professionals with wealth of experience and knowledge, are trained to pay attention to the smallest details, ensuring that every project we undertake is completed with precision and accuracy.

We use latest technology and best practices to deliver exceptional results that continue to exceed our customer's expectations.

We are Anvita Group!

OUR ONGOING PROJECTS



13 Acres 2, 3 & 4 BHK | 6 Towers | Towers A, B | 15 Floors | 418 Units
4 Towers | Towers C, D, E, F | 36 Floors | 1,392 Units | 40 Cloud Villas
35 & 36 Floors | 2915 to 5070 Sft. | 2 Mega Clubhouses



15 Acres | 2331 Homes | 2 & 3 BHK Lifestyle Apartments
1355 to 2615 Sft. | 4 BHK Cloud Villas | 2700 to 5000 Sft.
2 Amenities Blocks Including a Sports Complex

@ Kolluru, ORR Exit-2



ANVITA GROUP
6th Floor, G Square
Near Wells Fargo
Raidurg, Gachibowli
Hyderabad - 500032
Telangana, India.
Ph: 040 2955 5544
040 2955 4455
E: info@anvitagroup.com
www.anvitagroup.com



LANDSPACE PROJECTS LLP
5th Floor, Gar 71,
Liberty Place,
Bhagath, Phase-2, Uppal,
Hyderabad - 500039
Telangana, India.
Ph: +91 828282 6766
E: info@landscapeprojects.com
www.landscapeprojects.com

ANVITA PARKSIDE

By:

ANVITA & LANDSPACE
DEVELOPERS

Ph: +91 98480 00092 | www.anvitaparkside.com



Scan for location