



ABINANDANA

Sunshine Your Dreams



VRINDA

LUXURY VILLAS

@VELIMALA, HYDERABAD.



VRINDA
LUXURY APARTS





VRINDA
LUXURY VILLAS



V-75

V-76

V-77

PROJECT FEATURES & AMENITIES

1. ULTRA LUXURY GATED COMMUNITY VILLA PROJECT AT VELIMALLA
2. CENTRAL PARK WITH GAMING ZONES AND TRACKS
3. SPACIOUS CLUB HOUSE OF 50000 Sq.ft
4. GRAND ENTRANCE GATE WAY
5. SUPER MARKET
6. JOGGING TRACK
7. INTERNATIONAL STANDARD SKATING RINK
8. OUT DOOR GYM
9. CHILDREN PLAY AREA
10. SENIOR CITIZEN AREA
11. LUXERIOUS BANQUET HALLS
12. GUEST ROOMS
13. DOCTOR CONSULTATION ROOM
14. MEDICAL HALL
15. UNIVERSAL SALOON
16. SPA
17. BOUTIQUE
18. PRIVATE PARTY LAWN ON TERRACE
19. CENTRAL OVER HEAD TANK
20. 24*7 AMBULANCE SERVICE
21. LIVE KITCHEN
22. FULLY EQUIPED GYM
23. CENTRAL COURTYARD
24. OPEN AIR THEATER (O.A.T.)
25. MINI THEATER
26. SQUASH COURT
27. TENNIS COURT
28. BADMINTON COURTS
29. CRICKET NET PRACTICE
30. BASKET BALL COURT
31. INDOOR GAMES LIKE CHESS, CARROMS, TABLE TENNIS, SNOOKERS OR BILLIARDS TABLE ETC....
32. CHILDRES GAMING ZONE
33. CRECHE
34. YOGA MEDITATION ROOM
35. MINI CONFERENCE ROOM
36. COMMUNITY DISCUSSION HALL
37. PET PLAY AREA

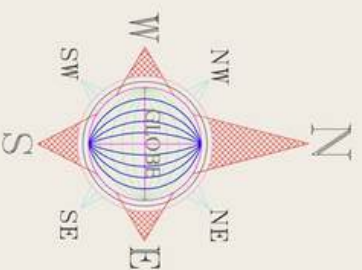

- EF 1: 36'-0" x 55'-0" 3040 Sft
- WF 1: 36'-0" x 55'-0" 3040 Sft
- NF 1: 37'-9" x 56'-6" 4085 Sft
- EF 2: 36'-6" x 56'-6" 3885 Sft
- WF 2: 36'-6" x 56'-6" 3885 Sft
- NF 3: 56'-6" x 55'-6" 5200 Sft
- EF 3: 30'-5" x 56'-6" 3200 Sft
- WF 3: 30'-5" x 56'-6" 3200 Sft
- NF 2: 28'-3" x 60'-0" 3200 Sft





PLOT AREA = 28'-3" X 60'-0" = 188.0 Yds

**GROUND FLOOR = 1190.0 Sft.
FIRST FLOOR = 1190.0 Sft.
SECOND FLOOR = 820.0 Sft.
TOTAL = 3200.0 Sft.**





PLOT AREA = 30'-5" X 56'-6" = 191.0 Yds

**GROUND FLOOR = 1190.0 Sft.
 FIRST FLOOR = 1190.0 Sft.
 SECOND FLOOR = 820.0 Sft.
 TOTAL = 3200.0 Sft.**

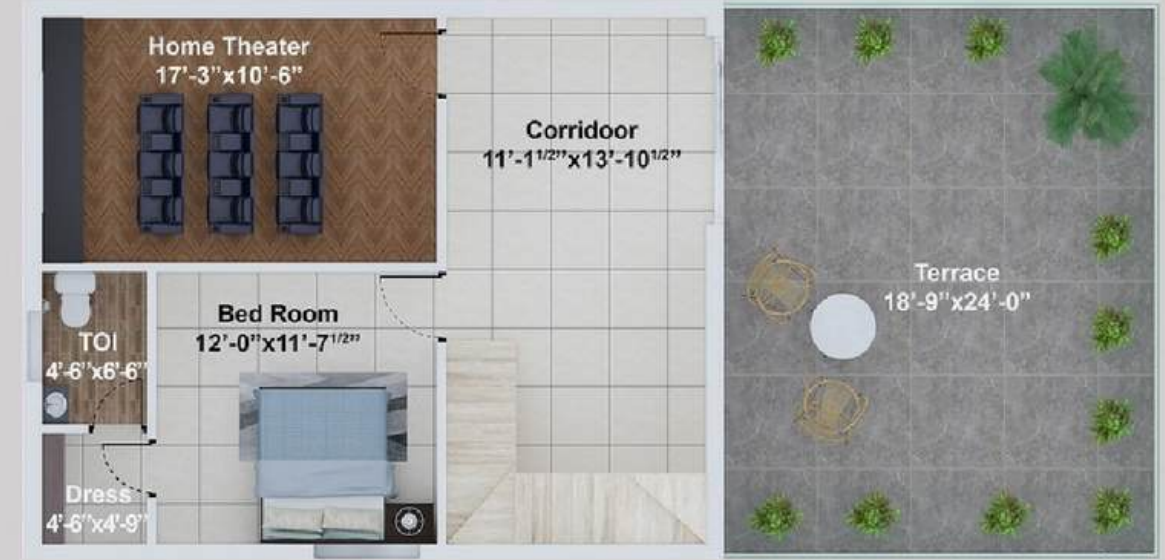

EAST FACING ELEVATION & FLOOR PLANS



PLOT AREA = 30'-5" X 56'-6" = 191.0 Yds

**GROUND FLOOR = 1190.0 Sft.
 FIRST FLOOR = 1190.0 Sft.
 SECOND FLOOR = 820.0 Sft.
 TOTAL = 3200.0 Sft.**



WEST FACING ELEVATION & FLOOR PLANS



PLOT AREA=36'-0"X55'-0" = 220 Yds.

GROUND FLOOR=1380.0 Sft.
 FIRST FLOOR=1380.0 Sft.
 SECOND FLOOR= 280.0 Sft.
 TOTAL = 3040.0 Sft.



EAST FACING ELEVATION & FLOOR PLANS



PLOT AREA=36'-0"X55'-0" = 220 Yds.

GROUND FLOOR=1380.0 Sft.
 FIRST FLOOR=1380.0 Sft.
 SECOND FLOOR= 280.0 Sft.
 TOTAL = 3040.0 Sft.



WEST ROAD

WEST FACING ELEVATION & FLOOR PLANS



PLOT AREA=36'-6"X56'-9" = 230 Yds.

GROUND FLOOR=1455.0 Sft.
 FIRST FLOOR=1455.0 Sft.
 SECOND FLOOR= 975.0 Sft.
 TOTAL = 3885.0 Sft.



SECOND FLOOR



FIRST FLOOR



GROUND FLOOR

EAST FACING ELEVATION & FLOOR PLANS



PLOT AREA=36'-6"X56'-9" = 230 Yds.

GROUND FLOOR=1455.0 Sft.
 FIRST FLOOR=1455.0 Sft.
 SECOND FLOOR= 975.0 Sft.
 TOTAL = 3885.0 Sft.



SECOND FLOOR



FIRST FLOOR



GROUND FLOOR

WEST ROAD

WEST FACING ELEVATION & FLOOR PLANS



PLOT AREA = 37'-9"X56'-6"
= 238.00 Yds.

GROUND FLOOR = 1510.0 Sft.
FIRST FLOOR = 1510.0 Sft.
SECOND FLOOR = 1060.0 Sft.
TOTAL = 4085



NORTH FACING ELEVATION & FLOOR PLANS



PLOT AREA	=56'-6" X 56'-9"
	=356 Yds.
GROUND FLOOR	=1950.0 Sft.
FIRST FLOOR	=1950.0 Sft.
SECOND FLOOR	=1250.0 Sft.
TOTAL	= 5200 Sft.

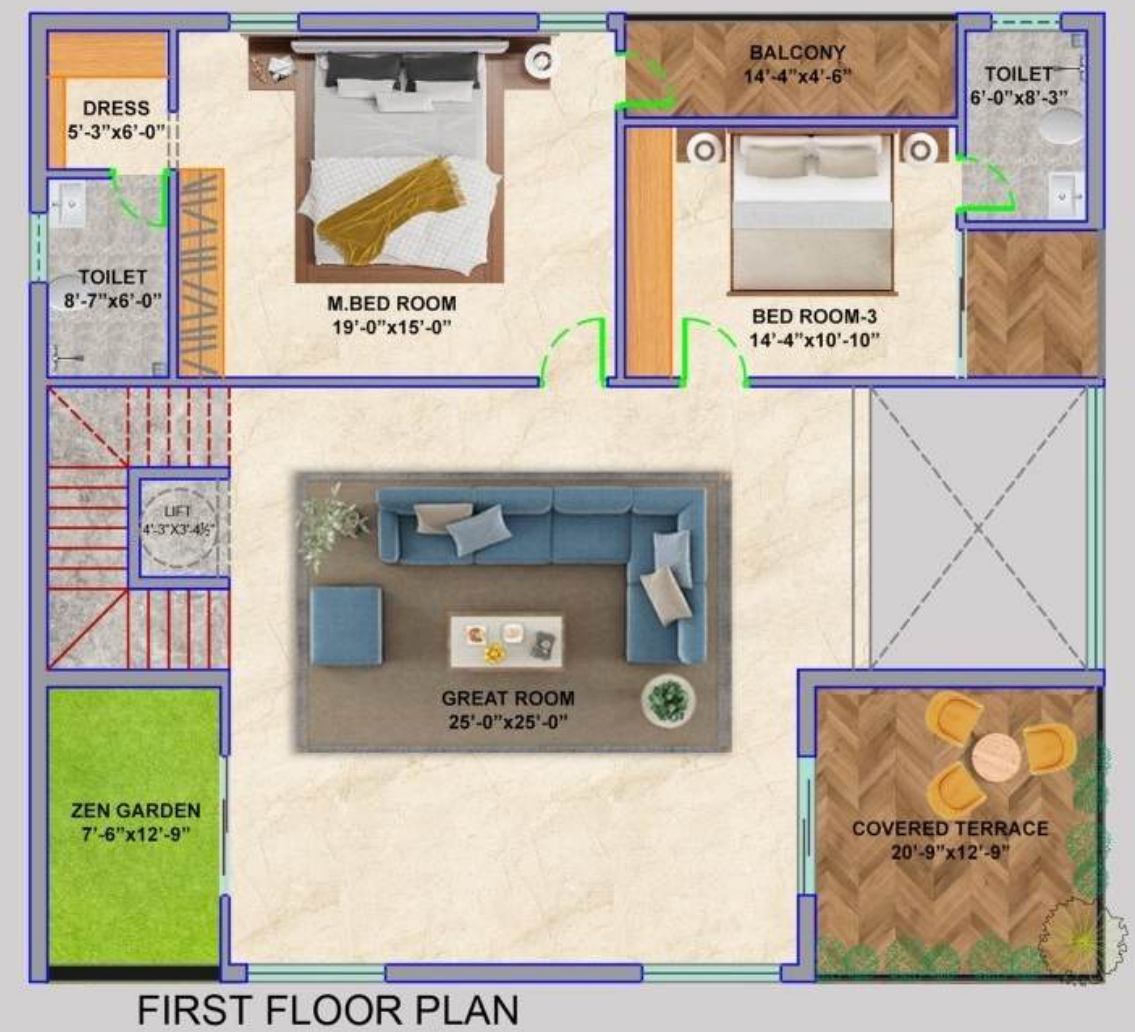



GROUND FLOOR PLAN

PLOT AREA = 56'-6" x 56'-9"
= 356 Yds.

GROUND FLOOR = 1950.0 Sft.
FIRST FLOOR = 1950.0 Sft.
SECOND FLOOR = 1250.0 Sft.
TOTAL = **5200 Sft.**

EAST FACING

-----EAST ROAD-----



FIRST FLOOR PLAN



SECOND FLOOR PLAN

Club House
Ground Floor Plan



Club House
First Floor Plan



Club House
Second Floor Plan





IN DOOR GAMES

IN DOOR GAMES



OUT DOOR GAMES

OUT DOOR GAMES



CLUB HOUSE

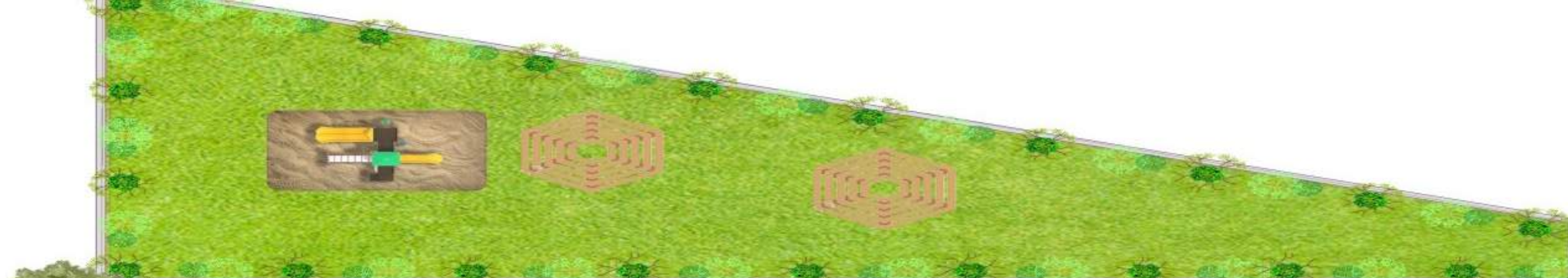

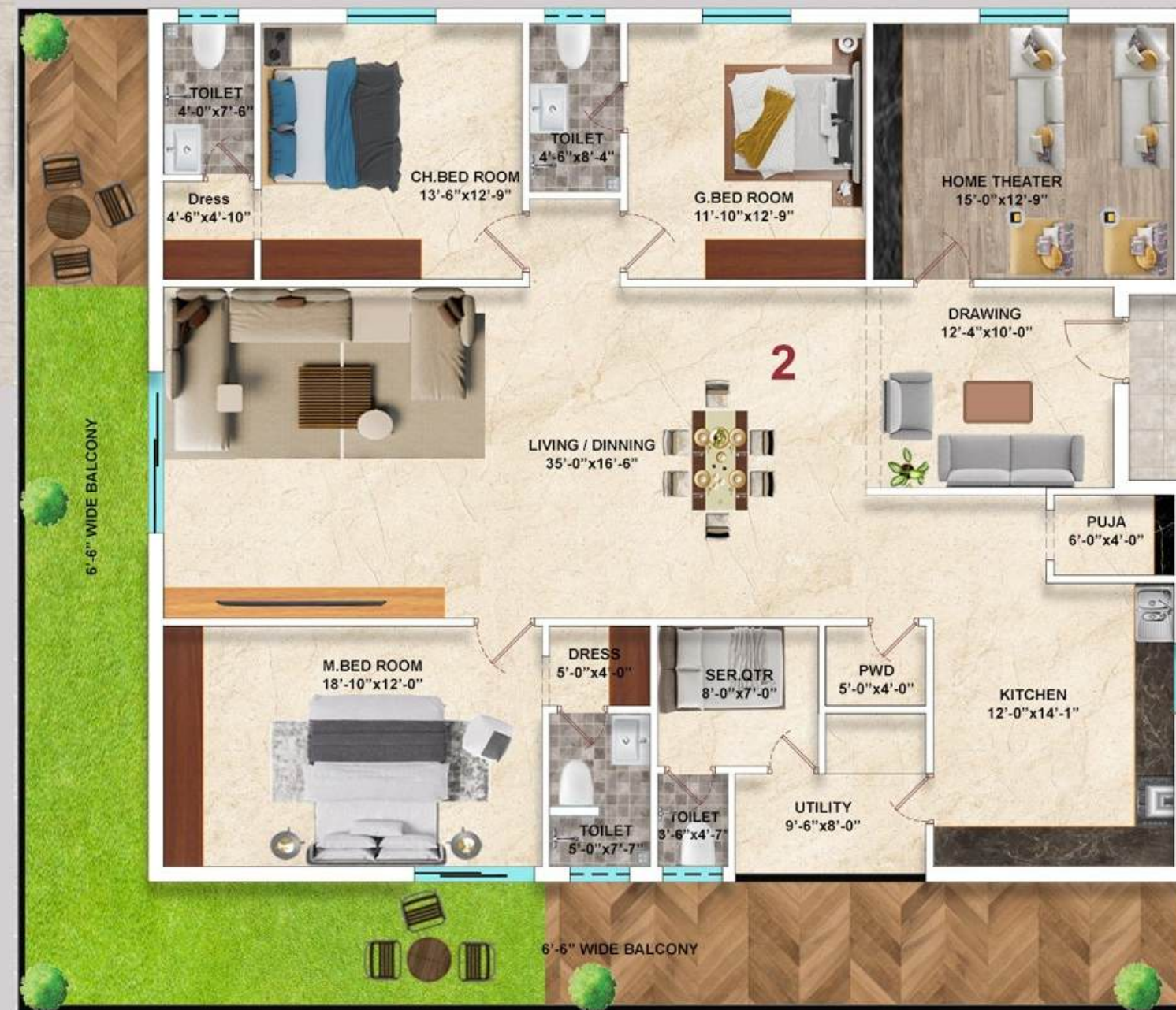

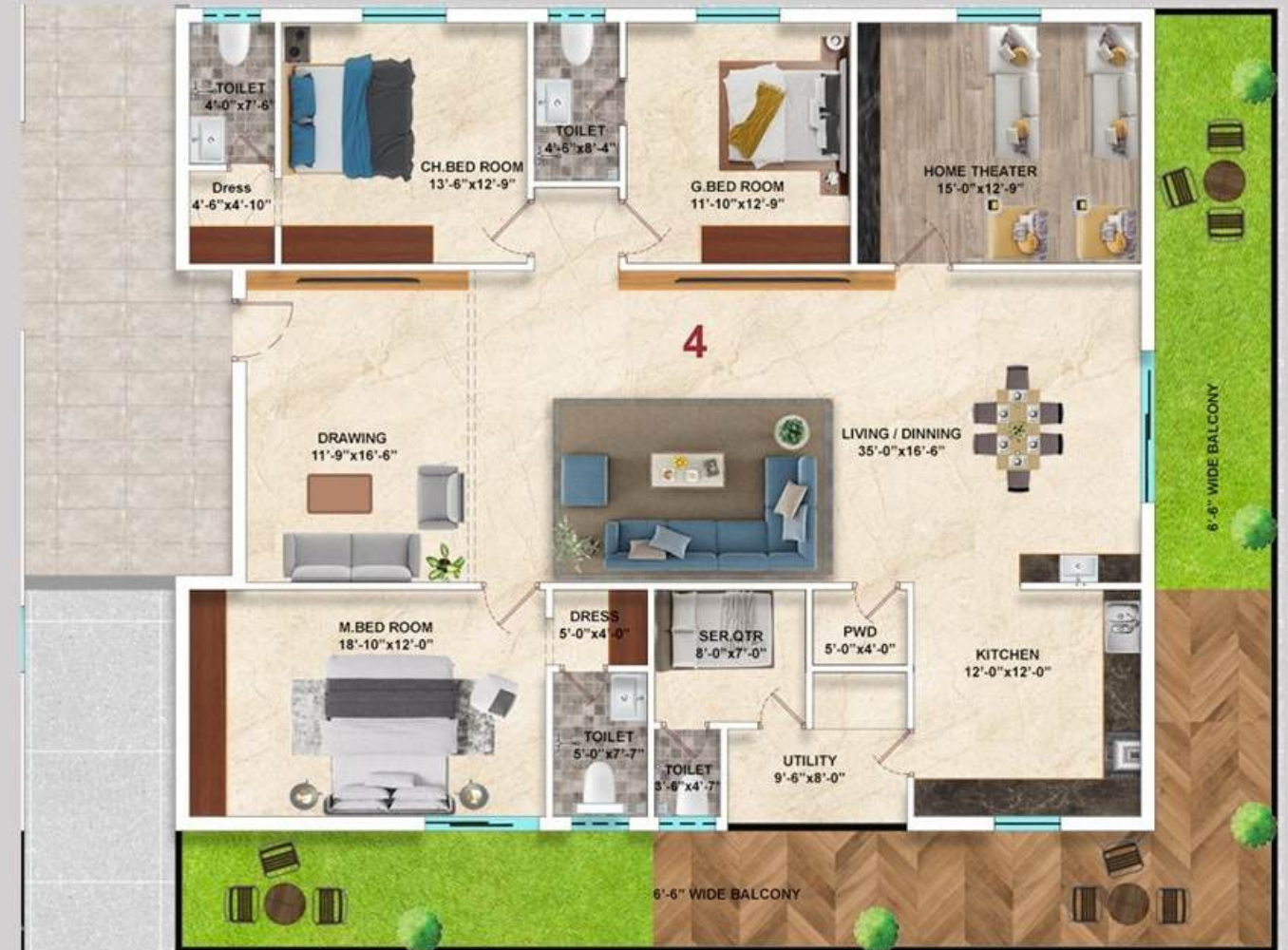



PROJECT SPECIFICATIONS



STRUCTURE:

Framed Structure: R.C.C Framed Structure
Super Structure: Red Bricks For External And Internal Walls.



PLASTERING:

External: Double Coat Plaster For R.C.C And Masonry Surfaces.
Internal: Cements And Plaster For Walls And Ceiling.



DOORS & WINDOWS:

Main Door Frame: Teak Wood.
Internal Door Frames: Granite Frame.
All Doors- Veneered Finished Flush Shutter Without Tower Bolt.
Bathrooms/Utility Door Frames: Granite Frame.
Bathrooms/Utility Doors: Both Sides Laminated Flush Shutter Without Tower Bolt.
Balconies: UPVC Glazed French Sliding Doors With Mosquito Mesh Provision.



FLOORING:

Drawing, Living/Dining & Family Lounge 2'x4' Vitrified Tiles Of Reputed Make
All Bedrooms, Kitchen & Multi-Purpose Hall: 2'x4' Vitrified Tiles Of Reputed Make
Bathrooms: For Walls 1'x2' Tiles Up To Door Height
vAnd For Floors Anti-Skid Tiles Of Reputed Make
Terrace: Anti-Skid Tiles Of Reputed Make
Parking Area: Vitrified Tiles Of Reputed Make
Balcony/Bathroom/Utility: Anti-Skid Vitrified/Ceramic Tiles Of Reputed Make
Corridors: Vitrified Tiles With Spacer Joints
Staircase: Granite



KITCHEN:

Provision For Water Purifier Point In Kitchen.
Provision For Washing Machine At Utility Area.
Provision For Dish Washer At Kitchen.



PAINTING:

External: Smooth / Texture (As Per Design)
Paint With Two Coats Of Acrylic Exterior Emulsion.
Internal: Two Coats Of Emulsion Paint Over Smooth Putty Finish.



PLUMBING AND SANITARY:

Chrome Polished (Cp) And Sanitary Ware Fixtures Of Jaguar Make.
Vanity Type Washbasin.
European Water Closet In All Toilets.
Shower- Single Lever Diverter With Spout & Overhead Shower
Tub Provision For 2 Bedrooms.
Carwash Tap Provision In Parking.



WATERPROOFING:

For All Toilets And Wash Area Sand Terrace

ELECTRICAL:

Concealed Copper Wiring Of Reputed Make
Power Socket For Split Ac Provision For Villa Where Ever Is Required.
Power Socket For Geyser In All Bathrooms.
Power Socket For Cooking Range, Chimney, Refrigerator, Microwave Oven, Mixer/Grinder, Dish Washer & Water Purifier In Kitchen
Power Socket For Washing Machine In Utility Area.
Three-Phase Supply For Each Unit With Individual Dual Source Energy Meter WITH PREPAID SYSTEM.
Miniature Circuit Breakers (MCB) For Each Distribution Board Of Reputed Make
Modular Switch Boards Of Reputed Make
Provision For Car Charging Point In Car Parking Area
Provision For Video Door Phone For All Villas
EG/DG Power Display Metering.



T.V / TELEPHONE:

Provision For Fiber-To-The-Home For Internet, Telephone & Intercom
Provision For DTH & TV Services In All Bedrooms, Living Room, Family Lounge, & Multi-Purpose Hall.



LIFT:

Hydraulic Lift Provision For All Villas



SECURITY SYSTEM:

Comprehensive Security System With Cameras In Appropriate Locations
Solar Fencing Through Community Boundary Only
Intercom Security System



WATER SUPPLY:

24 Hours Uninterrupted Water Supply With Sufficient Source Of Bore Well And Corporation (On Availability) Water Supply System.
Synchronized With Standard Automatic Pneumatic System.



WTP&STP:

Water Treatment Plant For Bore-Well Water And Water Meter For Each Unit.
A Sewage Treatment Plant Of Adequate Capacity,
As Per Norms Will Be Provided Inside The Project.
Treated Sewage Water Will Be Used For The Landscaping.
Rain Water Harvesting Pits In Common Areas



BACK-UP POWER:

Dg Power Back-Up For Project Common Areas & 1 Kw For Each Villas



LANDSCAPING:

Well Designed Landscaping Inside The Community.

EXTERNAL LIGHTING:

Light Posts With Lamp Fittings In All Streets.



COMPOUND WALL:

Compound Walls Will Be Constructed All Three Side Of The Villa.
Lorem Ipsum

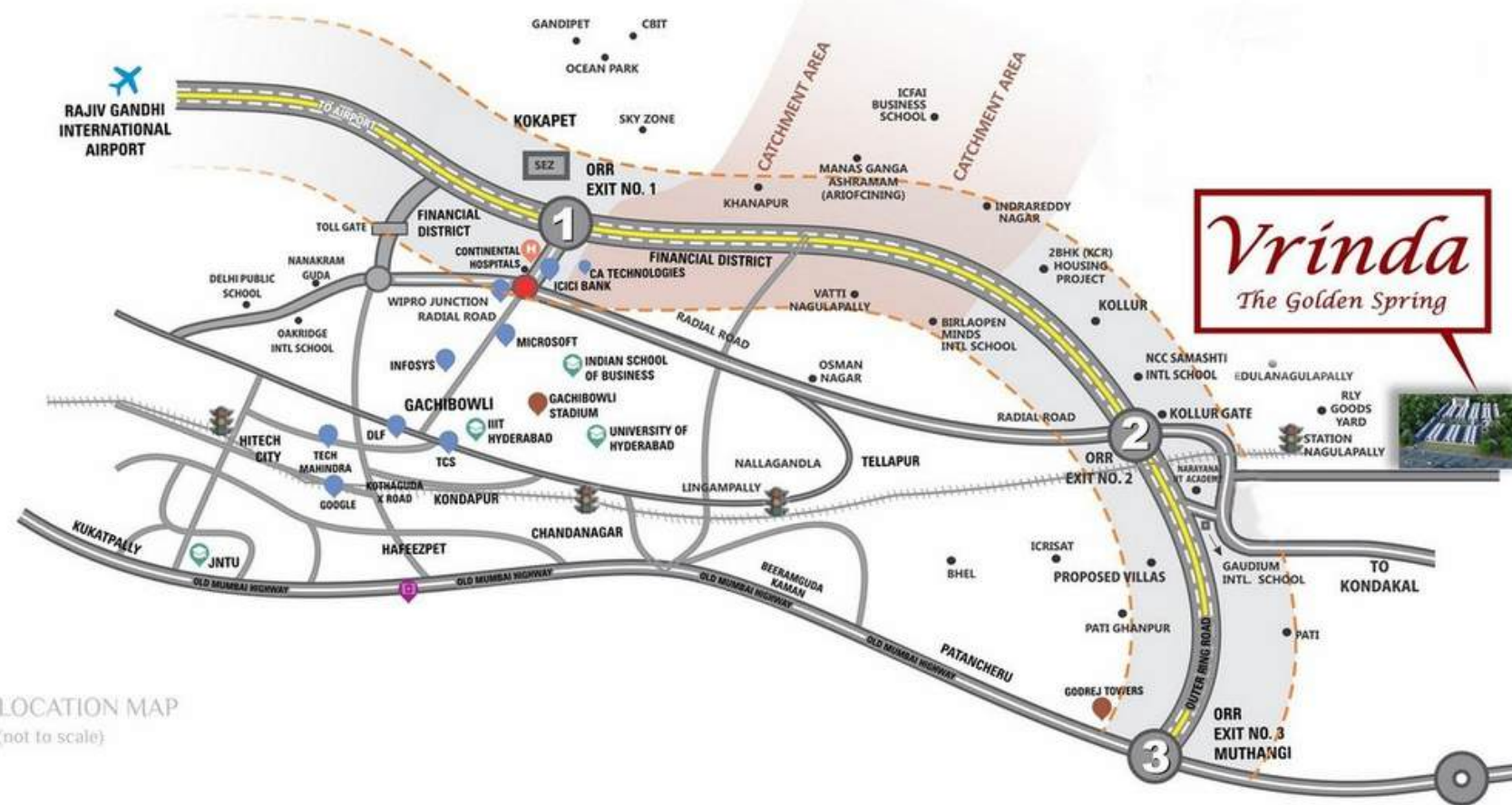

LOCATION MAP
(not to scale)

RESIDENTIAL SPACE ZONE-1

- + Growth Corridor
- + Radial Road From Wipro
- + ORR Access
- + IT-Financial District
- + Corporate Industries
- + International Schools
- + Sez's

CONNECTIVITY

- + Airport Via ORR in 30 Minutes
- + Lingampalli Mmts Railway Station in 15 Minutes
- + Gachibowli Junction in 15 Minutes
- + Wipro Junction In 10 Minutes via Radial Road
- + Nagulapalli Mmts Station in 5 Minutes

IT PROXIMITY:

- + Wipro Campus
- + Microsoft Campus
- + Infosys Campus Capgemini
- + TCS, Wave Rock
- + CA Technologies
- + Amazon
- + Franklin Templeton
- + Honeywell
- + Several Others
- + ICICI Bank Towers
- + Wells Fargo

EDUCATIONAL INSTITUTIONS:

- + Delhi Public School
- + Oakridge School
- + Open Minds - A Birla School
- + Manthan International School
- + Sancta Maria International School
- + NCC-Samashti International School
- + The Gaudium School
- + ISB Campus
- + Institute Of Life Sciences
- + Indus International School
- + Global Indian International School
- + ICFAI Business School
- + CBIT
- + MGIT
- + Telangana Model School

HEALTH AND HOSPITALITY:

- + Citizens Multispecialty Hospital
- + Continental Multispecialty Hospitals
- + Sheraton Hyderabad Hotel
- + Holiday Inn Express & Suites Care, Apollo, KIMS

DEVELOPING FAST IN CLOSE PROXIMITY:

- + American Consulate 11 Acres Campus
- + 100 Acres Wipro
- + Tata Institute Of Fundamental Research (TIFR) 209 Acres
- + Data Recovery Site For BSE
- + Google Campus In Kokapet
- + Tellapur Techno City 100 Acres
- + ITIR Area -Tellapur-Financial District Area
- + Hyudai Mobis Campus

ENTERTAINMENT PROXIMITY:

- + Songs of Earth
- + Lahari Resorts
- + Treasure Island & Golkonda Resort & Spa
- + Ocean Park
- + Wonderla
- + Sky Zone ORO Sports Village