

Project By















GOTHIC
THE SYMBOL OF EXPERIENCE





Gothic's stellar journey to becoming a successful real estate company began in 1996, way before the brand was officially brought to life in 2010. The proprietors forayed into the construction industry on the back of government construction contracts that helped them enhance their technical expertise and understanding. Their successful endeavours gave them the confidence to branch out into building residential spaces and in 2004, they constructed their first apartment in Madhapur followed by the layout development of over 60 acres in Gagillapur in 2006-07.

	<p>Growth Through Experience We have built this company from the ground up on the strong foundation of our experiences in the real estate industry and continue to do so even today.</p>	
<p>Outstanding Service The customer takes center stage in every endeavour we undertake. Our homes are thoughtfully crafted to serve our customers for life.</p>	 	
	<p>Thoughtful Designs We take inspiration from the magnificent structures of the past that have stood the test of time and try to replicate that longevity in every project.</p>	
<p>High-End Conveniences Our focus on ease of living is what has consistently won us the faith of our customers. From simple pleasures to luxurious amenities we deliver it all.</p>	 	
	<p>Integrated Living We don't just build homes for you to live in. We craft communities that help you prosper. Our projects consistently ensure that the human element is never lost.</p>	
<p>Comfort & Luxury Finally, we deliver homes that are worth living a comfortable and luxurious life in. Only the best construction materials and processes go into the making of your dream home.</p>	 	



WHERE
LUXURY
RESIDES

ENTER A
NEW WORLD
OF LUXURY

A home is a space where the comfort
of your loved ones always takes first
priority and at Pentagon Clouds, we
deliver that comfort in every way



RISE TO A
NEW LEVEL
OF QUALITY
LIVING

Pentagon Clouds offers its residents the next level of gated community living. The project gives your lifestyle the quality and luxury it deserves.

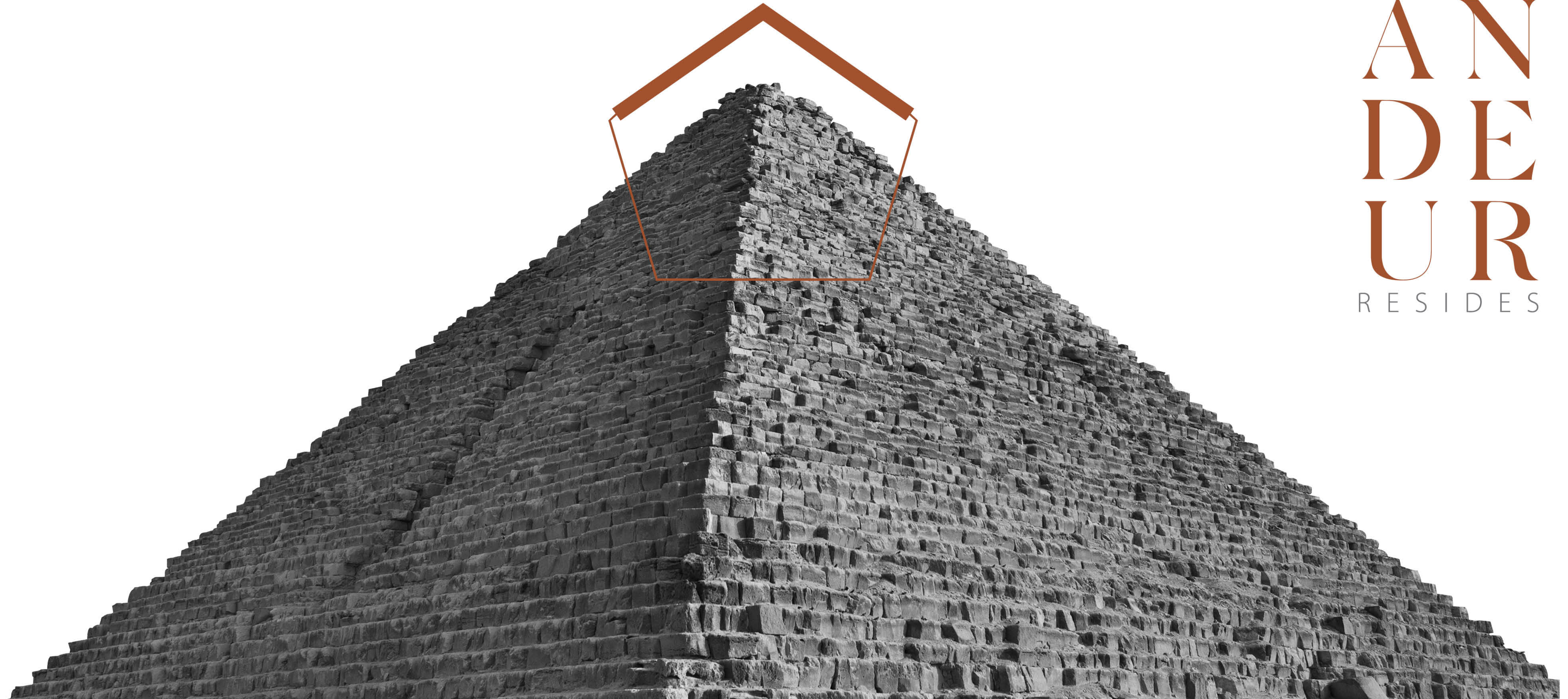

WHERE
GR
AN
DE
UR
RESIDES

LIVE JUST A STEP
AWAY FROM
EVERYTHING



AERIAL VIEW



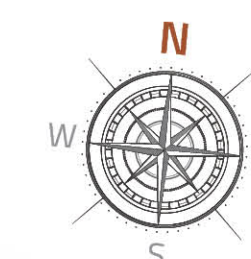

LEGEND

- 1 Entry/ Exit - With Security Cabin 2 Arrival Plaza 3 Entry Water Feature 4 Basket Ball Hoop
5 Drop-off Area; Typ. 6 Informal Seating Plaza 7 Outdoor Gym 8 Skating Rink 9 Cricket Practice Net
10 Amphitheatre @ Clubhouse 11 Club House Entry Plaza 12 Multi Purpose Lawn
13 Yoga/ Meditation Lawn 14 Semi Covered Structure 15 Play Lawn 16 Toddler's Play Area
17 Children's Play Area 18 Central Courtyard 19 Transformer Yard 20 Sculpture Court

MASTER PLAN

PROJECT OVERVIEW

Extent	4.175 acres
Blocks	5 Blocks + 1 Club House
No. of Floors	2 Basements + 1 Stilt + 12 Floors
No. of Units	444
Type of Flats	2,3 & 3.5 BHK
2 BHK	1305 Sft.
3 BHK	1625 – 2060 Sft.
3.5 BHK	2250 – 2320 Sft.



BLOCK - A (Typical Area Statement)

Unit No	Type Of Flat	Facing	Plinth Area	Carpet Area	Balcony Area	Utility Area	Saleable Area	UDS of Land (Sqy.)
1	3 BHK	West	1551	1214	187	60	1970	50.8
2	2 BHK	West	1029	846	61	46	1305	33.6
3	2 BHK	West	1029	846	61	46	1305	33.6
4	3.5 BHK	West	1826	1473	197	54	2320	59.8
5	3.5 BHK	East	1808	1473	167	65	2295	59.2
6	3BHK	East	1280	1087	58	50	1625	41.9
7	3BHK	East	1280	1087	58	50	1625	41.9
8	3BHK	East	1606	1263	197	55	2040	52.6

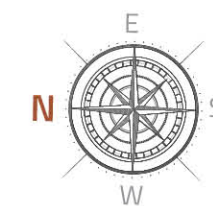
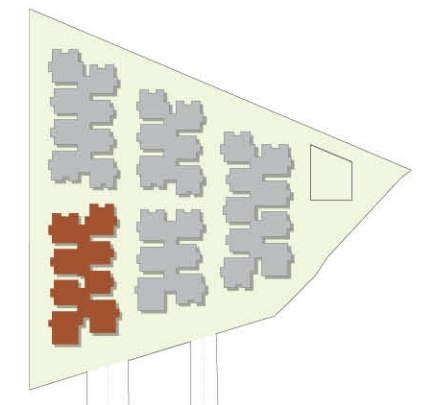



BLOCK - B (Typical Area Statement)

Unit No	Type Of Flat	Facing	Plinth Area	Carpet Area	Balcony Area	Utility Area	Saleable Area	UDS of Land (Sqy.)
1	3BHK	West	1425	1108	180	51	1810	46.67
2	2BHK	West	1029	846	61	46	1305	33.65
3	2BHK	West	1029	846	61	46	1305	33.65
4	3BHK	West	1453	1155	142	65	1845	47.57
5	3BHK	East	1619	1312	145	66	2055	52.99
6	3BHK	East	1280	1087	58	50	1625	41.90
7	3BHK	East	1280	1087	58	50	1625	41.90
8	3.5 BHK	East	1773	1423	197	54	2250	58.01

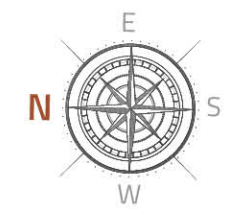
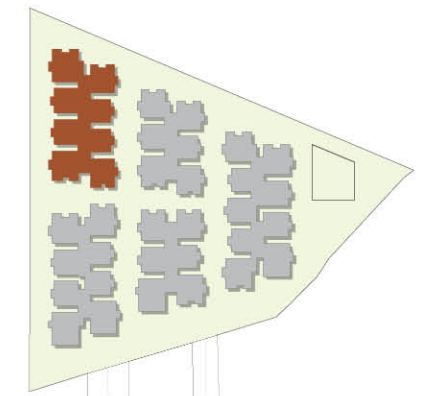



WHERE FAMILY AND COMFORT ARE SYNONYMOUS

Every aspect of Pentagon Clouds has been carefully planned and crafted to provide the utmost comfort for family members of all ages. Experience the luxurious living spaces and unmatched range of amenities and decide for yourself!



BLOCK - C (Typical Area Statement)

Unit No	Type Of Flat	Facing	Plinth Area	Carpet Area	Balcony Area	Utility Area	Saleable Area	UDS of Land (Sq.)
1	3BHK	West	1428	1108	182	51	1815	46.80
2	2BHK	West	1029	846	61	46	1305	33.65
3	3BHK	West	1451	1155	140	65	1845	47.57
4	3BHK	East	1569	1269	145	60	1990	51.31
5	3BHK	East	1280	1087	58	50	1625	41.90
6	3BHK	East	1428	1110	182	49	1815	46.80

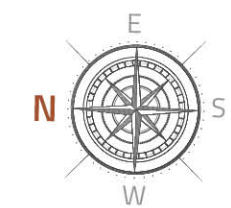
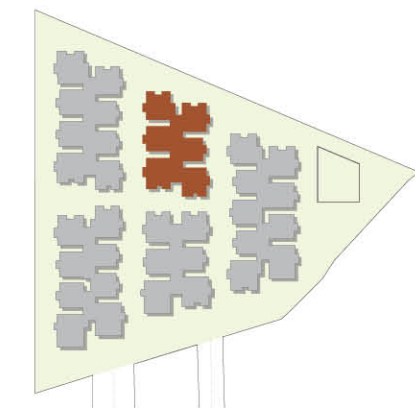



EMBRACE A LIFE
THAT REFLECTS
PROSPERITY

Come home to a space that
lets you focus on your success
story. It's a place where dreams
really come true!



BLOCK - D (Typical Area Statement)

Unit No	Type Of Flat	Facing	Plinth Area	Carpet Area	Balcony Area	Utility Area	Saleable Area	UDS of Land (Sqy.)
1	3BHK	West	1606	1267	197	50	2040	52.60
2	3BHK	West	1329	1127	58	55	1690	43.58
3	3BHK	West	1329	1127	58	55	1690	43.58
4	3.5 BHK	West	1827	1473	198	54	2320	59.82
5	3BHK	East	1621	1312	151	62	2060	53.12
6	2BHK	East	1029	842	61	49	1305	33.65
7	3BHK	East	1280	1087	58	50	1625	41.90
8	3BHK	East	1029	842	61	49	1305	33.65
9	3BHK	East	1606	1262	197	53	2040	52.60

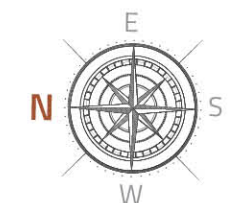
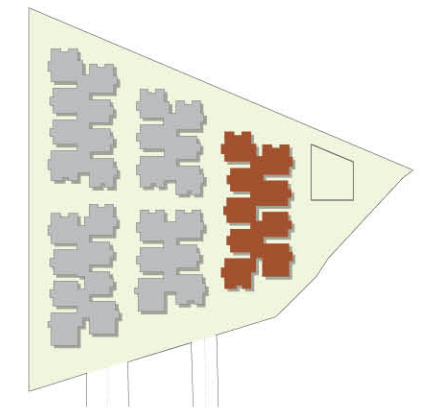



WHERE
FUN IS AN
EVERYDAY
OCCURRENCE



No need to go out to
enjoy special occasions
with friends and family.



BLOCK - E (Typical Area Statement)

Unit No	Type Of Flat	Facing	Plinth Area	Carpet Area	Balcony Area	Utility Area	Saleable Area	UDS of Land (Sq.)
1	3BHK	West	1428	1108	182	51	1815	46.80
2	2BHK	West	1029	846	61	46	1305	33.65
3	3BHK	West	1619	1312	151	60	2055	52.99
4	3.5 BHK	East	1810	1473	169	65	2300	59.30
5	3BHK	East	1280	1087	58	50	1625	41.90
6	3BHK	East	1551	1219	187	55	1970	50.79

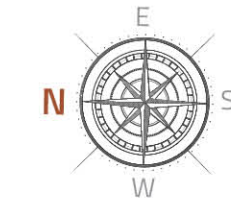
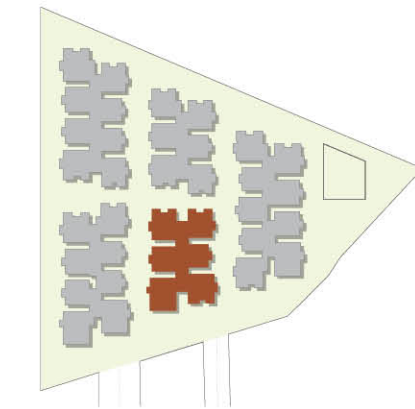

HOMES
THAT
EXTEND
BEYOND
WALLS



With over 67% open spaces, the 4.175-acre project lets you open up and enjoy life within the safety and security of the gated community.



ENGAGE LIFE AT THE CLUBHOUSE



The 30,000 sft clubhouse is a center where you can enhance your life as you wish to. Engage in a plethora of entertaining, relaxing, and exciting activities at the 5-story clubhouse and add a new dimension to your life right here in Pentagon Clouds.



Air Conditioned Clubhouse



Library



Entrance Lounge



Basketball Hoop

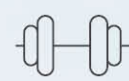

Ac GYM



Aerobics



Business Center



Children's Play Area



Multipurpose Hall



Supermarket



Badminton & Squash Courts



Rooftop Swimming Pool & Shallow Pool With Deck



Jogging Track / Walk Way



Indoor Games (Board Games, Billiards & Tt)



Creche



Clinic & Pharmacy



Ampi Theatre



Ac Guest Rooms



Home Theatre













ATM & Security Kiosk

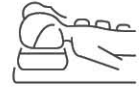

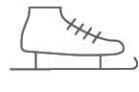
A M E N I T I E S S P E C T A C U L A R

EXPERIENCE
THE



- | | | |
|--|---|---|
| 
Open Air Gym | 
Lawns | 
Yoga |
| 
Spa | 
Open Party Area | 
Cricket Practice Net |
| 
Skating Rink | 
Elder Sitting Area | 
Presentation Walls |
| 
Association Room | 
Visitors Parking | 
Car wash facility |

SPECIFICATIONS



STRUCTURE

"R.C.C. framed structure to withstand Wind & Seismic Loads."

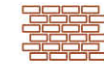

SUPER STRUCTURE

"8" thick solid block work for external walls & 4" thick solid block work of internal walls



DOORS

Main Door: 8' height Designer teak Wood frame with flush shutter of melamine Matt polish fixed with reputed make hardware of SS of Haffle, Godrej, or Equivalent make

Internal Door: 7' height Designer teak Wood frame with laminated flush shutter fixed with reputed make hardware of SS of Haffle, Godrej or Equivalent make

French Doors: UPVC Sliding door of single glazed unit complete with toughening / Heat strengthening at vision panel system with designer hardware of reputed make and fly proof shutter of reputed make

Windows: UPVC Window of Single glazed unit complete with toughening/ Heat strengthening at vision panel system, with provision for mosquito mesh shutter of reputed make

Grills: Aesthetically designed, Mild Steel (M.S) grills with Enamel paint finish for all floors



PAINTING

Internal: Internal walls/Ceiling: Smooth Putty finish with 2 Coats of Premium Acrylic Emulsion of reputed make, over a coat of Primer

External: Textured/Smooth finish with 2 coats of Exterior Emulsion paint of Reputed make



DADOING

Toilets: Anti skid /glazed ceramic tiles for walls and floor

Utility: Glazed designer ceramic tiles up to 4'-0" near the wash area"



FLOORING

Living / dining: 800 X800 mm size Vitrified tiles

Master Bed Room: 800 X800 mm size Vitrified tiles

Other Bed Rooms: 800 X800 mm size Vitrified tiles

Kitchen: 800 X800 mm size Vitrified tiles

Staircase: Granite flooring up to second floor and kota / tandur stone for remaining floors

Corridors: Vitrified tiles with granite inlay in combination of 2X2 and 2X4 sizes

Block Entrance Lounge: Imported Italian Marble flooring

Lift Lobby: Bigger Firmat Tiles

Lift Cladding: Bigger Firmat Tiles



KITCHEN

Kitchen Platform: No kitchen Platform

Utility area: Dish washer and washing machine provision in the utility area



BATH ROOMS

- Wash basin Reputed make

- EWC with Concealed flush valve of Reputed Make

- Single lever fixtures with wall mixer cum shower

- Provision for Geysers in all Bathrooms.

- All C.P. fittings" All C.P. Fittings are Chrome Plated of reputed make Equivalent to Jaquar/ Kohler/ Hindware/ CERA etc



ELECTRICAL

- Power plug for cooking range chimney, refrigerator, microwave ovens, mixer / grinders in kitchen, Washing machine and dish washer in Utility Area.

- 3 phase supply for each unit and individual Meter Boards

- Miniature Circuit breakers (MCB) for each distribution boards of reputed make legrand / Schneider etc

- Elegant designer Modular Electrical switches



TELECOM / I-NET / CABLE TV

FTH with WiFi internet DTH, Telephone & Intercom



AIR CONDITIONING

Provision for Split AC's for all Bed rooms & Drawing Room



HOME AUTOMATION WITH FACILITY

- Provision for VDP

- Provision to install Wi-Fi within Home



LIFTS

High speed automatic passenger lifts with rescue device with V3F for energy efficiency of reputed make of Schindler / Kone / Jhonson/Mitsubishi



SECURITY, SURVEILLANCE AND BMS

- Solar Powered Security Fence

- Access Control at main Gate with Access card reader

- Boom Barrier operated with Access card readers

- Boom Barrier near entry to basements to allow only Owners Vehicles

- CC Cameras around the Campus for surveillance during night

- Provision for video door phone for each apartment connected to security for screening of the visitors

- The Complete building shall be provided building management system with all facilities



WTP & STP

- Fully Treated Water made available through an exclusive water softening and purification plant with water meters for each unit

- A Sewage Treatment plant of adequate capacity as per norms will be provided inside the project, treated sewage water will be used for the landscaping and flushing purpose



POWER BACK-UP

100% D.G Set backup with Acoustic enclosure & A.M.F



FIRE SAFETY

- Fire hydrant and fire sprinkler system in basements

- Control panel will be kept at main security



LPG RETICULATION*

Supply of gas from Piped Gas to all individual flats with meters



WASTE MANAGEMENT*

Garbage Bins will be provided for every floor level and centrally collected for better disposal



CAR WASH FACILITY*

Car Wash facility will be provided in the parking floors



Nearby Locations

Shopping Malls: Inorbit Mall • Ikea • Sujana Forum Mall • Manjeera Mall • AMB Mall • Asian GPR

Educational Institutes: Kennedy Global School • Silver Oaks School • Delhi Public School • Oakridge International School

MNC's: Hitech City • Gachibowli • Kondapur

Hospitals: Mamatha Medical College and Hospital • SLG Hospital • Relief Hospital • Malla Reddy Hospitals

Nearby landmarks: ORR • Miyapur X Road • Miyapur Metro Station • JNTU

Brands We Use

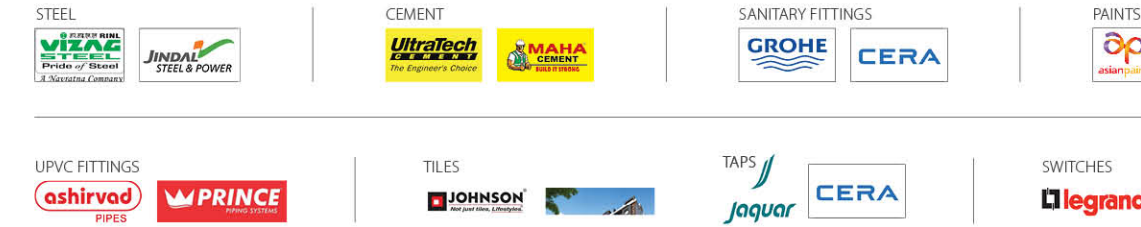

Completed Projects



GOTHIC PRIDE



GOTHIC PINNACLE



GOTHIC PHOTON



GOTHIC PARAMOUNT



www.gothichomes.in
sales@gothichomes.in

RERA NO:
P02200002902



Plot No : 49, Black Diamond Enclave, Near Keshav Reddy School, Bachupally, Hyderabad. 500090



NOTE : This brochure is purely conceptual and not a legal offer. Area is tentative and actual areas arrived at completion of the flat. The promoters reserve the right to make changes in elevation, plans & specifications as deemed fit.

