

OUR COMPLETED PROJECTS



KVSS SRINIVASA



SESHADRI



NEELADRI



VENKATADRI



GARUDADRI



ANJANADRI



VRUSHABADRI

www.kvssconstructions.com

Project by:



for any queries please contact :



kreadz  
www.kreadz.com

OFFICE ADDRESS: Balaji Nagar, Road No. 3, Court Road, Medchal, Medchal - Malkajgiri Dist. - 501401

SITE ADDRESS: Beside The Creek Planet School (Orbit Campus), Raghavendra Nagar, Medchal, Medchal-Malkajgiri Dist, Telangana - 501 401. | Email: kvssdeveloper@gmail.com

NOTE : This brochure is only a conceptual presentation of the project and not a legal offering. The promoters reserve the right to make changes in the elevation, plans and specifications as deemed fit.



# KVSS Iudasi vanam

A SACRED  
ABODE  
SHAPED BY  
SILENCE &  
GRACE



Affordable 2 & 3 BHK Gated Community Apartment @ Medchal, Hyderabad.



**OVER 1 ACRE**  
OF SERENE GATED COMMUNITY

NEAR THE THRIVING COMMUNITY  
**BESIDE NH-44 HIGHWAY**

LOW DENSITY  
**TWO BLOCK GATED COMMUNITY**

**MODERN INFRASTRUCTURE**  
FOR SEAMLESS & CONVENIENT LIVING

**INDIVIDUAL FLATS OF**  
2BHK - 60 FLATS, 3BHK - 30 FLATS

**FLAT SIZES**  
1285 - 1500 - 1630 SFT.

**PLANNED WITH  
PURPOSE,  
DEFINED BY BALANCE**

Tulasi Vanam is shaped by a clear intent to create living spaces that feel measured, thoughtful and inherently balanced. Every decision follows a purpose, ensuring that form, function and experience work together seamlessly. The focus is on clarity in design, ease in movement and a living environment that feels composed rather than crowded.

This approach results in a community where daily life flows naturally, supported by thoughtful planning and a sense of restraint. By balancing practicality with comfort and structure with openness, Tulasi Vanam offers a way of living that feels grounded, enduring and quietly refined.



KVSS  
**Tulasi**  
vanam



**MORE SPACE.  
FEWER HOMES.  
BETTER LIVING.**

Tulasi Vanam is a tranquil gated community of 2 & 3 BHK apartments located in Medchal, Hyderabad. Spread across one acre, the project is thoughtfully planned as a low-density development with just two residential blocks, offering enhanced privacy, open spaces and a peaceful lifestyle.

Developed by KVSS Constructions, Tulasi Vanam features well-designed homes with efficient layouts, natural light and ventilation. Supported by well-planned infrastructure and carefully selected amenities, it is a balanced residential offering that combines practicality, comfort and long-term value.



KVSS  
**LuLasi**  
vanam

A FACADE SHAPED  
WITH QUIET  
CONFIDENCE



BLOCK-A

BLOCK-B

KVSS  
**Julasi**  
vanam

WHERE SPACE,  
FORM & CALM MEET  
LUSH GREENSCAPES

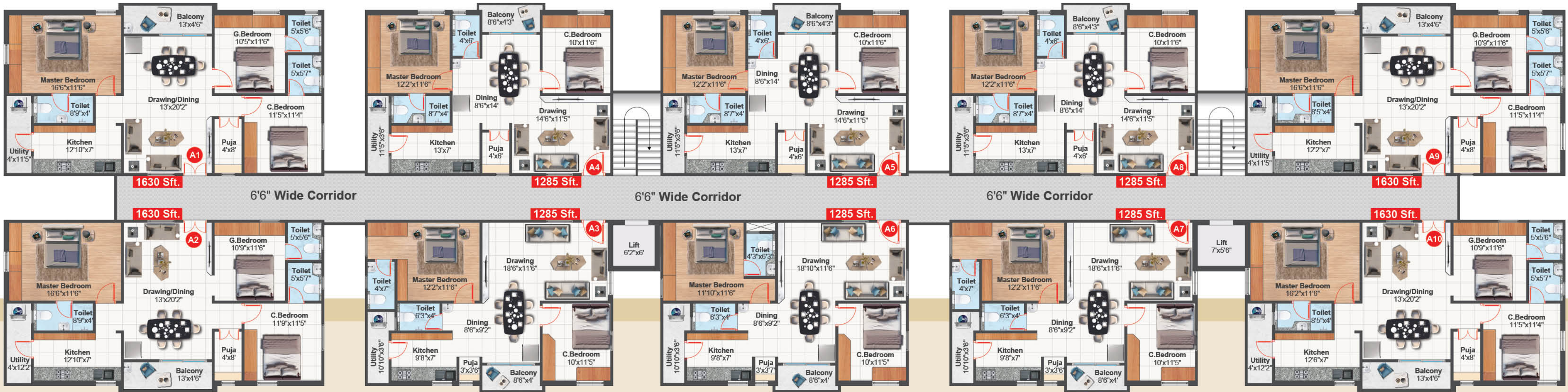

## A FRAMEWORK THAT BRINGS EVERYTHING INTO HARMONY

The master plan of Tulasi Vanam is conceived as a cohesive framework that brings together spaces, movement and moments of pause in a balanced manner. Each element is placed with intention, allowing the community to function smoothly while maintaining a sense of openness and calm. The result is a well-ordered environment where design supports everyday living and creates a natural rhythm across the entire development.



### BLOCK - A | TYPICAL FLOOR PLAN

Flat No	A1	A2	A3	A4	A5	A6	A7	A8	A9	A10
Unit	3 BHK	3 BHK	2 BHK	2 BHK	2 BHK	2 BHK	2 BHK	2 BHK	3 BHK	3 BHK
Facing	East	West	West	East	East	West	West	East	East	West
Area in Sft.	1630	1630	1285	1285	1285	1285	1285	1285	1630	1630

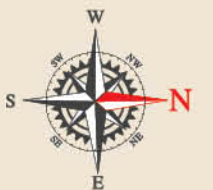

# ISOMETRIC VIEWS



3 BHK **1630** Sft.  
East Facing



2 BHK **1285** Sft.  
East Facing



3 BHK **1630** Sft.  
West Facing

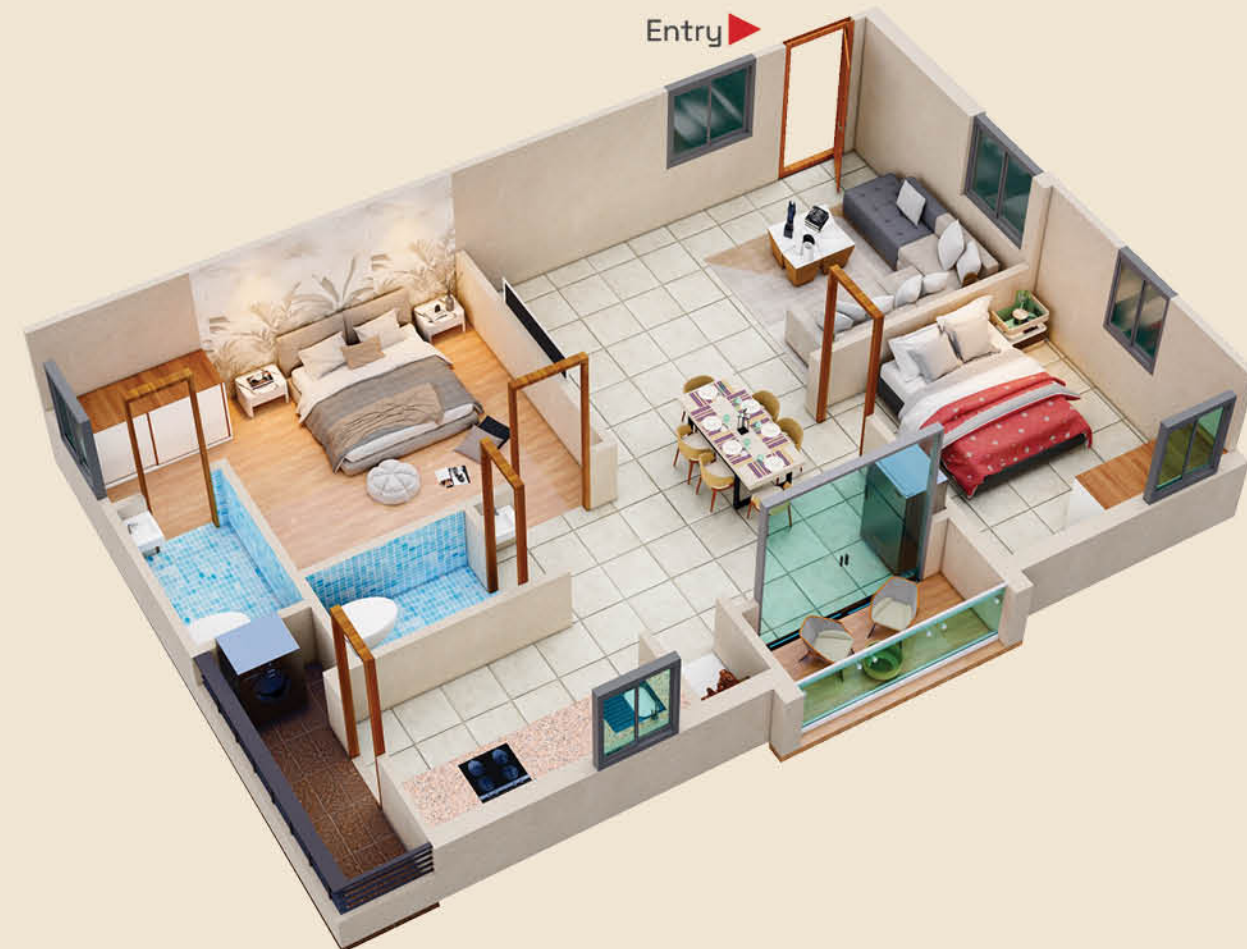

2 BHK **1285** Sft.  
West Facing

BLOCK - B | TYPICAL FLOOR PLAN

Flat No	B1	B2	B3	B4	B5	B6	B7	B8
Unit	2 BHK	2 BHK	2 BHK	3 BHK	3 BHK	2 BHK	3 BHK	3 BHK
Facing	West	East	East	West	West	East	East	West
Area in Sft.	1285	1285	1285	1285	1285	1285	1500	1500

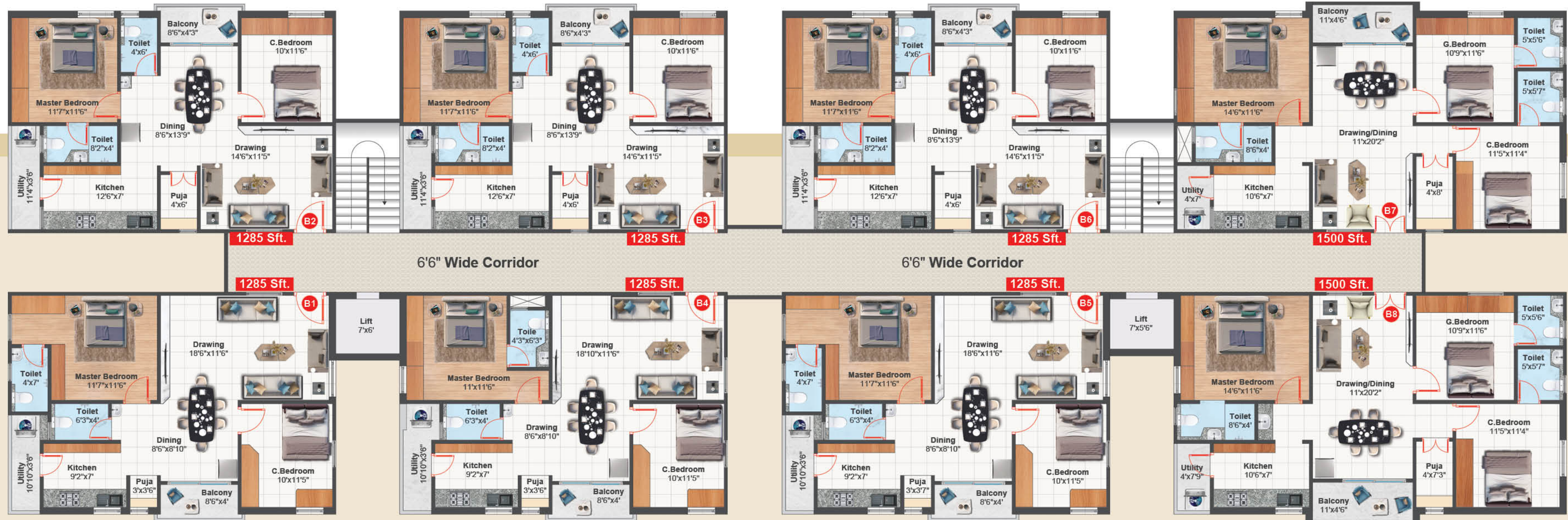



GROUND FLOOR & PARKING PLAN

BLOCK - B BASEMENT FLOOR & PARKING PLAN

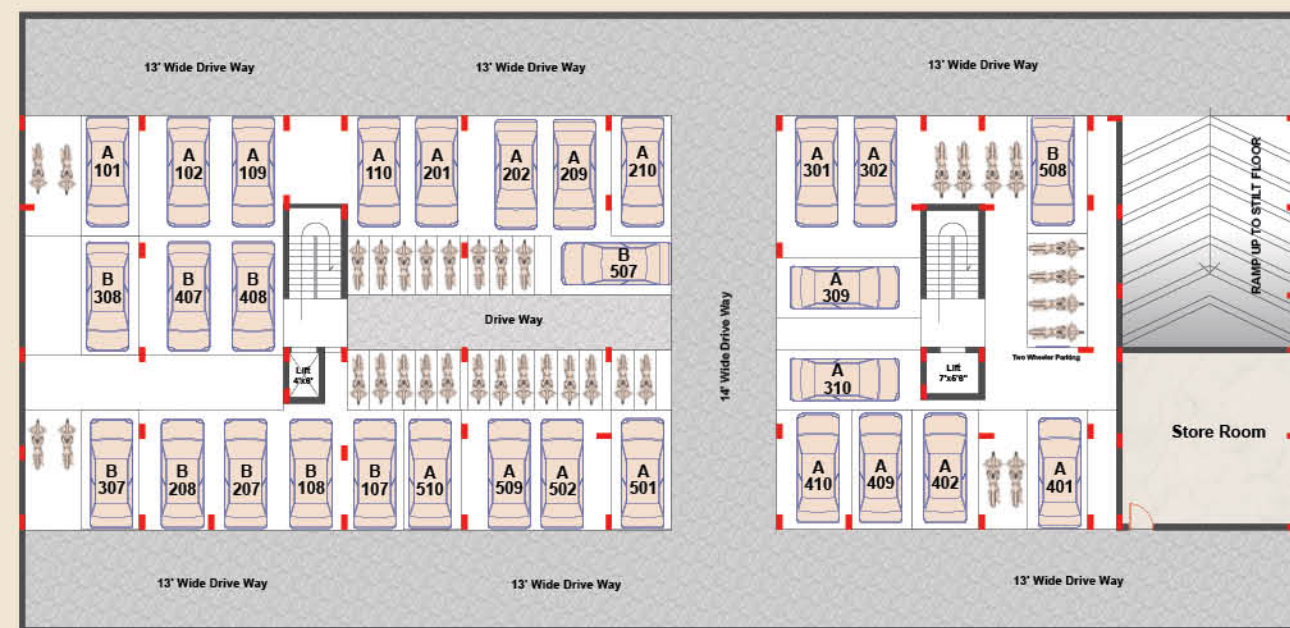

1. GYM
2. Watchman Rooms
3. Badminton Court
4. Multi Purpose Hall
5. Way to Basement
6. Landscaping & Open Party Zone
7. Gazebo
8. Children Play area
9. Sitting Area
10. Box Cricket





At Tulasi Vanam, amenities are not treated as mere add-ons but as essential components of daily living. Each space is thoughtfully planned to support comfort, wellness and community interaction, while ensuring ease of access and practical usability. The amenities are seamlessly integrated into the layout to enhance everyday routines, encourage active lifestyles and create a well-rounded living environment within a secure gated community.



WHERE LIFE  
FINDS ITS  
RHYTHM

## AMENITIES & FEATURES

- Separate Entrance & Exit
- Walking Track
- Multipurpose Hall
- Box Cricket
- Children's Play Area
- Gym
- Security Cabin
- Badminton Court
- CCTV Surveillance
- Beautiful Landscaping





## SPECIFICATIONS

**FOUNDATION & STRUCTURE**  
 RCC-framed structure with seismic-resistant design.

**SUPER STRUCTURE**  
 Red clay brick work with cement mortar.

**JOINERY WORKS**  
 Main Door: Teak wood frame with teak veneer Door with polish  
 Internal Doors: WPVC frame with flush doors.

**WINDOWS**  
 All windows are UPVC with safety iron grills.

**PLASTERING**  
 Internal: Double-coat cement plastering finish.  
 External: Double-coat cement plastering finish

**KITCHEN**  
 Granite platform with stainless steel sink and 2' dado above the platform with ceramic glazed tiles.

**PAINTING**  
 Internal: Tractor Emulsion paint with roller finishing over putty finish.  
 External: Weather proof cement based paint for all external walls

**TOILETS**  
 Ceramic wall tiles with cladding up to door height & Anti skid ceramic tiles for flooring

**PLUMBING**  
 CPVC fittings standard-make.  
 PVC fittings standard-make.  
 Bathroom sanitary standard-make.

**FLOORING**  
 Vitrified tiles of 4'X2' or 2'X2' size for hall, dining, bedrooms and kitchen. Anti Skid tiles for balconies, bathrooms and utility area.

**WATER SUPPLY**  
 Underground and overhead storage tanks of suitable capacity with bore-well as an auxiliary source of water supply.

**ELECTRICAL**  
 Concealed copper wiring (standard-make) with Necessary points.  
 Modular Switches (standard-make).

**GENERATOR**  
 Generator for lift, motors, common lighting in the corridor and parking.  
 Generator (standard-make).

**LIFT**  
 Lift of standard-make.

**NOTE**  
 A) GST and Registration etc., applicable extra cost as per Govt. norms.  
 B) Flat will be handed over for wood work / interior work after receiving 100% Payment only.



# LOCATION MAP

(Not to scale)



WHERE YOUR  
WORLD ALIGNS  
EFFORTLESSLY

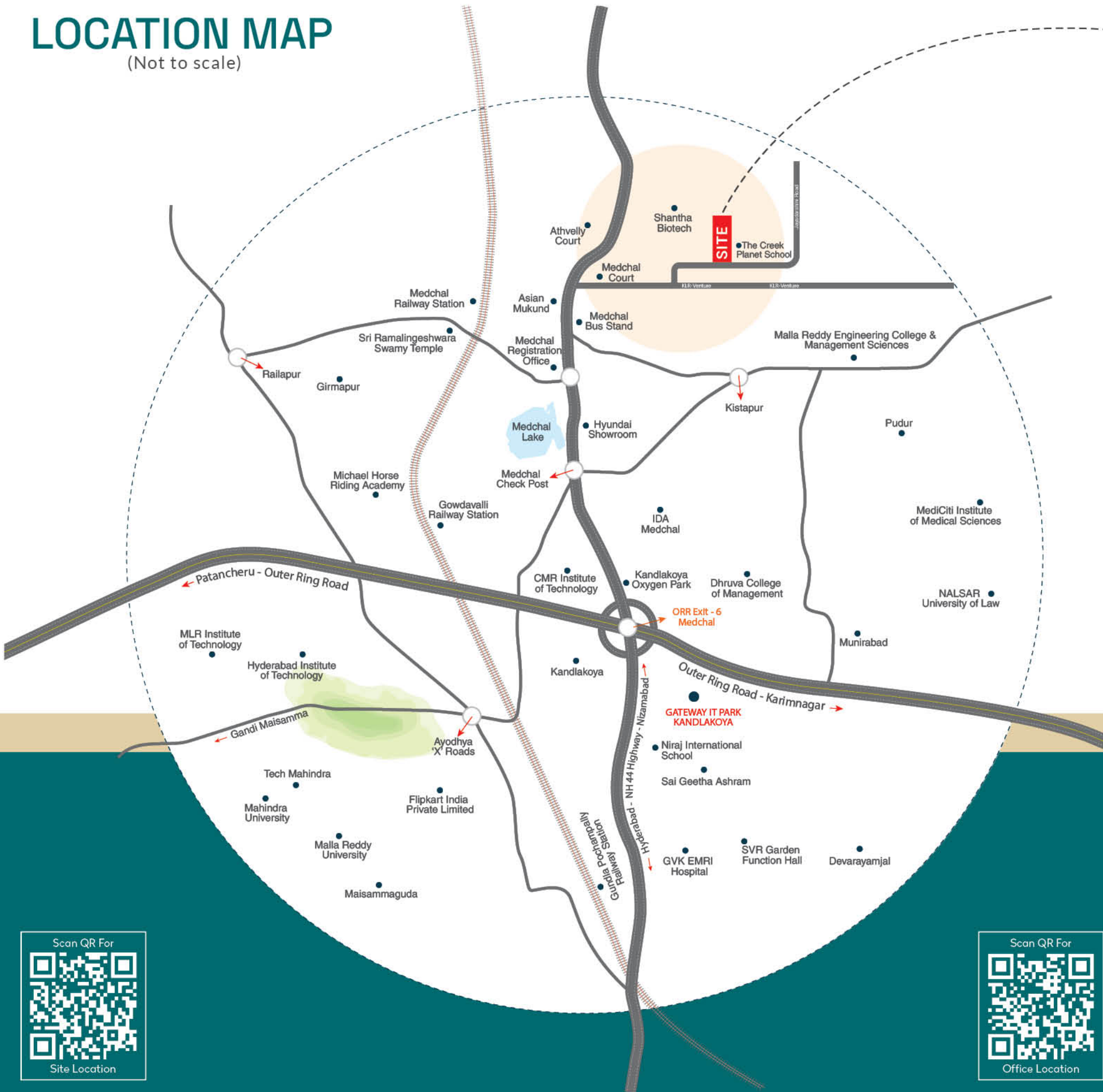

## PROXIMITY

CONNECTIVITY		HOSPITALS		SCHOOLS		SHOPPING & ENTERTAINMENT	
NH-44	5 Min	Leela Hospital	5 Min	The Creek Planet School	1 Min	Asian Mukund	5 Min
Bus Station	7 Min	Medinova Hospitals	4 Min	Vignan School	2min	Trends	5 min
Railway Station	8 Min	Pragna Hospital	5 Min	CMR School Medchal	4 Min	Ratnadeep	5 Min
Ring Road	14 Min	Samprada Hospital	5 Min	St. Claret High School	5 Min	National Mart	5 min
IT HUB Gateway	10 Mins	Jaitra Multi Speciality	5 Min	Bachpan School	5 Min	CMR Shopping Mall	6 min
Karimnagar Highway	20 Min	Aditya Hospitals	7 Min	MLR IT	5 Min	KFC	6 Min
				Delhi World School	11 Min	Mc Donald's	11 Min
				Niraj International	15 min	Pista House	12 Min
				CMR Institute of Technology	12 Min	Asian Cineplanet	20 Min
						D-Mart	22 Min

IT Hub Gateway

Kandlakoya Oxygen Park

Genome Valley

6 Lane Nagpur Highway - NH 44

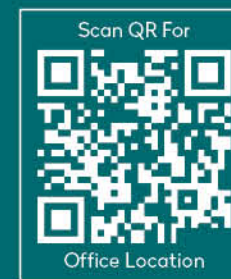

Site Address : **KVSS Tulasi vanam**

Beside The Creek Planet School (Orbit Campus), Raghavendra Nagar, Medchal, Medchal-Malkajgiri Dist - 501 401.

TEAM

Architects & Engineers :  
**Pinnacle Architects**  
Srinagar Colony, Hyderabad.

Design & Branding :  
**KreAdz Advertising**  
Manikonda, Hyderabad.