

Olive Green *Infra*



Sunees Pride



Where City Living Meets
COMFORT and CONVENIENCE

3BHK Luxury Flats

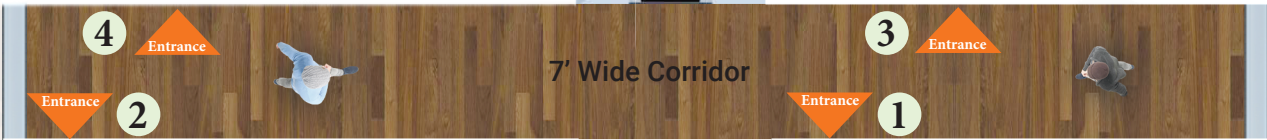
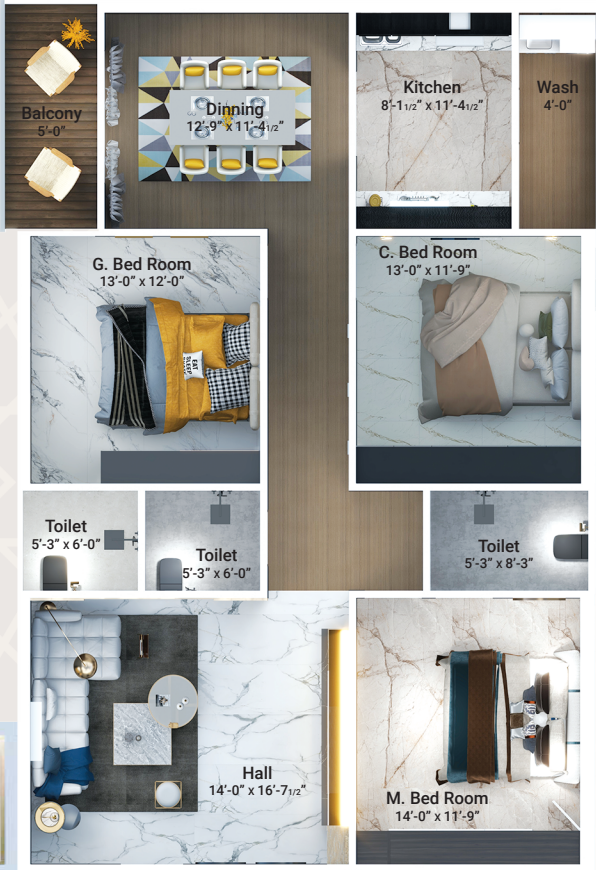
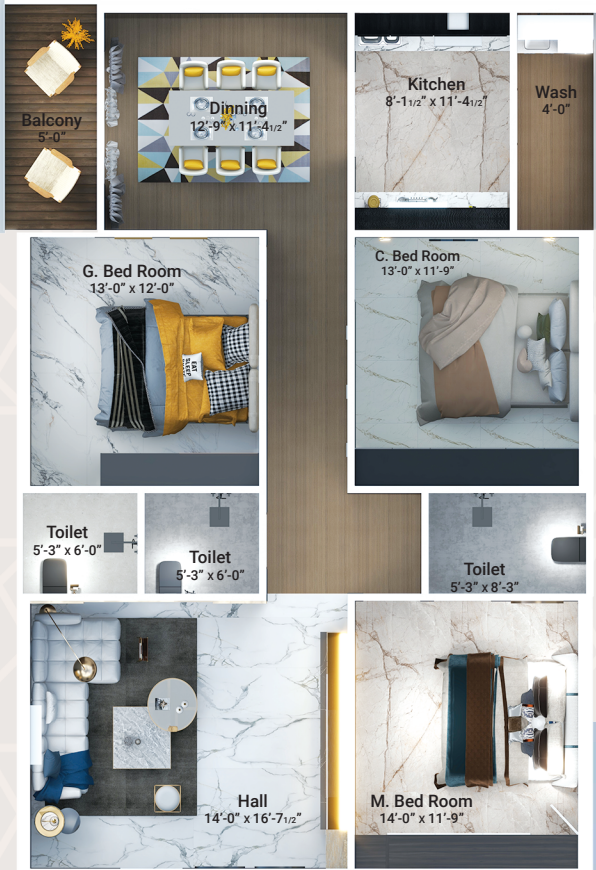

Well Planned
Design



100%
Vastu



Senior Citizens
Sitting Area



Near to
NH-16



Flat No.3 & 4
3BHK | 1910 sft

West
Facing

Olive Green Infra Area				
Flat	Plinth	Common	Parking	Total
1	1410	350	150	1910
2	1410	350	150	1910
3	1410	350	150	1910
4	1410	350	150	1910



Flat No.1& 2
3BHK | 1910 sft

East
Facing

SPECIFICATIONS

STRUCTURE:

RCC Structure walls 9" thick external & 5" internal walls.

WINDOWS :

UPVC windows with glass slidings shutters used M.S safety grills with mosquito mesh.

FLOORING:

Premium quality vitrified tiles.

KITCHEN:

Granite platform with stainless steel sink, 4' height ceramic tiles dado above platform.

SANITARY:

Kerovit / Bafit / Parryware / Equivalent CP Fittings & Sanitary.

DOORS:

Maindoors with teak wood polish & other doors with engineered wood frame and flush doors.

ELECTRICAL:

Concealed copper wiring of RR /Polycab/ Finolex/Equivalent. Switches,Dp, Mcb from Legrand.

PAINTING:

Asian/Berger/Birla Opus/Nippon/Equivalent emulsion paint for interiors, water-proof emulsion paint for exterior.

TOILETS:

Anti-skid ceramic tile flooring wall tiling upto 7 height with glassed ceramic tiles.

T.V & TELEPHONE:

T.V Point in Living.

POWER BACKUP :

Generator for Common Services / Lights & Fans are also provided in each Flat.

LIFT:

Altis / Sunrise Equalant for 6 Passengers.

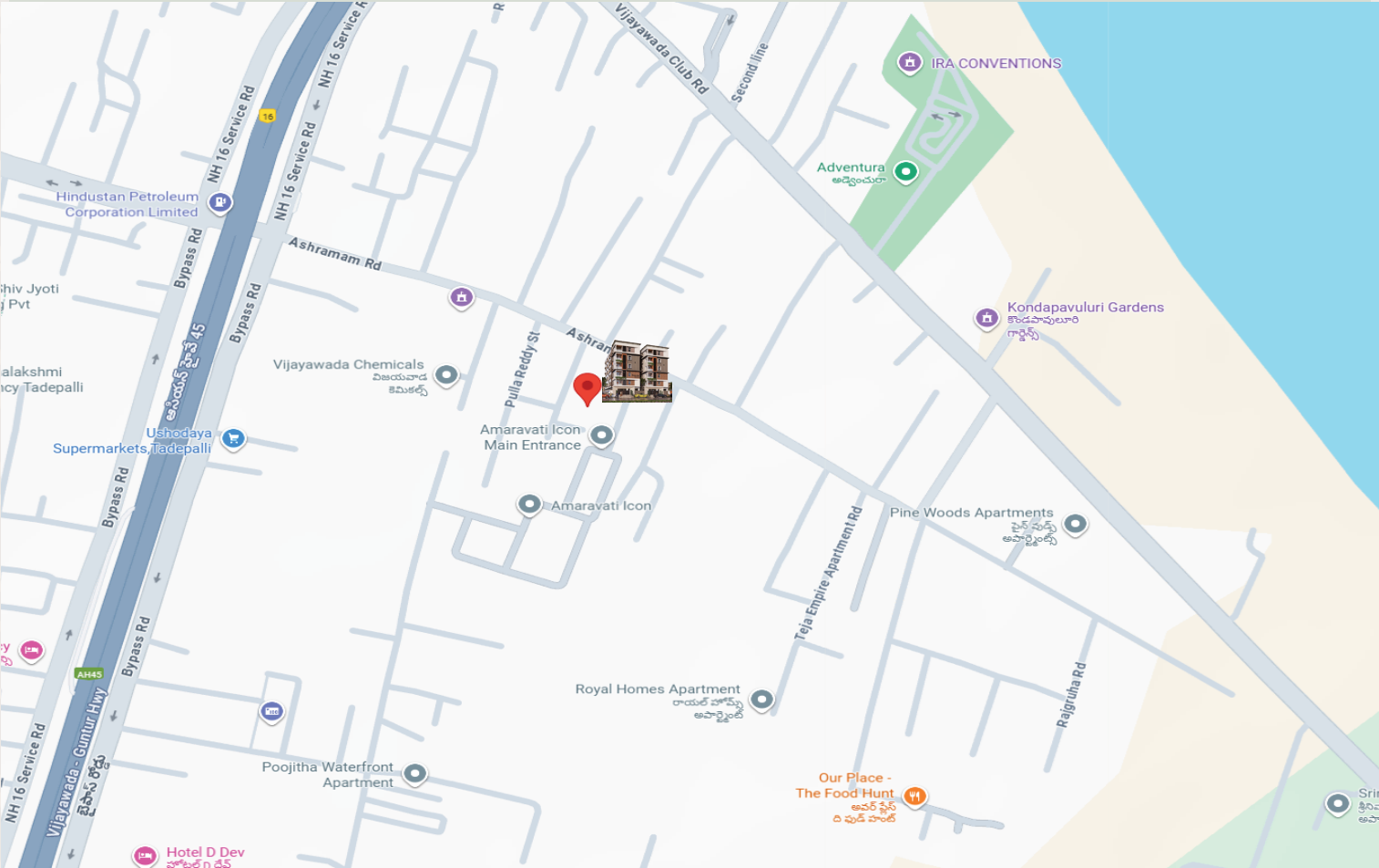

For any queries please Contact

Hari :+91 96406 45456 | Hussain :+91 9030 175 615 | Satish :+91 99632 44067

Olive Green Infra
Sunees Pride



Consultant
GREEN HOUSE
associates

Near old Check post, Yenamalakuduru laku road
Opp. C.T. Office, Krishna nagar, Patamata, Vijayawada
Ph. No : +91 9030 175 615, +91 888 555 6274

NOTE: This brochure is only a conceptual presentation of the project and not a legal offering. The promoters reserve the right to make changes plans and specification as deemed fit