

HYD ERAB AD

yoo **hyderabad**

myscape

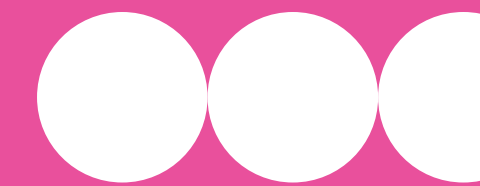
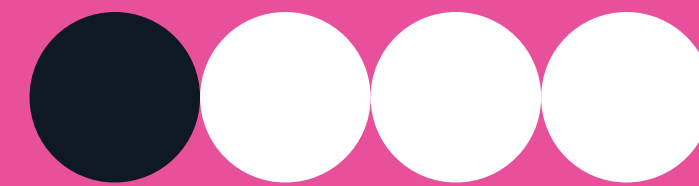
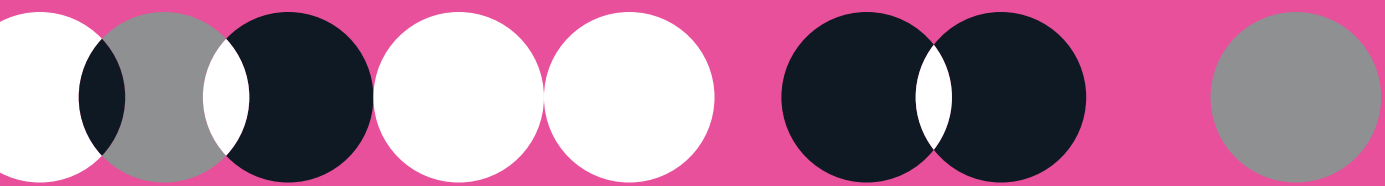

DESIGNED — ED AROUND YOU

yoohyderabad
by myscape

Hyderabad's first ever branded residences located in the financial district, YOO Hyderabad is developed by myscape, in collaboration with YOO. People form the crux of every YOO project, and YOO Hyderabad is no different.

Starting from the landscaped garden, the atrium, the grand promenade, the apartments and all other amenities have been imagined with people at the core. It is your taste and preferences that have inspired them all. YOO Hyderabad revolves around you. It is designed around you.

WHO YOO ARE

YOO is a truly diverse and eminent lifestyle brand that believes in the philosophy of enhancing life through original design. A global entity, YOO has the expertise to seamlessly assimilate into the local design fabric, making it glocal.

YOO was founded in 1999 as a result of a partnership between property entrepreneur John Hitchcox and the world's most celebrated designer, Philippe Starck. The YOO Design Studio compete successfully in the residential and hotel marketplace, by providing the very best in design, and placemaking. YOO's experience spans 70 different projects in 36 countries, working with international developers, designing landmark residential and hotel projects throughout Asia, Australia, Europe, Africa, North and South America and the Middle East.



Mark Davison,
Creative Director YOO



Steve Leung for YOO



Kate Moss for YOO

WORLD — CLASS DESIGN



YOO Inspired by Starck



Wanders & YOO

YOO is a branded lifestyle and design orientated place maker, with seven leading designers, seven unique visions and one aim: to create extraordinary living, working and hotel spaces.

YOO is not just about design: it's about creating a lifestyle through amazing amenity spaces and common areas where people can come together and get to know each other. Spaces to inspire the feeling that anything is possible.



Sussanne Khan for YOO



Jade Jagger for YOO



“The principle behind YOO is to enhance lives through original design and generate communities with an emphasis on conscious living.”

John Hitchcox
Chairman, YOO Group

52 FLOORS
2 BLOCKS

99 APARTMENTS
8325 SQ FT EACH



LINLEAR FORMS

360° VIEWS

WORKING

PODS

SPACIOUS LUX

SKY LOUNGE

CLUBHOUSE

LAP POOL

LINLEAR FORMS

COMMUNITY

Call it the Master Plan. Or admire it as Masterpiece of a plan.

Hyderabad's first ever branded residences located in the financial district, YOO Hyderabad is developed by myscape, in collaboration with YOO, the world's largest residential design entity.

It is one tower of 52 floors, divided into two blocks consisting of 99 apartments in total. The core design concept effortlessly dovetails into three main elements of Linear Forms, Hidden Gem and Immersing Nature

The YOO magic begins right at the Ground Floor, and then slowly spreads upwards with rhyme and rhythm. Be it the two different access points,

the unique immersing landscaping greenery, the Grand Atrium with its exclusive 12m high ceiling, the two lift lobbies and lounges, the receptions, the café lounge and working pods, the gym, the arcade—all embellished with a mix of natural materials, bold colours and geometric patterns. Designs, elements and objects that are no less than works of art, strewn around thoughtfully to bring the spaces alive.

Completely Vastu compliant, the tower has 52 floors with one single apartment on each floor, overlooking the financial district on the northern side, and verdant land with lake on the

southern side. It has two blocks with 3 passenger lifts and one service lift for each block.

Slowing down at the 31st floor is a must as it houses the breathtaking Sky Lounge. What's more, walking into your apartment is no less a spatial experience as it is in the exterior. The YOO design geniuses have created each apartment with the right balance of opulent luxury and fundamental functionalities. Not to mention, the Clubhouse that's built to artistic perfection. **Welcome to the Masterpiece of a plan.**

A tapestry of designs that weave into each other seamlessly, an opulence of space that liberates; but YOO Hyderabad is more than just designing a lifestyle, it is about creating a vibrant community that comes alive with energy, enthusiasm and togetherness – every moment of life.

BUILDING
HOMES.
CREATING
COMMUNITIES.
REDEFINING
LIFESTYLES.

One of the tallest towers consisting of 99 apartments, YOO Hyderabad by myscape is an epitome of spacious luxury.



STREET VIEW OF
THE PROPERTY

THE JOURNEY | Two different access points to create a safe, pedestrianized landscape.

TWO DISTINCT VIEWS

22 ●

Design isn't just about beauty; it is about duty too. YOO Hyderabad has been planned to have two access points. One from the northern road, primarily for the guests, straight to the lobby, and one from the southern side, for the residents, directly to the basement parking.

TWO ENTRY POINTS

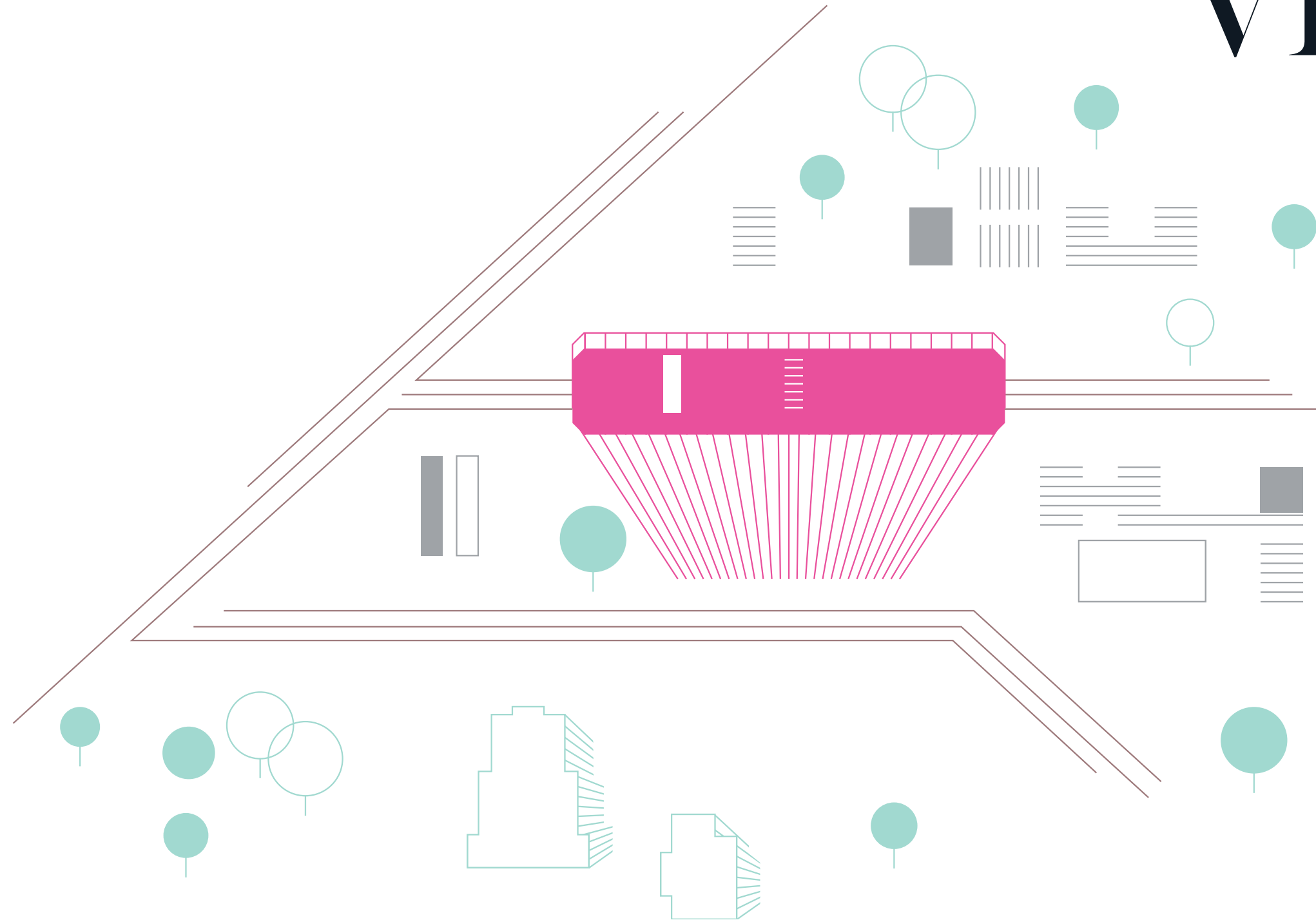

While it gives the residents the convenience to head to the comfort of their apartments directly from the basement parking, the larger vision is to liberate the landscape from excess vehicular traffic by separating the entry of the residents and the guests. It leaves the surrounding comparatively safe for the children. After all, we owe it to our children to give them the space to play out their childhood.

● 23

THE FINANCIAL DISTRICT ON ITS NORTHERN SIDE, VERDANT LAND & A LAKE ON ITS SOUTHERN SIDE.



airport

25 MINS
20 KMS

HITECH CITY

20 MINS
6 KMS

JUBILEE HILLS

20 MINS
8-10 KMS

CONTINENTAL HOSPITAL

2 MINS
1 KM

HYATT, SHERATON

2 MINS
1 KM



north entrance
NORTH ENTRYWAY
TO THE PROPERTY



south entrance
SOUTH ENTRYWAY
TO THE PROPERTY



drop off point
DROP OFF ZONE TOP VIEW

arrival plaza
VIEW OF THE JOURNEY
FROM THE SOUTHERN
ENTRYWAY



DESIGN CONCEPT | Three main elements

The core design concept is inspired by three main elements; linear forms, hidden gems and the immersing nature. The linear geometry of the architecture has been aesthetically sprinkled with structures and objects that one unexpectedly discovers, just like the hidden gems in the nature. Precious yet understated, spectacular yet surreal, unmissable yet unexpected. Last but not the least, the thoughtful and seamless integration of the surrounding landscape with the adjacent interiors, creating a oneness with nature that's commendable.

1 LINEAR FORMS,

2 HIDDEN GEMS, 3 AND THE IMMERSING NATURE

GROUND FLOOR

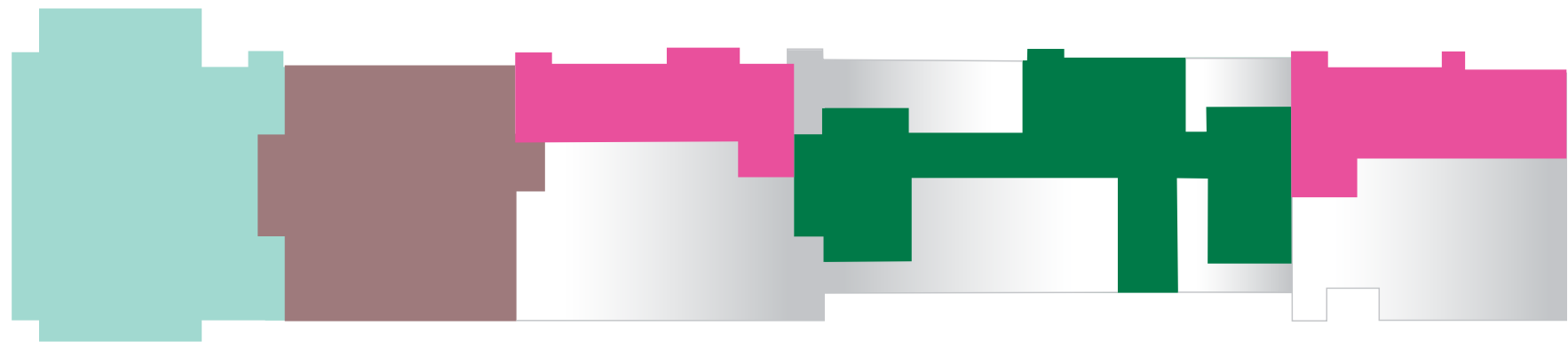

- GYM
- CAFE AND WORKING PODS
- LIFT LOBBY AND LOUNGE 1,2
- RECEPTION 1, 2
- GRAND PROMENADE, GRAND ATRIUM

NOT JUST SPATIAL,
IT'S SPECIAL

THE GRAND PROMENADE

Unbound luxury is the world's most natural welcome.

A calming stroll between the Podium's exotic trees is only a preview of the shape of things to come. Because the stroll leads you into an unmatched vibrancy, the moment you set your gaze on the magnificent YOO tower.

The Grand Promenade is as unique as it gets. It is a horizontal axis connecting a sequence of encounters that enliven the ground experience: the elegant paving of the Arrival Plaza, the double-height, the splendour of the east

and west reception lobbies, a marvellous verandah appointed with sleek Working Pods that come with verdant landscape view on either side, a high-end two-storey gym, and at the other end, the nowhere-seen-before Clubhouse, an unparalleled expression of artistic temperament. The Grand Promenade breathtakingly weaves together the tower, the Clubhouse, along with vast landscapes to create a world-within-a-world.

38 ●

The eternal dilemma:
'Should I spend more
time in the Promenade,
or in my apartment?'



THE GRAND ATRIUM | Welcome to the Grand Atrium.

The 12-meter-high ceiling, amounting to 4 floors, of the Grand Atrium on the ground floor is one of its kind. For the first time in any residential project ever. This not only lets the surrounding greenery to breeze into the aesthetically designed interiors but also allows the residents an uninterrupted view of the periphery. As one move in from the threshold plaza an eclectic feeling takes over. From the plaza, the path leads into the Grand Atrium which stretches from the Gym on the west side to the Arrival Plaza, leading the movement towards the

Clubhouse. The path connecting to the Arrival Plaza floats on the water, connecting the majestic double-volume lounge spaces with vast glass walling that maintains a sense of transparency. A state-of-the-art Gym, Business Centre, Meeting & Conference Hall, sleek modular Working Pods, Waiting Area, Children's Play Area with various colourful amusements, Lounging Space and much more are all extensions of the Grand Atrium, interspersed with water bodies, sculptures, art installations and glass adornments that make it the eclectic haven that it is.

40 ●

Our design standards are high. 12 meters, to be precise



An aerial photograph of a dense forest in shades of green and brown. A pink wireframe grid is overlaid on the image, consisting of vertical lines and horizontal lines that form a series of rectangular and irregular shapes, suggesting a 360-degree panoramic view or a specific geographic grid. The text '360 DEGREE VIEW' is centered in the right half of the image in a white, serif font.

360 DEGREE VIEW

Allow YOO Hyderabad to greet you with the most lavish of entrances

44 ●

Welcome to a reception that's as grand as the lifestyle you are walking into. Imagine being greeted by double-volume, glass-enclosed reception lobbies, on either side of the Atrium entrance. With 12m high ceiling worth looking up to which gazes upon immaculate décor and elegance appointed with tasteful sofas for you to sit down for a while and appreciate the life you have. Now, isn't that the kind of reception where you arrive in life every day?



THE LIFT LOBBY | An unprecedented level of glamour.



A space to lift your spirits

Trust us to push all the right buttons to raise the elegance of even the elevator lobby. The oh-so-everyday prosaic air of elevator lobbies is eschewed here. Instead, what you find is poetry in motion through rich cladding, exquisite furniture and an aura that's out of the ordinary.

The

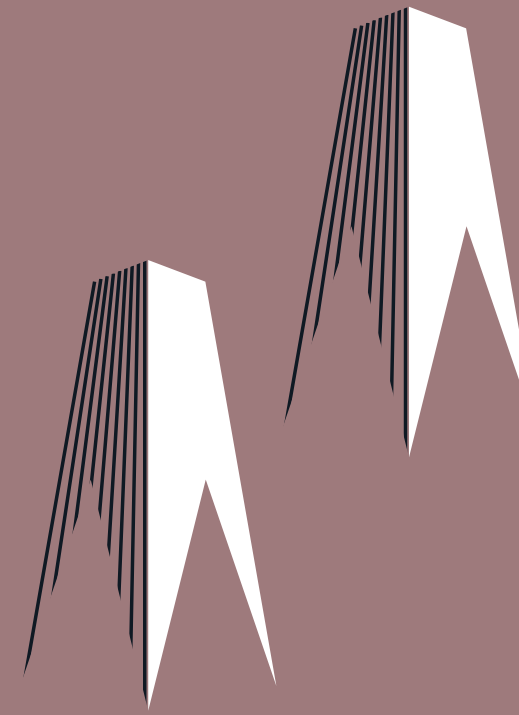
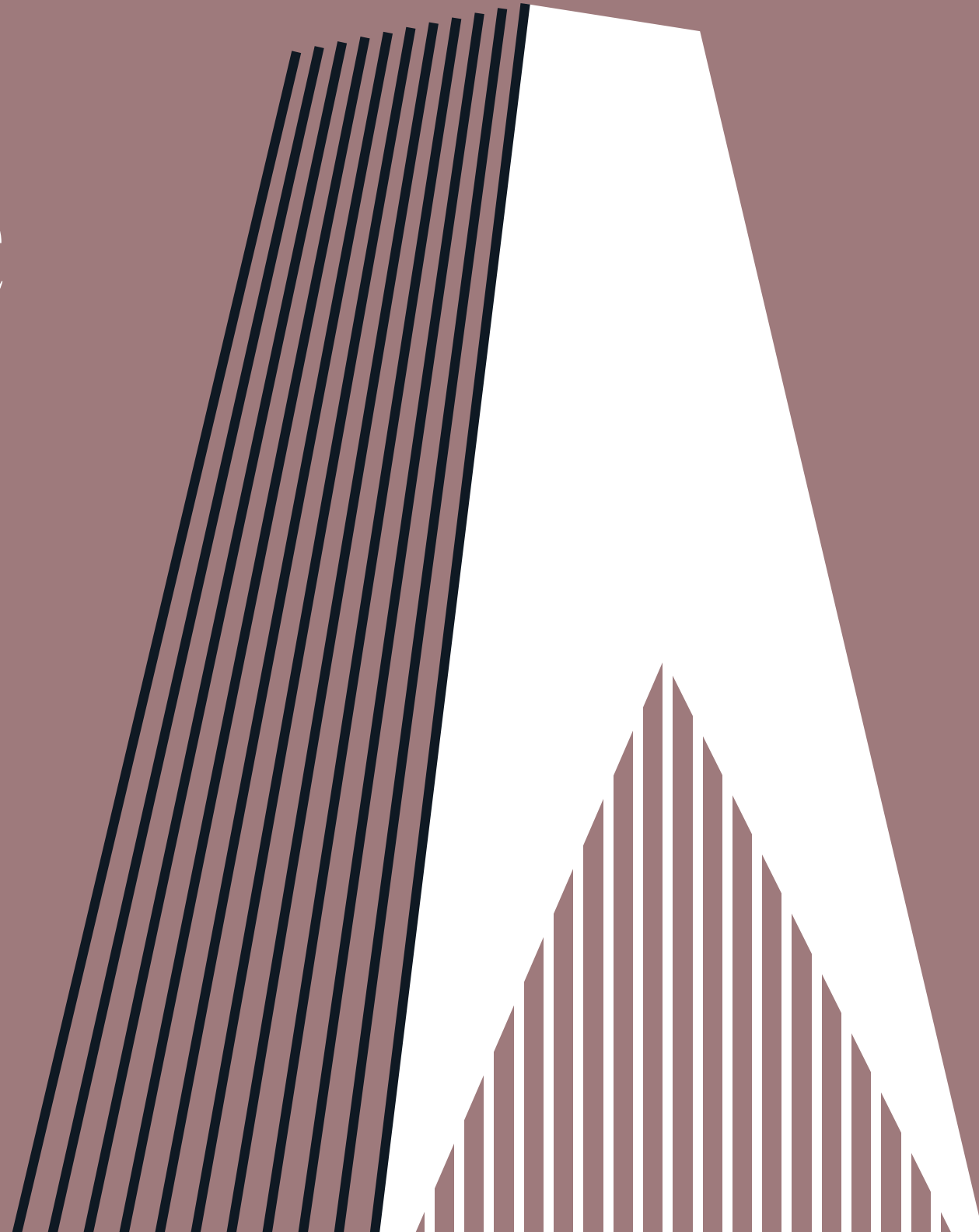

Working
Pods

If work is worship, welcome to the temple



A temple of tranquility. A temple of vibrations. A temple of eclectic designs. What more do you need to transform the 'pressure of work' into the 'pleasure of work'?

Inspired by the idea of 'Hidden Gem', one of the three elements of the core design concept, the Working Pods are created as playful transparent elements, with bold colours and geometric

patterns, strewn around a secret garden to help you dissolve into the serenity while you concentrate on your work. The Pods that are indoors seamlessly extend into the functional lawn outside so that you can work amidst nature whenever you so wish. Or is the Pods that are outdoors flow into the interiors? At YOO Hyderabad, it's difficult to tell.



VIEW OF THE GRAND PROMENADE,
WITH THE WORKING PODS.

THE GYM |

You would ask why. Well, with its young and energising space, combining bold and industrial elements with luxury materials and finishes, the gym is as inviting as a spa. A spiral staircase in bold colours is a central feature of the space.

A two-floor space, the gym is equipped with the latest in the fitness industry. The sculptural spiral staircase connects to the first floor with transparent elevator, creating a sense of openness. The gym's massive terraces open up to the view beyond, maintaining a connect with the nature constantly.



Be always in the mood to hit the gym

FIRST FLOOR ^N



- GYM
- BUSINESS CENTRE

THE
STYLE
IN
LIFESTYLE



The Centre is a blend of luxury and eclectic elements, designed to provide a lighter conference room, a darker meeting room and a fun and colourful lounge set-up upon arrival. Business never looked so good.

Welcome
To The

60 •

yoohyderabad

Apartments

SPACIOUS

When it comes to space, we've put in more. 8325 sqft, to be precise.

One of the tallest towers consisting of 99 apartments, YOO Hyderabad by myscape is an epitome of spacious luxury. From the threshold with the formal living, foyer and the staff quarters to the mid-section with family living room, dining, kitchen, pooja,

guest bedroom and Aangan, right into the inner sanctum with the multiple bedrooms, two additional bedrooms, multipurpose family space and the attached bathrooms, it is space that leads into space and an openness that is the sum of it all.



THREE REALMS

The apartments of YOO Hyderabad, 8325 square feet each, are as unique as they come. Designed to be expansive yet organised, fashionable yet functional, comfortable yet convenient, the apartments are thoughtfully sectioned into three Realms to help you live the maximum life.

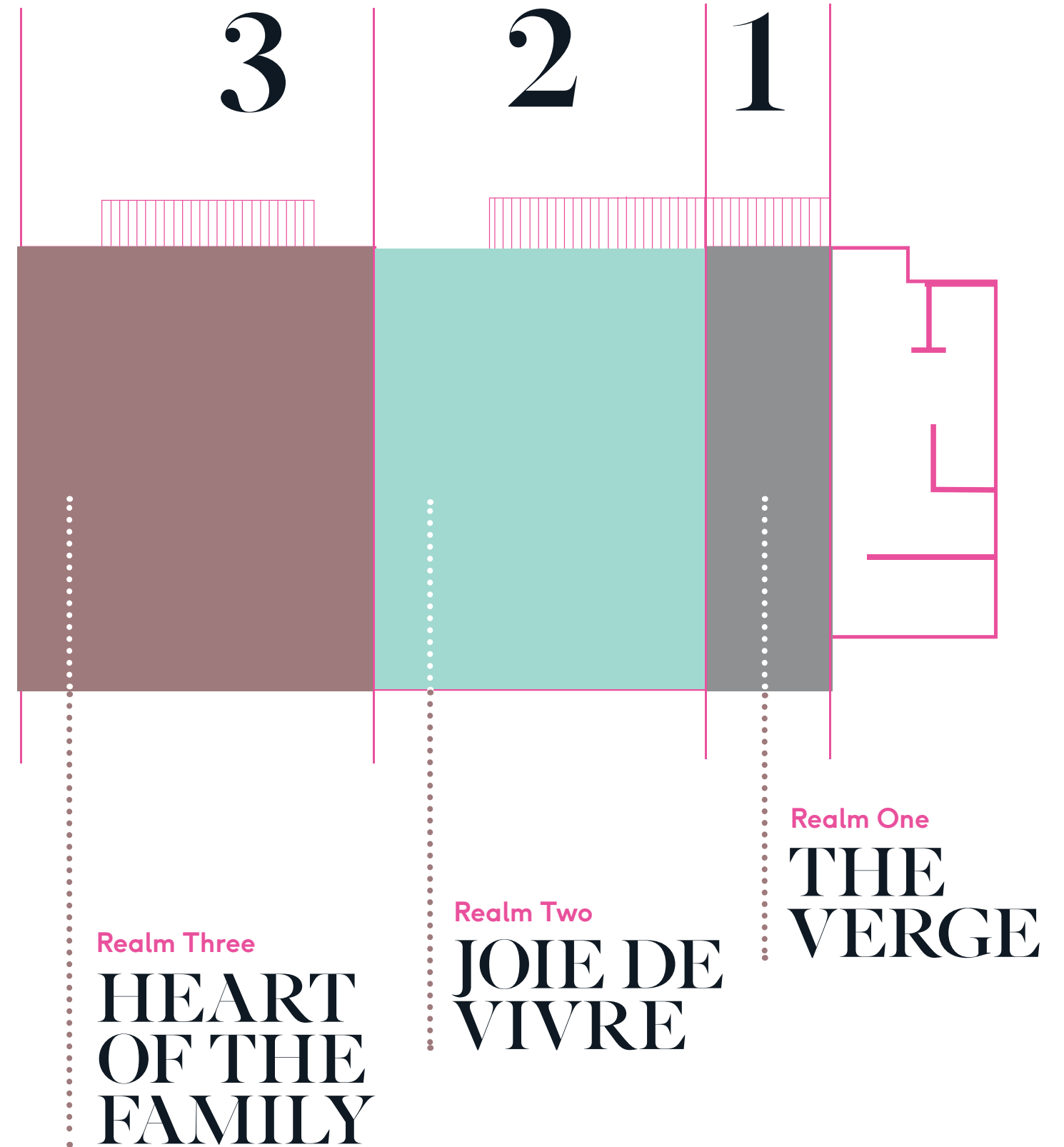

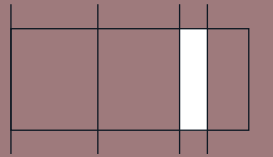

realm one

- PRE ENTRANCE LOBBY
- FOYER
- FORMAL LIVING ROOM
- HOUSEHOLD STAFF QUARTERS
- UTILITY AREA

REALM ONE:

THE VERGE

Privacy begins at the threshold.
Welcome to Realm One: The Verge.

The experience begins at the elevator lobby itself. With just one apartment per floor, one in each block, the residents can have access to their homes in three separate elevators, maintaining the privacy that's so valued. A pre-entrance lobby follows, which is bright with natural light and can be personalised to the owner's preferences.

The majestic entryway of each apartment leads into a foyer which in turn lead to a formal space that can serve as a living room for guests – this again ensures that your privacy is preserved. The service elevator directly lands at the household staff quarters and utility area, which is in the outer layer, further minimising traffic. And this is just the beginning.

REALM ONE: THE VERGE | The Threshold Of Exclusivity.

A fully dedicated elevator lobby outside the entrance of every single apartment, no less. Call it limitless exclusivity when you step out of the elevator into your private haven even before you enter your apartment. The aura of exclusivity starts right here, accentuated by tasteful marble floorings and timeless interiors.



A lobby befitting your apartment

APARTMENT LIFT LOBBY

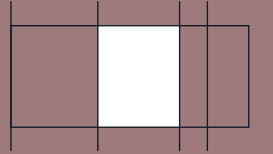

realm two

- FAMILY LIVING ROOM
- AANGAN
- DECKS
- DINING AREA
- KITCHEN
- GUEST ROOM
- PUJA SPACE

REALM TWO: JOIE DE VIVRE

The quintessential refined life.
Cultivated for abundance.
Welcome to Realm Two: Joie De Vivre.

Abundance of space, of elegance,
of nature, of happiness. The realm of 'Joie De
Vivre' includes a Family Living Space, a double
height 'Aangan' that opens up to a deck, Dining,
Kitchen, Guest Room, and the Puja Space. Huge
floating decks on both sides give the space
ample amount of natural light, ventilation, and
uninterrupted view to the north and the south.

AANGAN | The one-of-its-kind 'Aangan' makes it possible.

A double height living space in an apartment is a rarity that offer residents a lifestyle that transcends apartment limitations.

Due to the double height of the space, the 'Joie De Vivre' Realm extends onto two floating decks on both sides, overlooking the views, and with ample natural light and cross-ventilation. The semi-open spaces give the sense of being outdoor while high up in the air – a villa in the sky. An ideal space to chat, lounge, or have an exotic party. Don't be surprised if your friends start visiting you more often.

A villa disguised as an apartment



FAMILY LIVING
& DINING ROOM

| A weave of style and joy.

Making family time worth it

74 ●

Drenched in uninterrupted daylight, and filled with the bright moods of your loved ones, the living room at YOO Hyderabad is an ideal space for all dimensions of life. Relax and spend quality time with your family, entertain your guests, or organise a fun gathering, while soaking in the marvellous views on both the North and the South sides that the generous, full-length fenestrations offer.

While your tastebuds savour the delicacies served on the table, let your eyes feast on the beautiful views that are available, on the North and the South sides, through the large fenestrations. The taste of elegance that is reflected in the immaculately done interiors, is an experience that perfectly goes with your dining. All in all, an unmatched sensory indulgence.



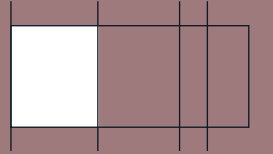

realm three

- MASTER BEDROOM
- TWO ADDITIONAL BEDROOMS
- MULTIPURPOSE FAMILY SPACE
- PRIVATE GATHERING SPACE

REALM THREE: HEART OF THE FAMILY

Because family is sacrosanct.
Welcome to Realm Three:
Heart of the Family.

Essentially the last bastion of privacy, this realm is reserved only for the family. It includes a Master Bedroom, two additional Bedrooms and a multipurpose Family Space, which are clustered around a private gathering space at the core. Catering to different experiences yet continuing with the homogeneity of the apartment.

MASTER BEDROOM | Wake up to a lifestyle beyond imagination.



Your dream bedroom, now a reality

Welcome to the Master Bedroom, fit for a king and his queen. The view of picturesque landscapes through the large windows would seem like paintings. Add to this, the extended deck area that gives you a feeling of limitless expanse. The generously sized bedroom has been divided into three layers

of spaces – sleeping space in the centre, a media space to one side, and a study to the other. If you thought this is spacious, then wait till you discover the opulent walk-in wardrobes, separately appointed for 'you' and 'yours truly', that further lead on to a luxurious bathroom.

MASTER BATH | No one can blame you for spending more time in here.



When the design is the soul of the entire tower, the bathroom is no exception. Elegantly designed with the best bathroom fittings, it is the perfect place to wash away your stress, hum a happy tune, get a bright idea, or simply soak in the luxury. If anyone questions about the amount of time spent inside, blame it on the YOO penchant for creating irresistible spaces.

NURTURED WITH
NATURAL LIGHT.

Large floating decks, balconies.

no shortage of the basic requirements of a fulfilling life- that are usually so hard to find in an apartment

BENEVOLENT BREEZES.

generous fenestration sizes and the double height living space

Ideal for those who live in an apartment but long for the open, liberating and verdant villa life.

VIBRANT WITH
BREATH TAKING VIEW.

A privilege for the chosen few



Floating above the city, the generous landscaped decks offer an outdoor extension to all the major rooms. Cherish the privacy of your home, and at the same time enjoy an outdoor experience that is hard to find in an apartment. Unwind on the deck with a view of spectacular vistas that offer a sense of infinity.

DECK SPACES OPENING UP TO
UNINTERRUPTED VIEWS

The



Sky Lounge

31ST FLOOR

BAR AND LOUNGE
BILLIARDS ROOM
CARDS ROOM
TV ROOM



THE SKY LOUNGE

When it comes to your relaxation, we raise the bar



The Bar & Lounge on the 31st floor is like a resort reserved for the residents. Socialise in sheltered luxury, away from the hustle of the city, floating high in the heavens.



Game on!

A playful experience that ups the residents' entertainment quotient. Patterned floors, ambient lighting and modern art make the games room, cards room and the billiards room a magnet for fun.

The Clubhouse

MULTIPURPOSE HALL
HOME THEATRE
DANCE AND YOGA ROOM
LAP POOL AND DECK
SPORTS ACTIVITIES

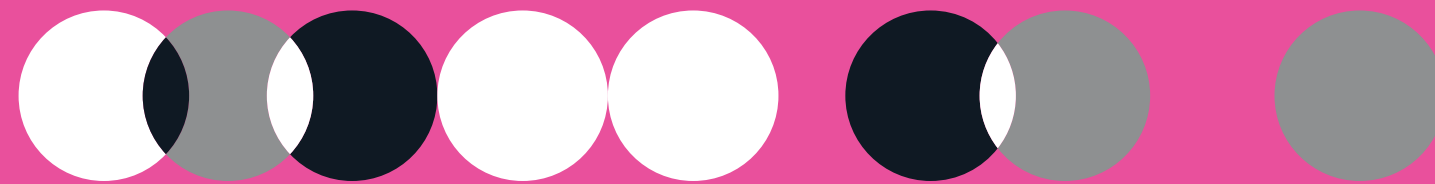
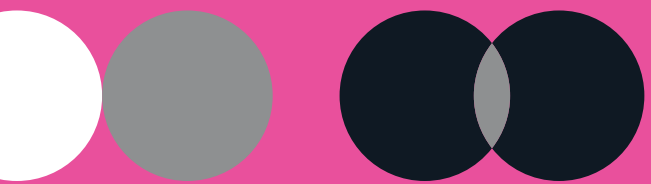

yoohoo

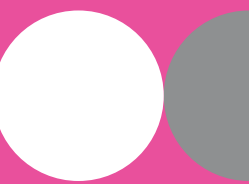



TOP VIEW OF THE CLUBHOUSE,
PICTURE HERE IS THE LAP POOL
AND DECK.

Is it a lantern? Is it the Louvre? Is it a sculpture? No, it is the Clubhouse

98 ●

The artistically designed Clubhouse is located at the entry point of the tower. So dynamic is the architecture, to some it looks like a lantern in the night, to some it resembles the Louvre, and yet to many others it fascinates as an abstract piece of sculpture.

It's all about openness, and not seclusion. So, the landscape around the Clubhouse is designed to allow spaces to flow from inside-out, connecting to the nature.

The Clubhouse holds a grand Party Hall where you can mingle and enjoy to your heart's fill. A Mini Theatre for the joy of community movie viewing with popcorns being passed around. A Yoga and Dance Studio for the fitness as well as the fun enthusiasts. For those who revel in sports, there are table tennis, a badminton court and a squash court. Last but not the least, a temperature-controlled Lap Pool on the terrace, overlooking the breathtaking greenery on the southern side, is there to reiterate that life is indeed beautiful.

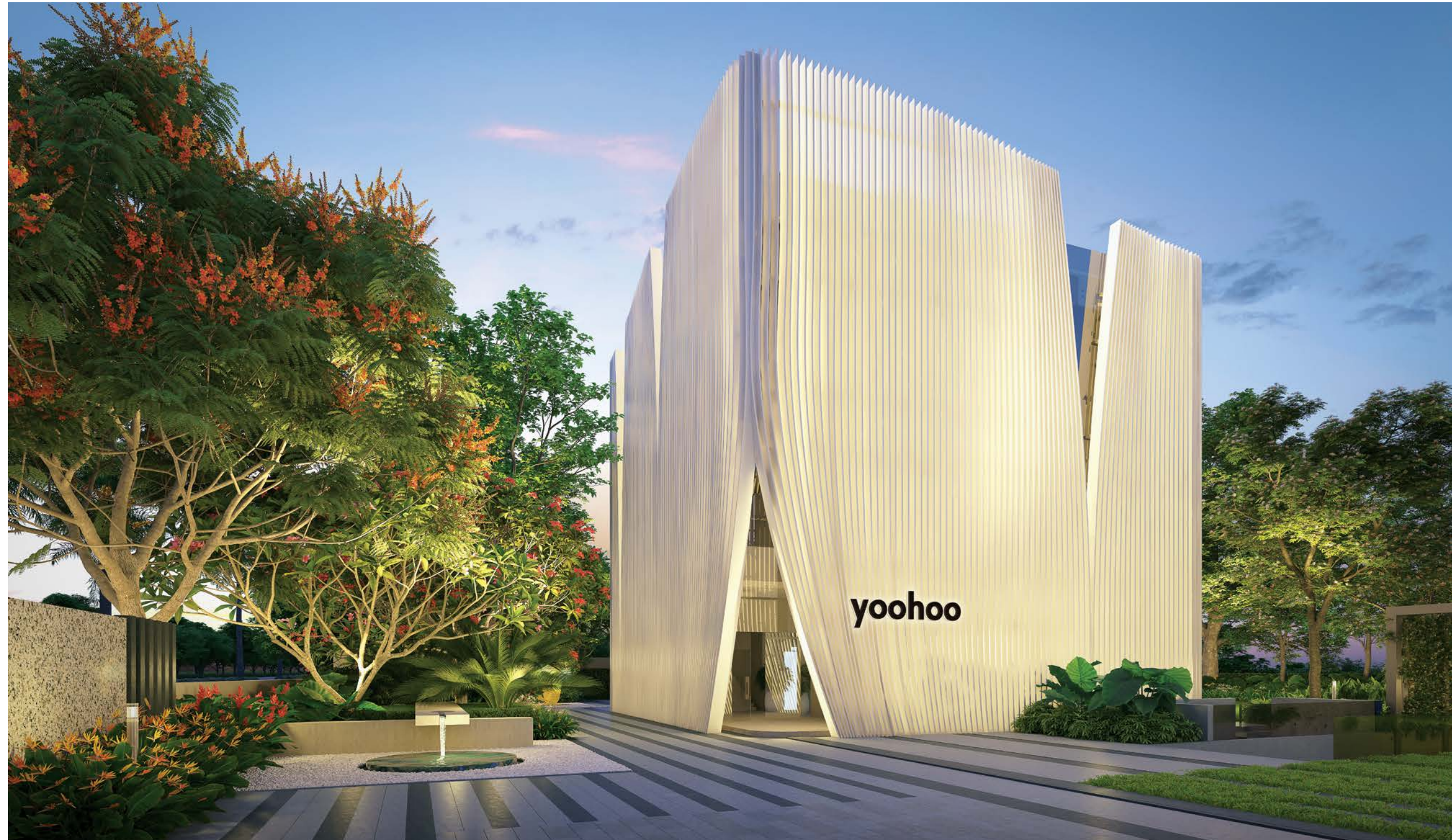

NIGHT TIME VIEW OF
THE CLUBHOUSE

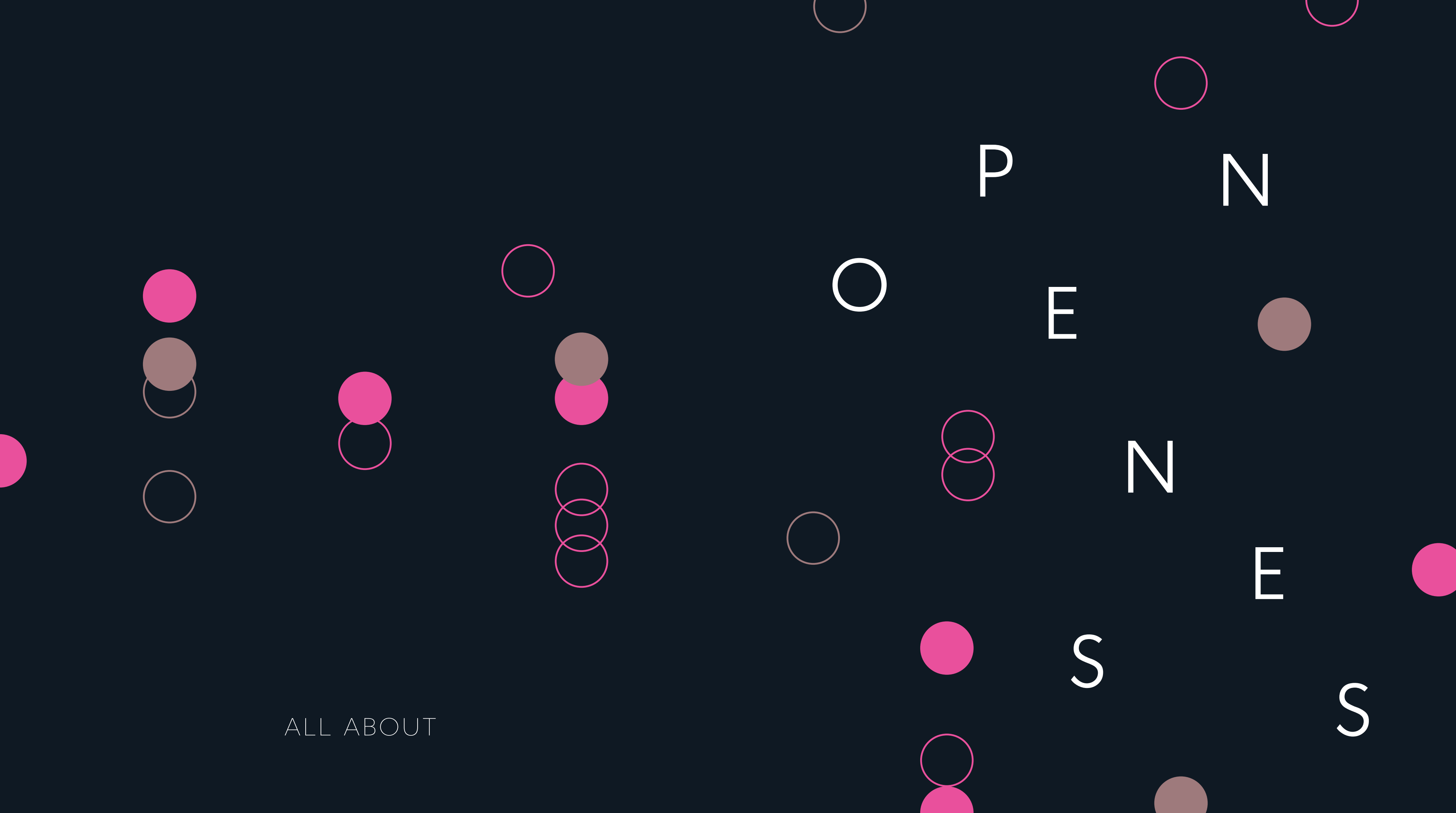

ALL ABOUT

P N

O

E

N

E

S

S

MULTIPURPOSE HALL | A space to spread your wings.

Celebrate the true spirit of community



The artfully designed multipurpose hall, in the ground floor of the sculptural Clubhouse, offers a social space for gatherings and entertaining, which opens into the landscape through the morphed vertical fins creating an emancipatory blend of experience, combining inside and outside.

Dance to let out the stress. Yoga for letting in the calmness

Hone your body and address your stress. In our Dance Room Cum Yoga Room that is engulfed with a 3-side view of panoramic landscapes. Unwind, destress and keep calm while engaging in a conversation with the fluid morphology of the façade.

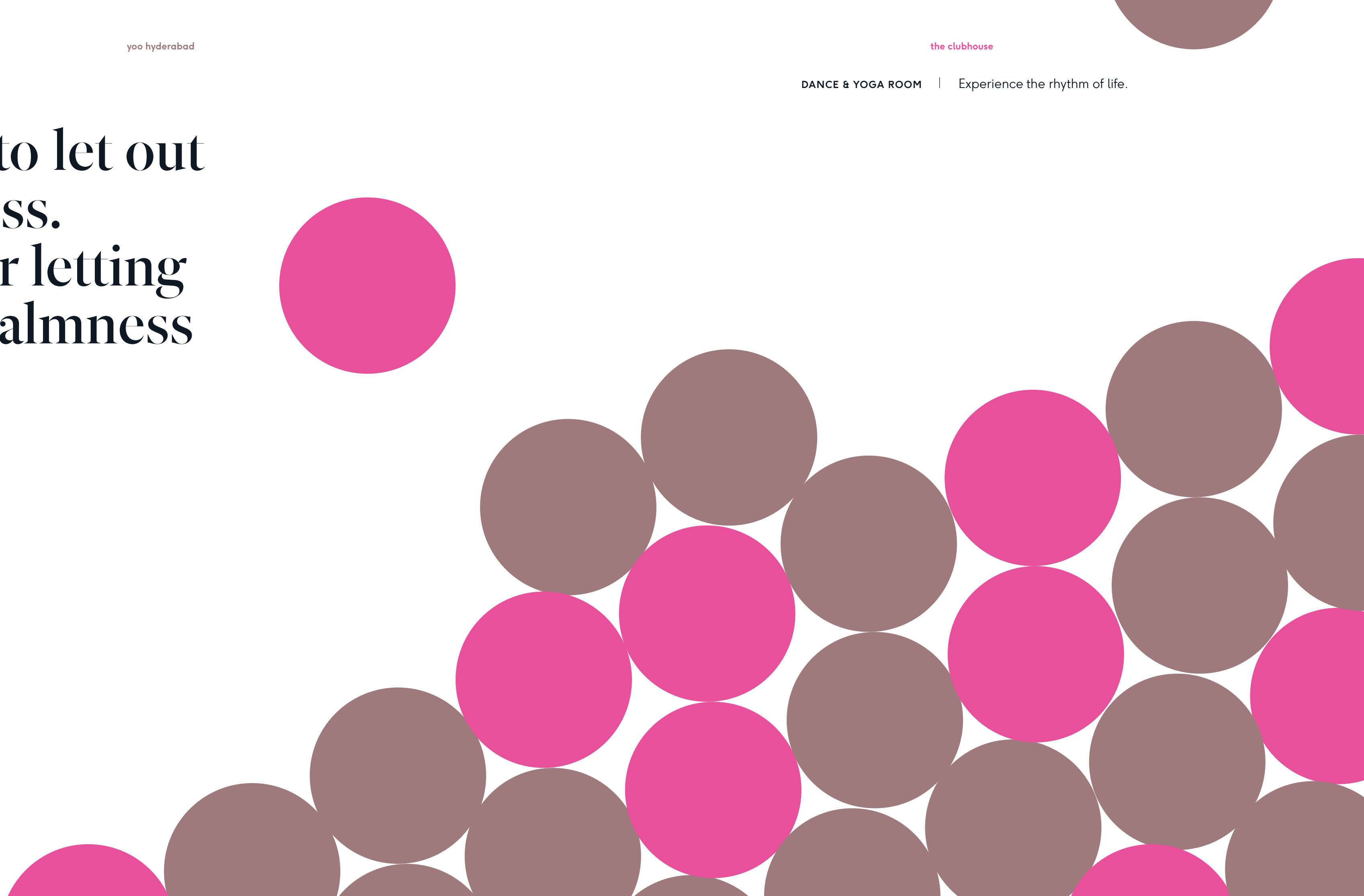

LAP POOL & DECK | Come, experience your own blue lagoon.

Dive into the blue

106 ●

Ease your way into glorious temperature-controlled waters, and wade to the edge of infinity. The horizons of our pools come to an end, only for your view of the world to begin.



INFINITY POOL OVERLOOKING THE CITY



Play your way to an active life

Indoor sports like, squash, badminton, table tennis and numerous other amenities to nourish and strengthen your body, mind and soul.

TABLE TENNIS WITH
A SEATING AREA

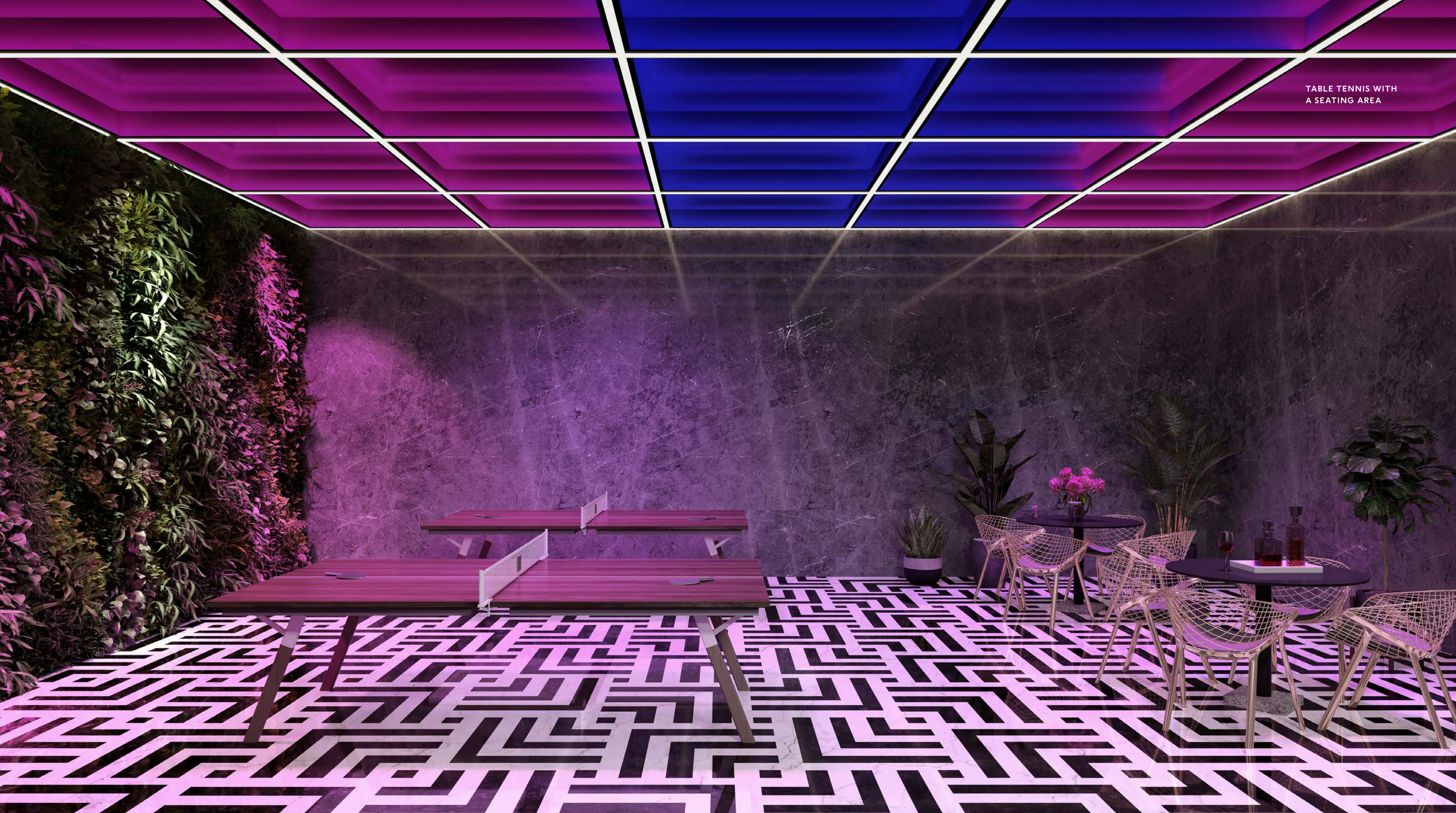



GRAND
PROMENADE



GRAND
ATRIUM



GRAND
LIFESTYLE

THE FUTURE SMILES WHEN A CHILD'S IMAGINATION IS TICKLED

114 ●

Nearby to the central reflection pool, a sculptural revelation awaits with a basketball court and well thought out play area. It helps in encouraging educational interactions, sparking the creativity in children, and exploring their limitless imagination. It is good to fuel their imagination. After all, they are the ones who are going to fuel tomorrow.



VIEW OF THE CHILDRENS' PLAY AREA



OUTDOOR TABLE
TENNIS AREA &
PUZZLE OF DREAMS



WE DON'T INTRUDE NATURE. WE INVITE THE NATURE TO EMBRACE US



Landscaping with the core concept of Immersing Nature.

The landscape design is based on the principles of Vastu Shastra, which is emphasised by water, clean lines, and a series of discrete gardens that wrap themselves around the tower. The idea is to let the greenery of the exterior effortlessly flow into the interiors. The surrounding planting is native accentuated by peached trees and palms. Orange flowering banyan trees blossom amongst scented jasmines and vibrant Birds

of Paradise while ambitious climbers adorn the Clubhouse entrance. Low box hedges in contrast to the shimmering colours provide a muted texture and sharp lines. As one enters, the sense of green calm persists with the interiors made serene with thoughtful planting. Refined materials allow the design to breath, interspersed with water, sculptures, foliage and various amenities.



GARDEN OF SERENITY

ROCK 'N' STROLL

Entertaining guests in the quaint outdoors isn't a problem. Just stroll through the elegant Rock Garden adorned with honed and leather finished granites, to the lawn. The working pods extend into this space from the interior, facilitating a unique outdoor working experience. Also, Clubhouse members can sit on the open lawn and enjoy curated musical performances on the stage as the sun sets.



SOMETIMES IT'S BLISS TO JUST SIT AND WATCH THE WORLD GO BY

PAVILLION OF MYSTERY

Quiet introspection floats up in the mind as one walks up the floating steps to the raised pavilion nearby, where grownups can sit, chat, reflect and generally enjoy their space. Here, sculptures stand against feature walls adjacent to banks of sensorial planting, creating a magical atmosphere.

The Floorplans



SITE PLAN

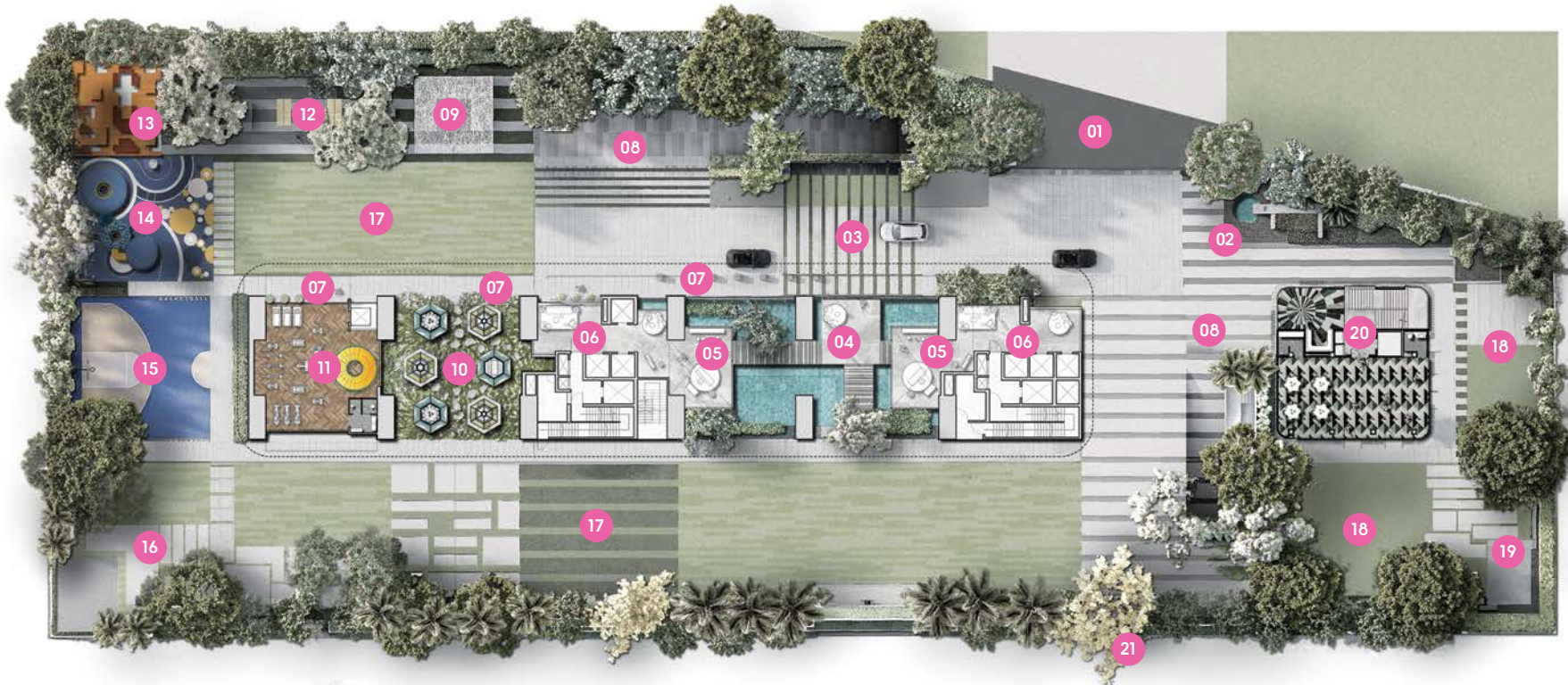

- | | | | | | |
|----|----------------------|----|-----------------------|----|------------------------|
| 01 | Entrance Plaza | 09 | Social Hub | 17 | The Garden of Serenity |
| 02 | The Fountain Of Life | 10 | Working Pods | 18 | The Leisure Meadow |
| 03 | Drop-Off Plaza | 11 | Gymnasium | 19 | Sequence of Dreams |
| 04 | The Island Portico | 12 | Outdoor Table Tennis | 20 | yoo hoo Clubhouse |
| 05 | Reception | 13 | Puzzles Of Dreams | 21 | Residential Entry Zone |
| 06 | Waiting/Lift Lobby | 14 | Child Play Domain | | |
| 07 | The Grand Promenade | 15 | Half Basketball Court | | |
| 08 | Basement Ramp | 16 | Pavilion of Mystery | | |

FIRST FLOOR

- 01 Passenger Lift
- 02 Business Center
- 03 Service Lift
- 04 Service Lobby
- 05 Informal Meeting Room
- 06 Formal Conference Room
- 07 Toilet
- 08 Gym
- 09 Glass Lift



TYPICAL EVEN FLOOR

- 01 Passenger Lift
- 02 Lobby
- 03 Service Lift
- 04 Service Lobby
- 05 DB Room
- 06 AC Ledge
- 07 West Block
- 08 East Block



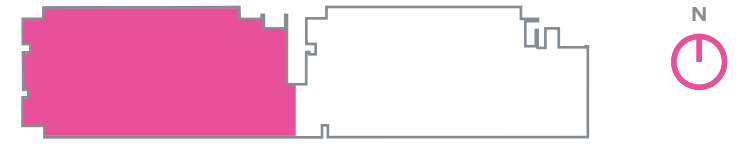

EVEN FLOOR WEST BLOCK

Floor Plate
8325
SQFT

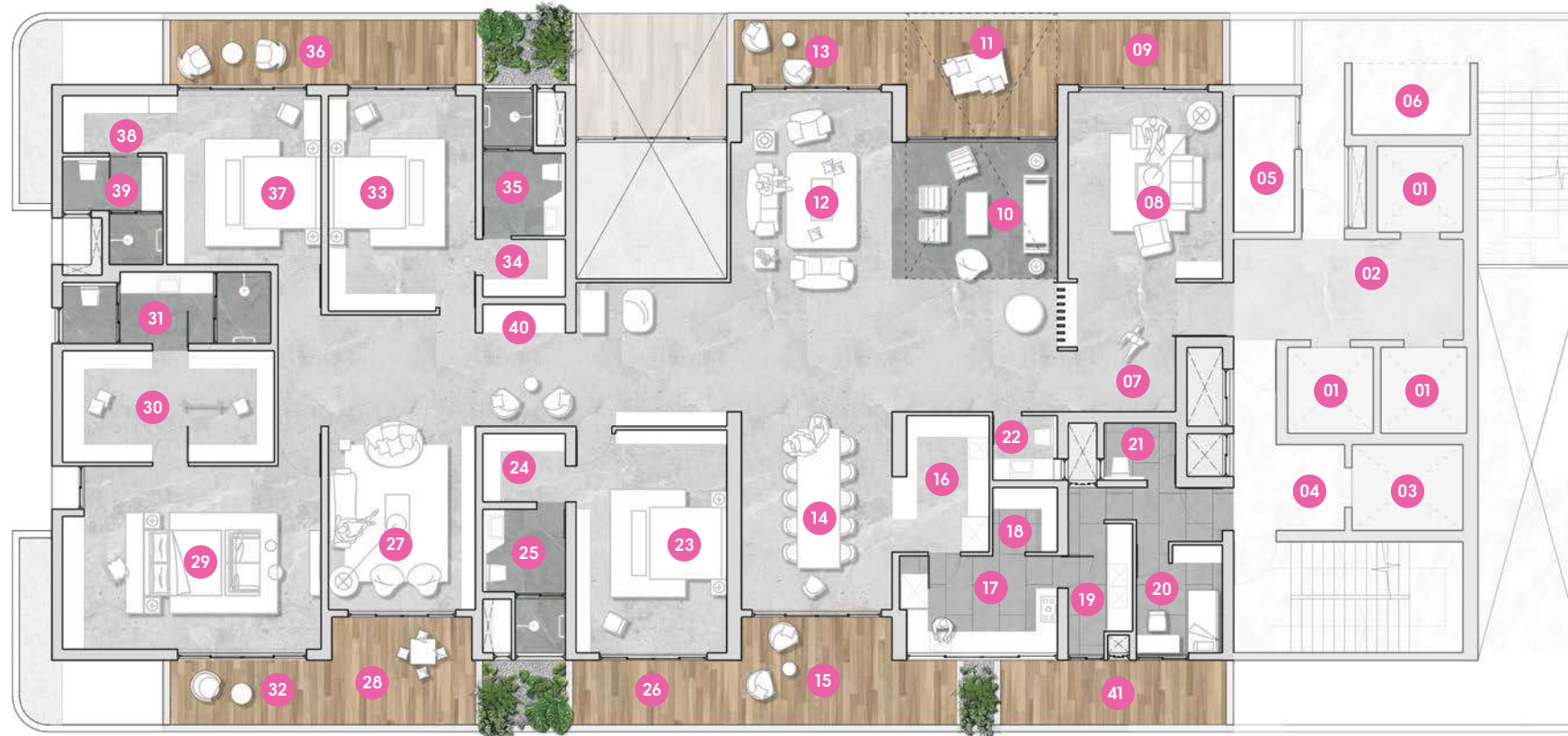

- | | | | | | |
|----|---|----|---|----|-----------------------------------|
| 01 | Passenger Lift
7'10" x 7'10" | 15 | Seating Deck
19'10" X 9'6" | 29 | Master Bedroom
23'2" x 16'5" |
| 02 | Lobby
21'4" x 9'2" | 16 | Dry Kitchen
8'8" x 12'10" | 30 | Walk-In Wardrobe
18'3" x 9'10" |
| 03 | Service Lift
10'2" x 7'10" | 17 | Wet Kitchen
13'3" x 8'6" | 31 | Bathroom
18'3" x 6'7" |
| 04 | Service Lobby
10'2" x 7'10" | 18 | Store Room
5'5" x 5'11" | 32 | Balcony
15'1" x 5'11" |
| 05 | DB Room
5'7" x 11'6" | 19 | Utility
5'10" x 15'1" | 33 | Bedroom
13'1" x 19'4" |
| 06 | AC Ledge
11'2" x 4'3" | 20 | Servant Room
7'7" x 9'10" | 34 | Walk-In Wardrobe
7'7" x 4'7" |
| 07 | Foyer
15'3" x 11'2" | 21 | Toilet
6'3" x 5'7" | 35 | Bathroom
7'7" x 12'6" |
| 08 | Formal Living
13'9" x 16'9" | 22 | Powder Room
5'7" x 6'3" | 36 | Balcony
27'11" x 5'11" |
| 09 | Balcony
15'1" x 5'11" | 23 | Guest Bedroom
13'3" x 20'0" | 37 | Bedroom
14'1" x 15'1" |
| 10 | Angan-
Casual Living
13'3" X 23'11" | 24 | Walk-In Wardrobe
7'7" x 5'11" | 38 | Walk-In Wardrobe
9'0" x 4'11" |
| 11 | Seating Deck
13'3" x 10'2" | 25 | Bathroom
7'7" x 12'6" | 39 | Bathroom
8'8" x 9'10" |
| 12 | Family Living
16'1" x 28'3" | 26 | Balcony
15'5" x 5'11" | 40 | Pooja
7'7" x 2'7" |
| 13 | Balcony
15'9" x 5'11" | 27 | Multipurpose
Family Living
13'1" x 26'11" | 41 | Utility Balcony
20'6" x 5'11" |
| 14 | Dining
13'9" X 18'8" | 28 | Seating Deck
12'10" x 9'6" | | |



EVEN FLOOR EAST BLOCK

Floor Plate
8325
SQFT



- | | | | | | |
|----|---------------------------------------|----|--|----|-----------------------------------|
| 01 | Passenger Lift
7'10" x 7'10" | 15 | Seating Deck
19'10" X 9'6" | 29 | Master Bedroom
23'2" x 16'5" |
| 02 | Lobby
21'4" x 9'2" | 16 | Dry Kitchen
8'8" x 12'10" | 30 | Walk-In Wardrobe
18'3" x 9'10" |
| 03 | Service Lift
10'2" x 7'10" | 17 | Wet Kitchen
13'3" x 8'6" | 31 | Bathroom
18'3" x 6'7" |
| 04 | Service Lobby
10'2" x 7'10" | 18 | Store Room
5'5" x 5'11" | 32 | Balcony
15'1" x 5'11" |
| 05 | DB Room
5'7" x 11'6" | 19 | Utility
5'10" x 15'1" | 33 | Bedroom
13'1" x 19'4" |
| 06 | AC Ledge
11'2" x 4'3" | 20 | Servant Room
7'7" x 9'10" | 34 | Walk-In Wardrobe
7'7" x 4'7" |
| 07 | Foyer
15'3" x 11'2" | 21 | Toilet
6'3" x 5'7" | 35 | Bathroom
7'7" x 12'6" |
| 08 | Formal Living
13'9" x 16'9" | 22 | Powder Room
5'7" x 6'3" | 36 | Balcony
27'11" x 5'11" |
| 09 | Balcony
15'1" x 5'11" | 23 | Guest Bedroom
13'3" x 20'0" | 37 | Bedroom
14'1" x 15'1" |
| 10 | Angan-Casual Living
13'3" X 25'11" | 24 | Walk-In Wardrobe
7'7" x 5'11" | 38 | Walk-In Wardrobe
9'0" x 4'11" |
| 11 | Seating Deck
13'3" x 10'2" | 25 | Bathroom
7'7" x 12'6" | 39 | Bathroom
8'8" x 9'10" |
| 12 | Family Living
16'1" x 28'3" | 26 | Balcony
15'5" x 5'11" | 40 | Pooja
7'7" x 2'7" |
| 13 | Balcony
15'9" x 5'11" | 27 | Multipurpose Family Living
13'1" x 26'11" | 41 | Utility Balcony
20'6" x 5'11" |
| 14 | Dining
13'9" X 18'8" | 28 | Seating Deck
12'10" x 9'6" | | |

TYPICAL ODD FLOOR

- 01 Passenger Lift
- 02 Lobby
- 03 Service Lift
- 04 Service Lobby
- 05 DB Room
- 06 AC Ledge
- 07 West Block
- 08 East Block



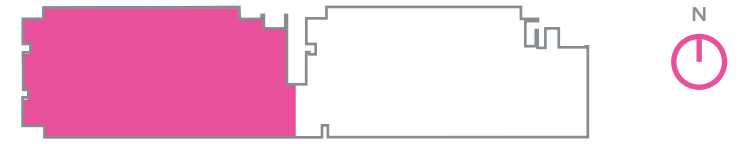

ODD FLOOR WEST BLOCK

Floor Plate
8325
SQFT

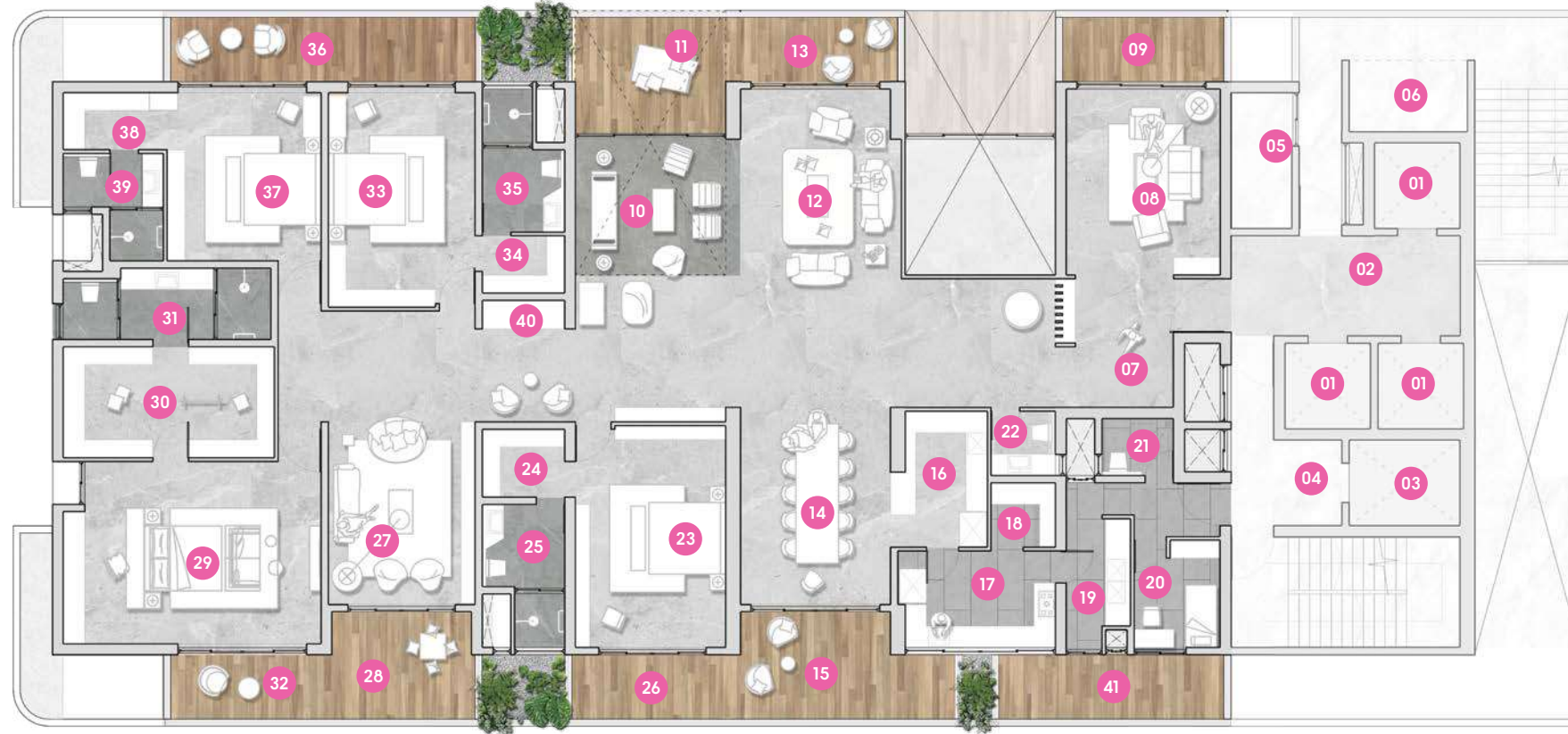

- | | | |
|---|--|---|
| 01 Passenger Lift
7'10" x 7'10" | 15 Seating Deck
19'10" X 9'6" | 29 Master Bedroom
23'2" x 16'5" |
| 02 Lobby
21'4" x 9'2" | 16 Dry Kitchen
8'8" x 12'10" | 30 Walk-In Wardrobe
18'3" x 9'10" |
| 03 Service Lift
10'2" x 7'10" | 17 Wet Kitchen
13'3" x 8'6" | 31 Bathroom
18'3" x 6'7" |
| 04 Service Lobby
10'2" x 7'10" | 18 Store Room
5'5" x 5'11" | 32 Balcony
15'1" x 5'11" |
| 05 DB Room
5'7" x 11'6" | 19 Utility
5'10" x 15'1" | 33 Bedroom
13'1" x 19'4" |
| 06 AC Ledge
11'2" x 4'3" | 20 Servant Room
7'7" x 9'10" | 34 Walk-In Wardrobe
7'7" x 4'7" |
| 07 Foyer
15'3" x 11'2" | 21 Toilet
6'3" x 5'7" | 35 Bathroom
7'7" x 12'6" |
| 08 Formal Living
13'9" x 16'9" | 22 Powder Room
5'7" x 6'3" | 36 Balcony
27'11" x 5'11" |
| 09 Balcony
15'1" x 5'11" | 23 Guest Bedroom
13'3" x 20'0" | 37 Bedroom
14'1" x 15'1" |
| 10 Angan-Casual Living
13'3" X 25'11" | 24 Walk-In Wardrobe
7'7" x 5'11" | 38 Walk-In Wardrobe
9'0" x 4'11" |
| 11 Seating Deck
13'3" x 10'2" | 25 Bathroom
7'7" x 12'6" | 39 Bathroom
8'8" x 9'10" |
| 12 Family Living
16'1" x 28'3" | 26 Balcony
15'5" x 5'11" | 40 Pooja
7'7" x 2'7" |
| 13 Balcony
15'9" x 5'11" | 27 Multipurpose Family Living
13'1" x 26'11" | 41 Utility Balcony
20'6" x 5'11" |
| 14 Dining
13'9" X 18'8" | 28 Seating Deck
12'10" x 9'6" | |



ODD FLOOR EAST BLOCK

Floor Plate
8325
SQFT



- | | | | | | |
|----|---------------------------------------|----|--|----|-----------------------------------|
| 01 | Passenger Lift
7'10" x 7'10" | 15 | Seating Deck
19'10" X 9'6" | 29 | Master Bedroom
23'2" x 16'5" |
| 02 | Lobby
21'4" x 9'2" | 16 | Dry Kitchen
8'8" x 12'10" | 30 | Walk-In Wardrobe
18'3" x 9'10" |
| 03 | Service Lift
10'2" x 7'10" | 17 | Wet Kitchen
13'3" x 8'6" | 31 | Bathroom
18'3" x 6'7" |
| 04 | Service Lobby
10'2" x 7'10" | 18 | Store Room
5'5" x 5'11" | 32 | Balcony
15'1" x 5'11" |
| 05 | DB Room
5'7" x 11'6" | 19 | Utility
5'10" x 15'1" | 33 | Bedroom
13'1" x 19'4" |
| 06 | AC Ledge
11'2" x 4'3" | 20 | Servant Room
7'7" x 9'10" | 34 | Walk-In Wardrobe
7'7" x 4'7" |
| 07 | Foyer
15'3" x 11'2" | 21 | Toilet
6'3" x 5'7" | 35 | Bathroom
7'7" x 12'6" |
| 08 | Formal Living
13'9" x 16'9" | 22 | Powder Room
5'7" x 6'3" | 36 | Balcony
27'11" x 5'11" |
| 09 | Balcony
15'1" x 5'11" | 23 | Guest Bedroom
13'3" x 20'0" | 37 | Bedroom
14'1" x 15'1" |
| 10 | Angan-Casual Living
13'3" X 23'11" | 24 | Walk-In Wardrobe
7'7" x 5'11" | 38 | Walk-In Wardrobe
9'0" x 4'11" |
| 11 | Seating Deck
13'3" x 10'2" | 25 | Bathroom
7'7" x 12'6" | 39 | Bathroom
8'8" x 9'10" |
| 12 | Family Living
16'1" x 28'3" | 26 | Balcony
15'5" x 5'11" | 40 | Pooja
7'7" x 2'7" |
| 13 | Balcony
15'9" x 5'11" | 27 | Multipurpose Family Living
13'1" x 26'11" | 41 | Utility Balcony
20'6" x 5'11" |
| 14 | Dining
13'9" X 18'8" | 28 | Seating Deck
12'10" x 9'6" | | |



31ST FLOOR SKY LOUNGE

142 ●

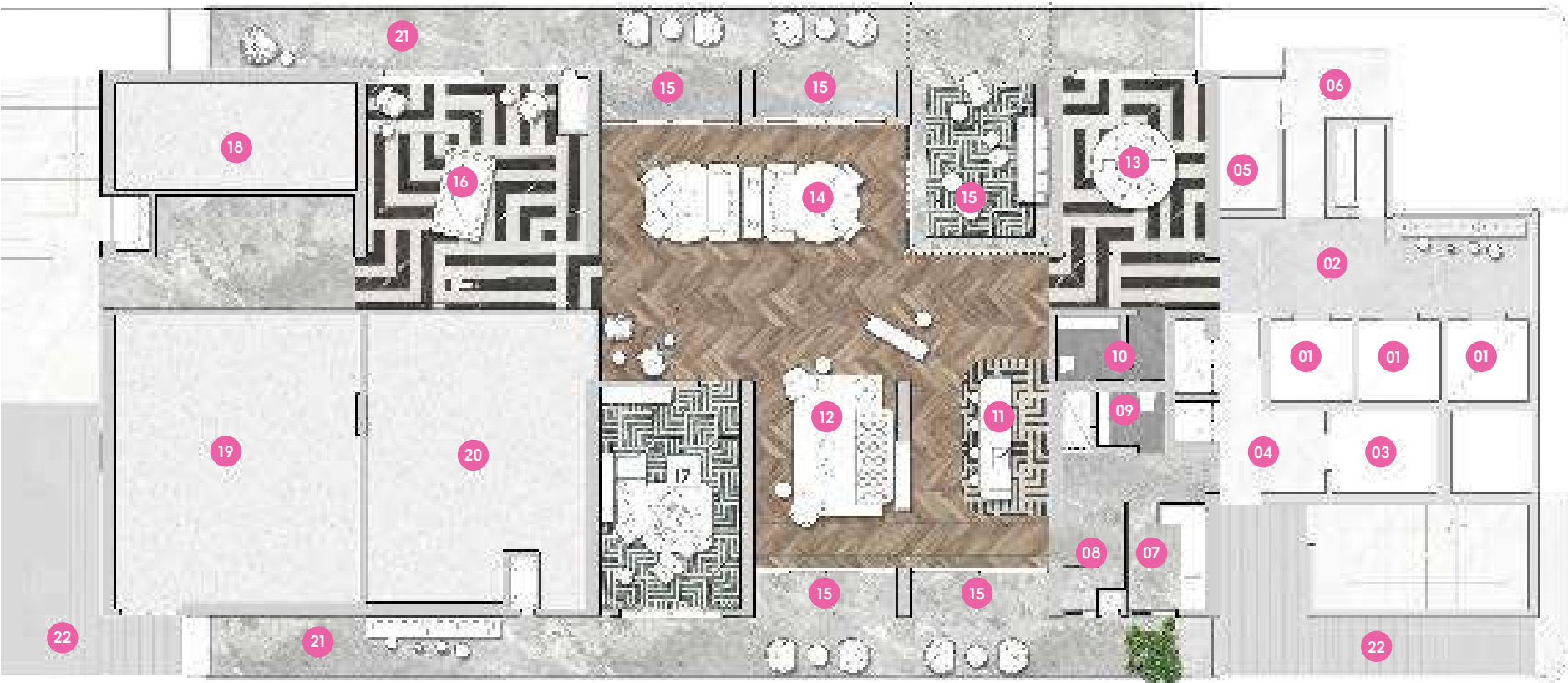

- 01 Passenger Lift
- 02 Lobby
- 03 Service Lift
- 04 Service Lobby
- 05 DB Room
- 06 AC Ledge
- 07 Utility
- 08 Pantry
- 09 Toilet
- 10 Powder Room
- 11 Bar
- 12 Bar Lounge
- 13 Cards Room
- 14 Lounge
- 15 Outdoor Lounge
- 16 Billiards
- 17 Cigar Lounge
- 18 Services
- 19 Tank
- 20 Pump Room
- 21 Deck
- 22 Refuge Area

SPECIFICATIONS

STRUCTURE

RCC framed structure with RC walls.

FLOORING & DADO

Drawing room, Living room, Dining room, All Bedrooms, Toilets – **Marble flooring**

Kitchen; Balconies – **Anti-skid vitrified tiles**

TOILETS

Sanitary ware – Villeroy & Boch or equivalent.

Faucets – Villeroy & Boch or equivalent.

DOORS & WINDOWS

Doors – Engineered wood/ Hardwood frame with veneered flush shutter, finished with melamine polish and reputed hardware.

Windows & French doors – Powder coated aluminum frame with double glazed glass and mosquito mesh.

PAINT

External – Two coats of acrylic exterior emulsion paint with texture finish as per approved design.

Internal – Two coats of acrylic emulsion paint over smooth putty finish.

GENERATOR

100% DG set backup with acoustic enclosure & AMF Panel for all flats and common areas.

SECURITY

Sophisticated round the clock security system.

Surveillance cameras at the main security gate, passenger lifts and children's play area.

Boom barriers at entry for vehicles with mechanical operation.

LPG

Provision for supply of gas from centralized gas bank to kitchen with individual gas meters.

BMS

Building management software for gas bank, generator power, general power connection and water meters

WASTE MANAGEMENT

Garbage collection will be provided for every apartment for better disposal.

KITCHEN & UTILITY

Power plug for cooking range chimney, refrigerator, microwave ovens, etc in dry kitchen.

Modular Wet kitchen with chimney and stove. All other appliances in clients scope.

Granite counter for utility area with stainless steel sink.

ELECTRICAL

Concealed copper wiring of Finolex or equivalent make (Ceiling wiring not included).

Modular switches of reputed make.

TELEPHONE & NETWORK

DTH provision in all bedrooms and living areas.

Intercom Provision within the unit.

Telephone points in all bedrooms, living room, and drawing room.

Standalone video door phone of reputed make.

LIFTS

High speed automatic Mitsubishi (or equivalent) passenger and service elevators

WTP & STP

Fully treated water made available (in case of bore well water) through exclusive water softening and purification plant; Sewage treatment plant of adequate capacity as per norms will be provided inside the project.

Treated sewage water will be used for landscaping and flushing purpose.

LANDSCAPING & WATER BODIES

Landscaping and water bodies in the setback areas wherever feasible, and in Tot-lot areas as per design of landscape consultant

WATER SUPPLY & METERING

Water Supply & Metering Pneumatic pumps will be used for supply of treated water to individual flats.

Individual water meters will be provided for each apartment.

CREDITS

Architects
CNT Architects, Bangalore

Structural Consultant
Innotech Engineering Consult Pvt Ltd

MEP Consultant
Synergy Infra Consultants

Landscape Consultants
Cracknell Limited, London

Trot the globe and come home to the best.

YOO Hyderabad. It stands tall. It stands proud. It stands for an unprecedented curated lifestyle. The enormous height and thin width of the tower position it as a sleek memorable attraction that forms an icon in the city skyline. Closer to the ground, the 12m high ceiling in the ground floor ensures uninterrupted view across the site to create an ambiance of generous landscape. The elevation derives from the alternate double height volumes of the Aangan within each apartment. Linear horizontal stripes of playfully varied thickness have been incorporated to break up the monotonous vertical massing, and highlight the double height volumes.

THE HEIGHT OF LUXURY

On the Deccan Plateau along the banks of the Musi River, Hyderabad is the capital and the largest city of the state of Telangana. A treasure-trove of heritage and culture, reminiscent of the Nizam era, Hyderabad is also known for its abundant vibrancy, energy and progressive outlook. The city has many feathers in its cap. Until the 19th century, Hyderabad was

renowned for its pearl industry and christened the 'City of Pearls', and was the world's only Golconda Diamonds trading centre. Charminar, the famous monument, of course, is synonymous with Hyderabad. Its cuisine that is relished by millions has helped the city to be listed as a UNESCO creative city of gastronomy. Not to mention, the Telugu Film Industry based here which

is the country's second largest. The city has emerged as an Indian hub of pharmaceuticals and biotechnology, besides the IT revolution that has encouraged many multinationals to set up operations here. YOO Hyderabad captures the essence of this unique city in more ways than one.

HYDERABAD

LIVE
THE
HIGH
LIFE



Designed by www.nh1design.com

yoohyderabad
by myscape

www.myscape.in | info@myscape.in | 77118 82999