



*Projects that made us proud*

*Completed Projects*

**Open Plots layout Approved by HMDA**

- Silent Wald (250 Acres at Shamirpet)
- Vesta Homes (40 Acres at Shamirpet)
- Uptown & Uptown Heights (40 Acres at Thimmaipally Village)
- Uptown New City (30 Acres at Maheswaram-Shamshabad)
- Oorjita Hill Creek (20 Acres at Pudur Village)
- Oorjita Hill View (20 Acres at Thimmaipally Village)
- Radha Regal Rows - Gated Independent 32 Luxury Villas at Yapral
- Oorjita Grand Vie - 72 Villas at Kompally

*Ongoing Projects*

- Oorjita Grand Vie II - 152 Villas at Kompally
- Oorjita's Istana - 120 Villas - at Manchirevula, Gandipet

Promoter :



6/A, Ground Floor, P&T Colony, Karkhana, Secunderabad- 500 029  
 Phone: 040-2781 8999, 040-2781 4038  
 Mob: 98490 20210, 99664 98446, 96030 03399  
 email : goldenleaf@oorjitabuilders.com  
 www.oorjitagoldenleaf.com

*A Joint Venture with*  
**Indiareit & SSPDL**



*The real joy and beauty of living!*



*Life in a concrete jungle is existing not living!*

Imagine leaving all that behind and moving to Oorjita's Golden Leaf. Where you are greeted by the fresh, cool breeze whistling through the trees and birds singing without a care!

Where peace and serenity are not mere words but part of you. Catch a glimpse of the stars in the clear night sky. Tango in the moonlight. Unlimited possibilities to commune with nature.

*Plots that please*

Oorjita's Golden Leaf built across 42 acres, offers you plots in the scenic locales of Gundlapochampally. Different sizes are available to suit your needs. These are strategically located and easily accessible through multiple routes. Invest today and you have a valuable investment that appreciates rapidly.

*A lively location.*

The location Gundlapochampally is away from the rush yet has easy access to amenities. It lies just 20 minutes drive from the heart of the city. Access is through sophisticated multi-lane roads and this abuts the NH 7 - (NH 44) Medchal Road.

*Never a dull moment.*

The scope for entertainment is virtually unlimited! Full-fledged entertainment and shopping zones like Dhola-ri-Dhani ethnic Rajasthani village, Runway - 9, Cine Planet Multiplex and more to pick from. There are numerous restaurants serving a wide variety of cuisines in and around the place.

*Easy access to quality education.*

You will find world class schools and colleges close by like DRS International School, Siva Sivani Public School, Loyola Academy and many engineering colleges.

*Backed by expertise.*

Oorjita's Golden Leaf is backed by promoters who know the industry like the palm of their hand. We have built a formidable reputation for quality over the past two decades. We hold the trust of thousands of customers who know that an investment in an Oorjita Project is not just value for money but a surefire way to experience appreciation of investment. .



*The real joy and beauty of living!*

OORJITA'S  
**Golden Leaf**







Location Map (Not to Scale)



*Customer-centric approach*

Every project has been designed with our customers at its heart. They will vouch for our professionalism, integrity and efficient delivery. Isn't it time you joined the Oorjita family?

*Location Features*

- Just 18 kms. from the heart of the City.
- Abutting the NH 7 (NH 44) - Medchal Road.
- Smooth multi-lane roads, MMTS Railway Station.
- Plush residential developments.
- Big Bazaar.
- Dhola-ri-Dhani ethnic Rajasthani village
- Runway - 9
- Cine Planet Multiplex
- World-class international schools & colleges :  
DRS International School, Siva Sivani Public School  
Loyala Academy and a number of engineering colleges.
- Near ORR, Multiple access points making for a fast and easy commute.

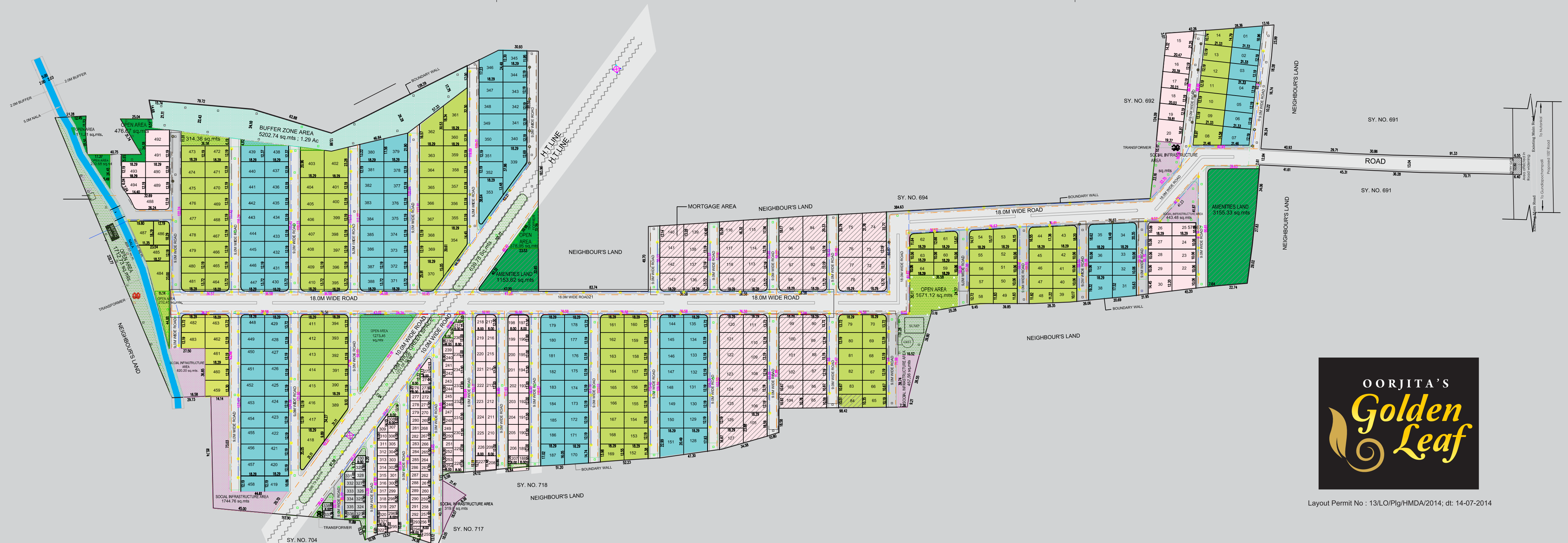

Layout Permit No : 13/LO/Plg/HMDA/2014; dt: 14-07-2014