

Developers :
Aditya Realty

Site Address: "**PARAM SOLITAIRE**",
Near Roshni Computer,
Opp. Water Tank Road, Karelibaug
Vadodara-390018.

Call: **+91 94267 09584**
Email: paramsolitaire@gmail.com

Architect:



Structure:

A. SHOK SHAH & ASSOCIATES

Above project is registred under Gujrera.Rera Reg. No.: PR/GJ/VADODARA/VADODARA/Others/
For futher details visit: www.gujrera.gujarat.gov.in under registered project. /



 **LAYOUT PLAN**

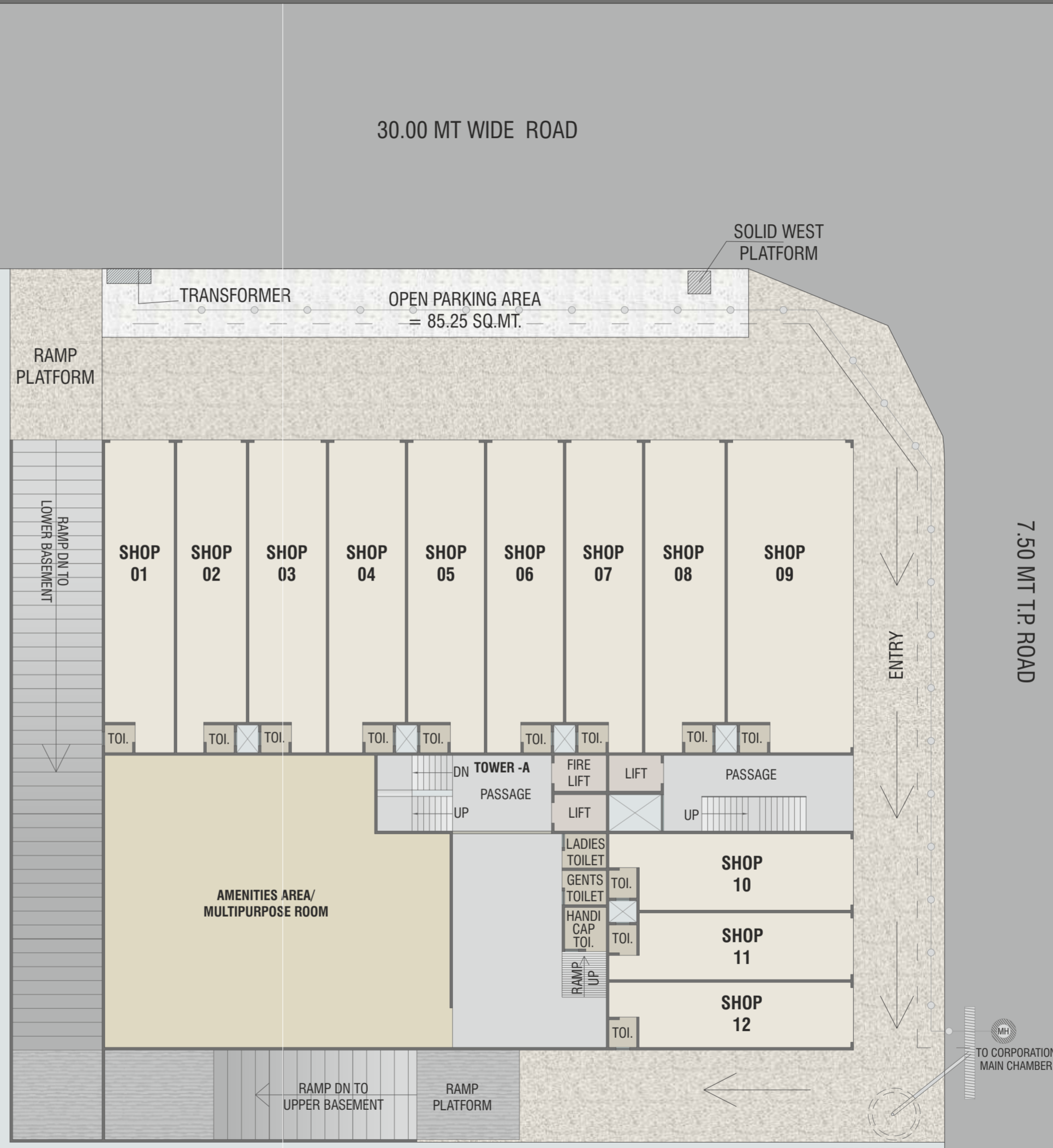

RAIN WATER HARVESTING PIT

TO CORPORATION MAIN CHAMBER



LOWER BASEMENT PLAN

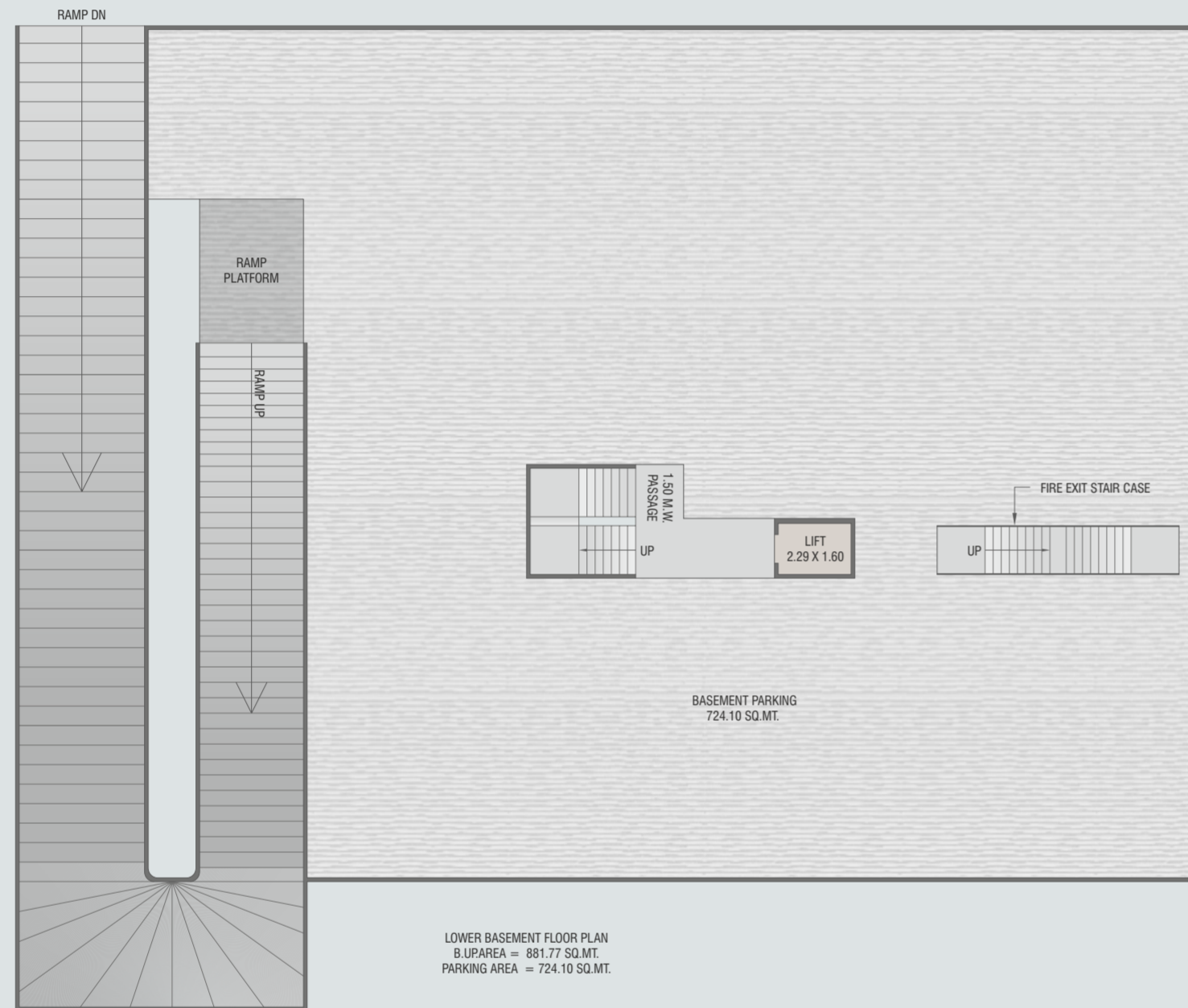

LOWER BASEMENT FLOOR PLAN
 B UPAREA = 881.77 SQ.MT.
 PARKING AREA = 724.10 SQ.MT.



UPPER BASEMENT PLAN

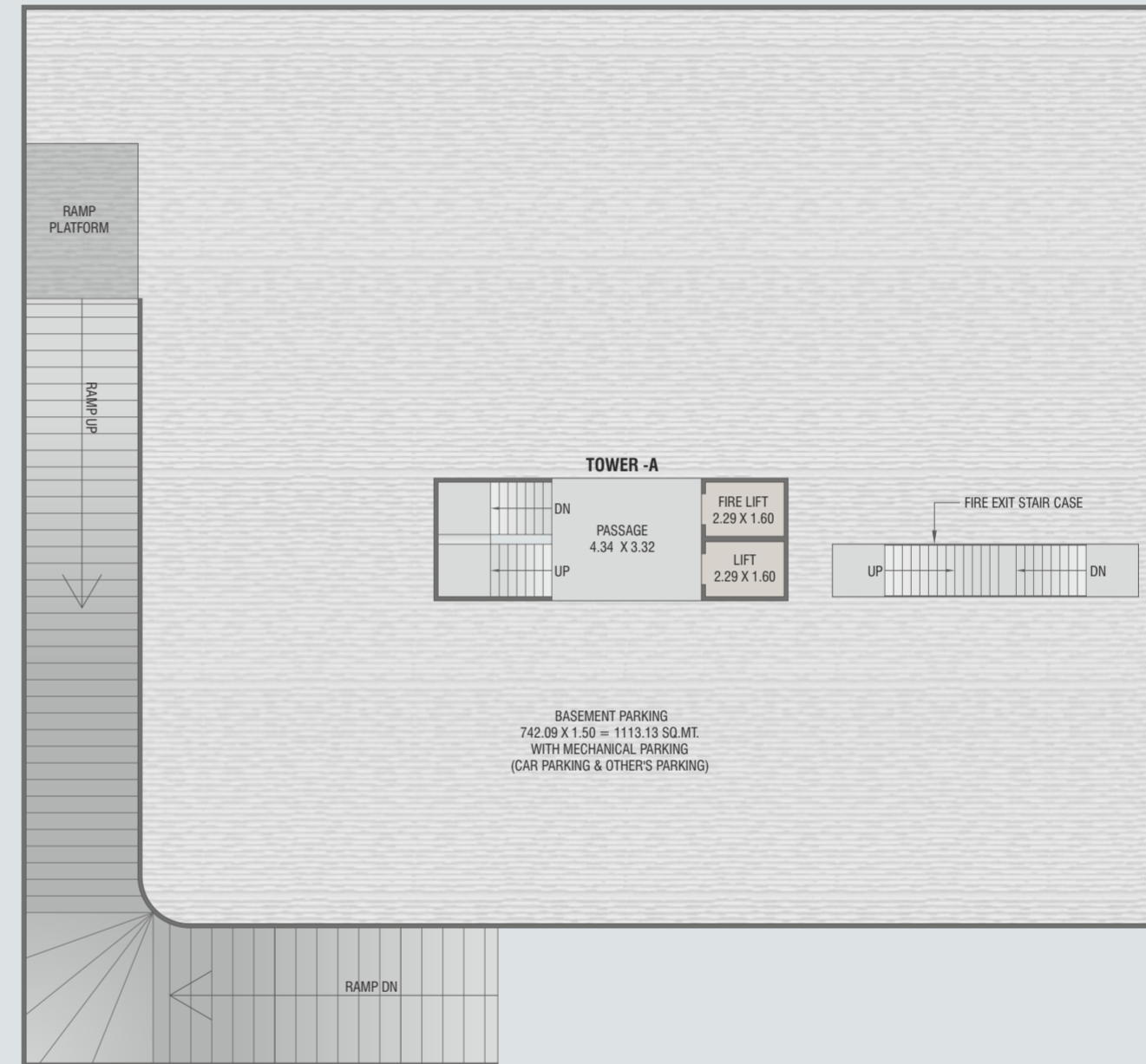



GROUND FLOOR PLAN

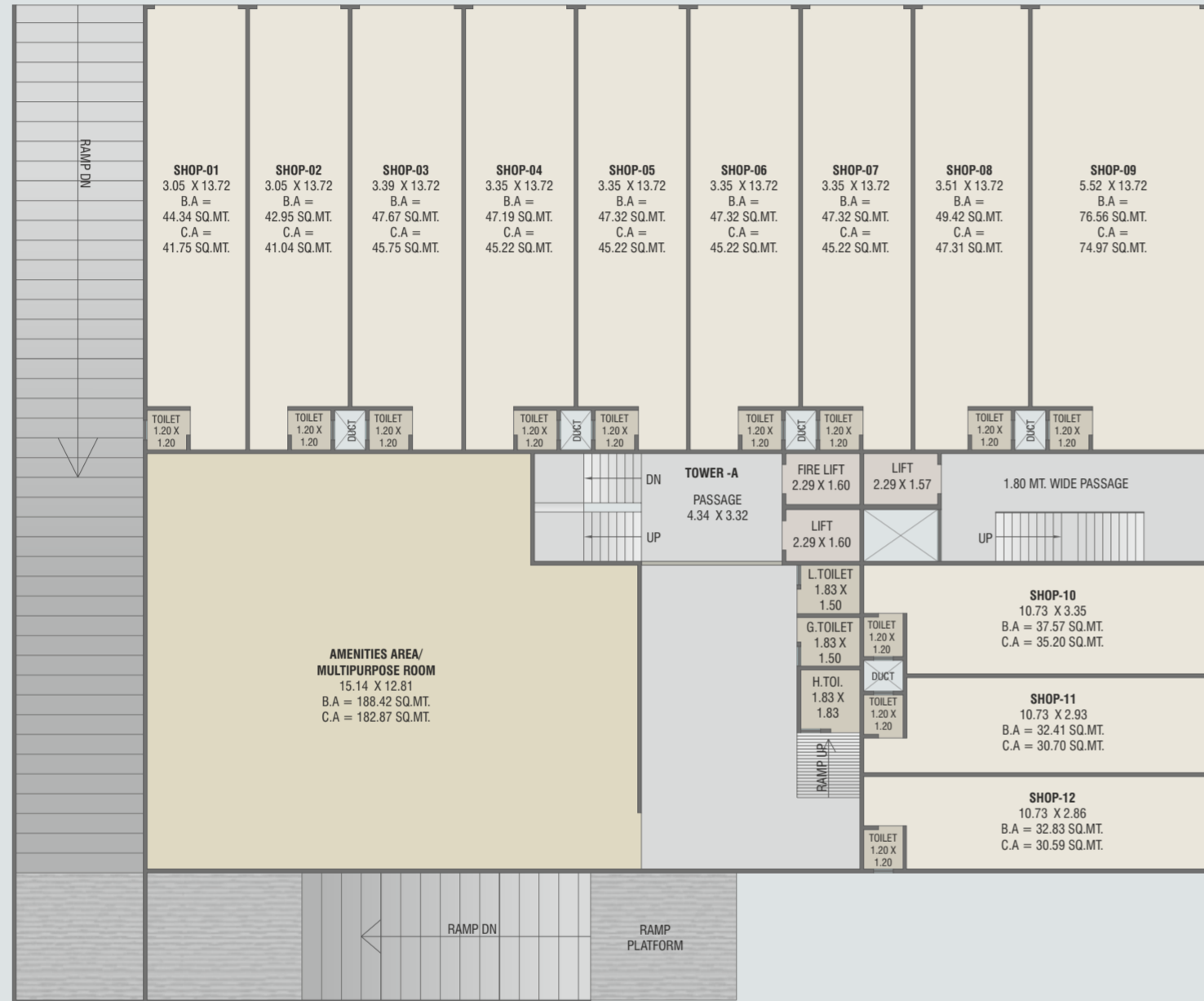

1st & 2nd FLOOR PLAN

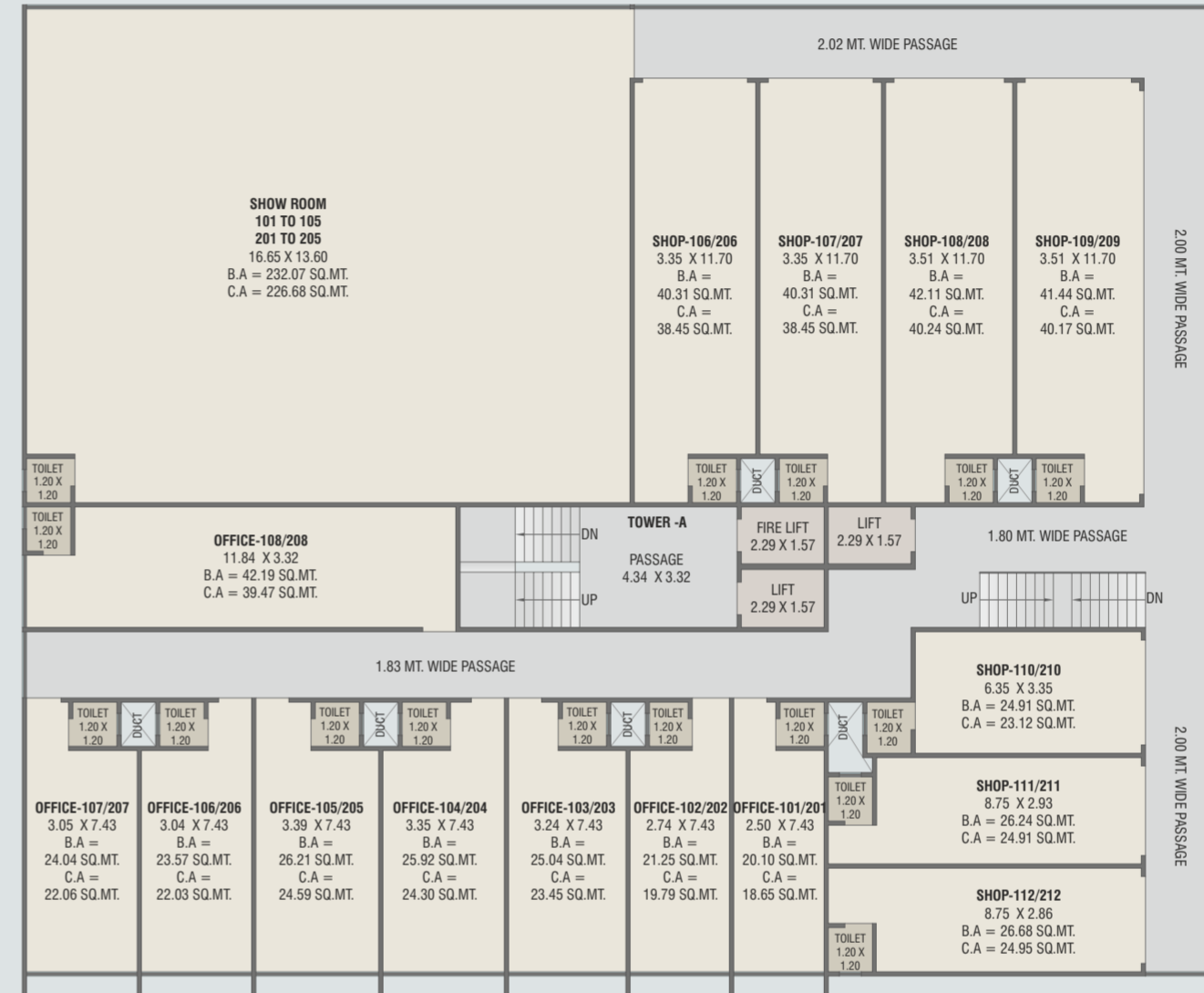



TYPICAL FLOOR PLAN (3rd to 7th Floor)



10

11





SPECIFICATION

For Residential

STRUCTURE

- All RCC & Brick masonry as per structural engineer's design.
- Earthquake resistant RCC framed structure design, Internal & External masonry work with brick.

PAINT

- White Putty for interior wall, color weather proof paint for exteriors.

FLOORING

- Vitrified tiles flooring in all rooms.

DOORS

- Decorative main door with standard fittings, all internal doors good quality laminated doors.

WINDOWS

- Aluminum section windows with tinted glass, safety grill & mosquito net.

KITCHEN

- Granite kitchen platform with S.S. sink & Glazed tiles dedo up to slab level.

PLUMBING

- U-PVC plumbing with good quality fittings

BATHROOM

- Designer Ceramic tiles & Premium bath fittings and Premium sanitary wares.

ELECTRIFICATION

- Concealed copper wiring of approved quality with good quality switches sufficient electrical points as per Architect's plan. AC points in all bed room & living room.

WATER

- Underground and overhead tank (with automated sensors) 24 hours water supply

For Commercial

Flooring

- Vitrified tile flooring with skirting in all units.
- Decorative flooring in common area.

Electrification

- Sufficient electric point with concealed wiring along with modular switches of good quality with AC point in each unit.
- Provision for water & drainage available in showrooms

