

LOCATION MAP



MOHAN RAO (MR)
Constructions Private Limited

JNR Complex, 3rd Floor, Chandra Mouli Nagar,
 Opp. Don Bosco Shool, Guntur- 522007

Consulting by :



DESIGN ARCHITECTS
 E-mail : csdesignarchitects@gmail.com
 GUNTUR & HYDERABAD
 Ph : 90143 45020 & 94417 77181

RM GRAPHICS - 96464 43006

Note : This Brochure is only a conceptual presentation of the project and not a legal offering. Developers reserve the right to change, alter, modify plan, elevation and specification time to time as deemed fit.



MOHAN RAO (MR)
 Constructions Private Limited

RADHA KRISHNA TOWERS

A Gated Community Venture @ LAM

In Association with **UV INFRA**



RADHA BLOCK

KRISHNA BLOCK

RADHA KRISHNA
TOWERS



Flat No.	Type	Facing	Area
101	3 BHK	East	1690
102	3 BHK	East	1690
103	3 BHK	East	1690
104	2 BHK	East	1258
105	2 BHK	West	1258
106	2 BHK	East	1258
107	2 BHK	East	1280
108	2 BHK	East	1258
109	2 BHK	West	1258
110	2 BHK	East	1280
111	2 BHK	East	1258
112	2 BHK	East	1258
113	2 BHK	West	1258
114	2 BHK	East	1305
115	2 BHK	East	1280

* Areas in Square Feet

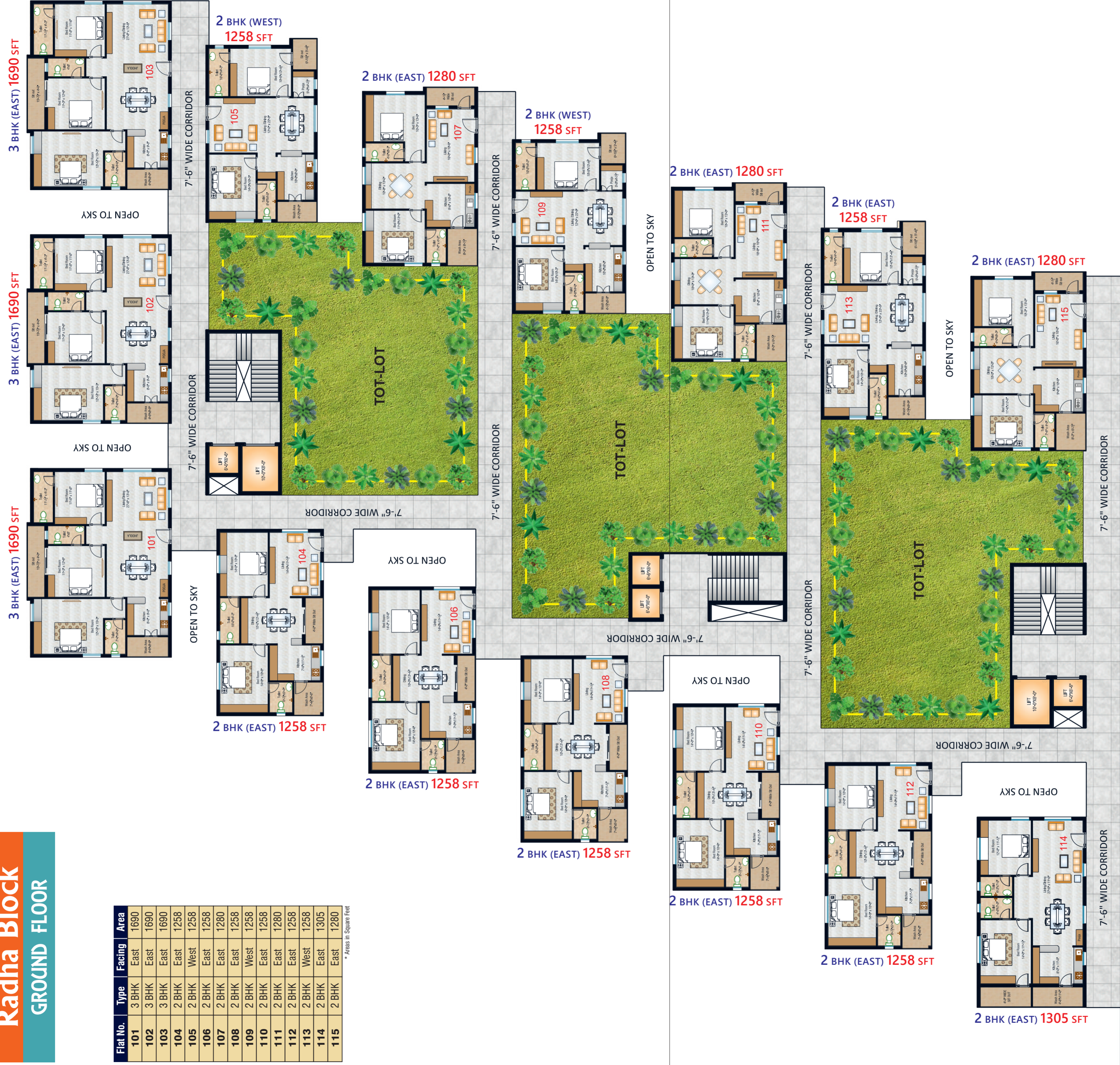

GROUND FLOOR
COMMERCIAL

1st & 2nd FLOORS
AMENITIES

COMMERCIAL & AMENITIES BLOCK

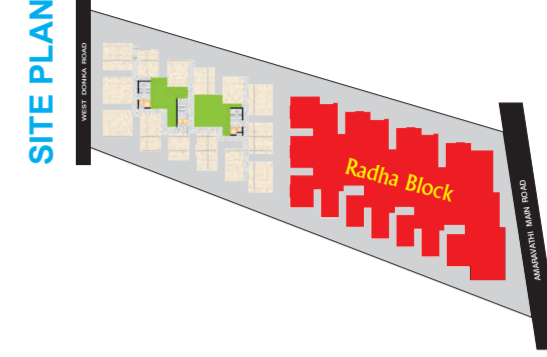



RADHA KRISHNA
TOWERS
Krishna Block
GROUND FLOOR

Flat No.	Type	Facing	Area
101	3 BHK	East	1730
102	3 BHK	East	1730
103	3 BHK	East	1730
104	3 BHK	East	1695
105	2 BHK	West	1258
106	2 BHK	North	1240
107	3 BHK	East	1695
108	2 BHK	West	1258
109	2 BHK	East	1320
110	2 BHK	East	1258
111	3 BHK	West	1675
112	3 BHK	West	1675
113	3 BHK	West	1675
114	3 BHK	West	1675

* Areas in Square Feet

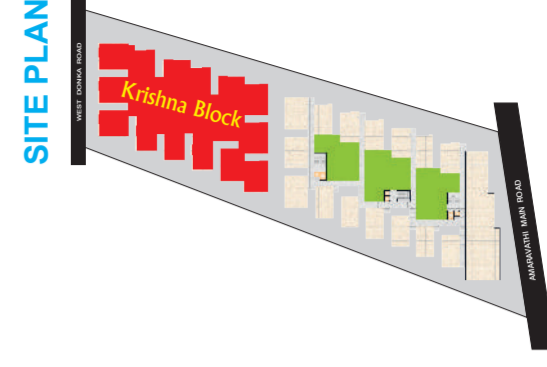



First & Second Floors

Flat No.	Type	Facing	Area
201, 202 & 301, 302	3 BHK	East	1690
203 & 303	3 BHK	East	1783
204, 206, 208, 210, 212	2 BHK	East	1258
304, 306, 308, 310, 312	2 BHK	East	1305
205, 209, 213	2 BHK	West	1305
305, 309, 313	2 BHK	East	1330
207, 211, 214, 215	2 BHK	East	1330
307, 311, 314, 315	2 BHK	East	1330

* Areas in Square Feet

Typical Floor

Flat No.	Type	Facing	Area
401 - 901	3 BHK	East	1690
402 - 902	3 BHK	East	1690
403 - 903	3 BHK	East	1783
404 - 904	2 BHK	East	1258
405 - 905	2 BHK	West	1305
406 - 906	2 BHK	East	1258
407 - 907	2 BHK	East	1330
408 - 908	2 BHK	East	1258
409 - 909	2 BHK	West	1305
410 - 910	2 BHK	East	1258
411 - 911	2 BHK	East	1330
412 - 912	2 BHK	East	1258
413 - 913	2 BHK	West	1305
414 - 914	2 BHK	East	1305
415 - 915	2 BHK	East	1330
416 - 916	3 BHK	West	1965
417 - 917	3 BHK	West	1965
418 - 918	3 BHK	West	2010
419 - 919	3 BHK	West	2055

* Areas in Square Feet

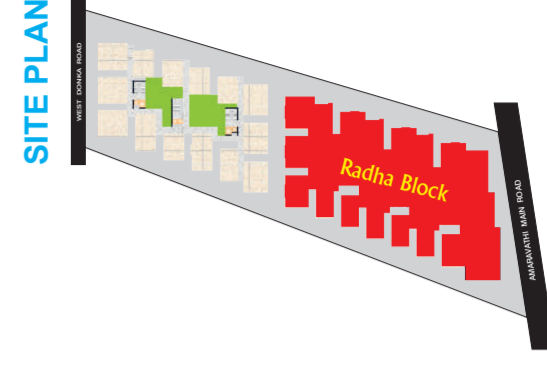



RADHA KRISHNA
TOWERS
Krishna Block
1st, 2nd & TYPICAL FLOORS

First & Second Floors

Flat No.	Type	Facing	Area
201, 202 & 301, 302	3 BHK	East	1730
203 & 303	3 BHK	East	1807
204, 208 & 304, 308	3 BHK	East	1695
205, 209 & 305, 309	2 BHK	West	1320
206 & 306	2 BHK	North	1240
207, 210, 211 & 307, 310, 311	2 BHK	East	1320
212, 213, 214 & 312, 313, 314	3 BHK	West	1930

* Areas in Square Feet

Typical Floor

Flat No.	Type	Facing	Area
401 - 901	3 BHK	East	1730
402 - 902	3 BHK	East	1730
403 - 903	3 BHK	East	1807
404 - 904	3 BHK	East	1695
405 - 905	2 BHK	West	1320
406 - 906	2 BHK	North	1240
407 - 907	2 BHK	East	1320
408 - 908	3 BHK	East	1695
409 - 909	2 BHK	West	1320
410 - 910	2 BHK	East	1320
411 - 911	2 BHK	East	1320
412 - 912	3 BHK	West	1930
413 - 913	3 BHK	West	1930
414 - 914	3 BHK	West	1930

* Areas in Square Feet

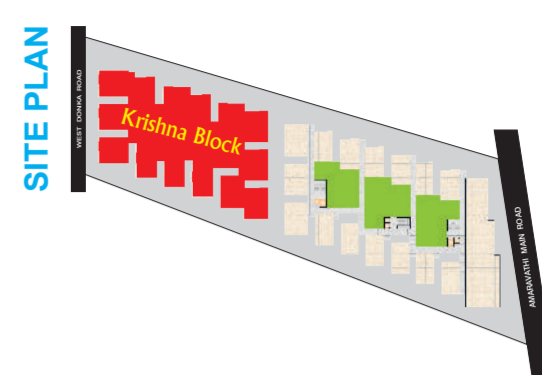
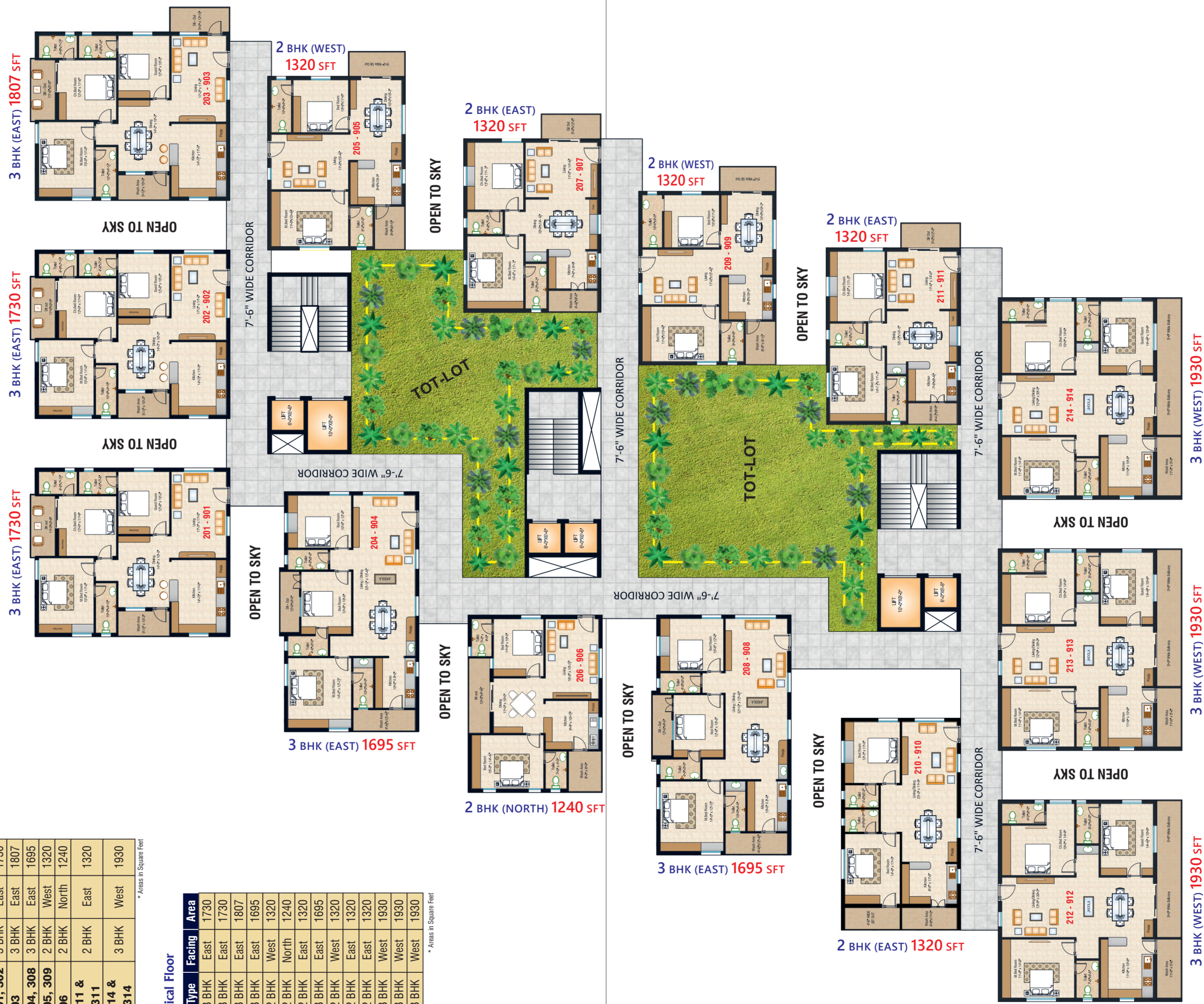

SPECIFICATIONS



STRUCTURE

R.C.C. framed structure which is resistant to wind.



SUPER STRUCTURE

All external wall of 9" and internal walls of 4 1/2" thickness brick.



DOORS

- Main Door Veneer frame with shutter Polish Finish and standard brass fittings.
- Internal Doors Veneer frame with quality flush doors.
- Fixed with reputed make hardware.



WINDOWS

UPVC framed glazed sliding / open shutters with glass and MS safety grills.



FLOORINGS

- Vitrified tiles flooring of 4' x 2' size in Drawing room, Lounge area and Dining hall.
- All other areas with Vitrified Tiles.
- Ceramic tiles in toilets, balconies and wash areas.



TILES CLADDING & DADOING

- Kitchen has Ceramic tiles dadoing up to 2 ft. height above the kitchen platform.
- Toilets Concept ceramic tiles dado upto lental level.



KITCHEN

- Polished granite over kitchen platform with Stainless Steel Sink.



WARDROBES

Cement Planks up to 20% of the flat plinth area.



ELECTRICAL

- 3 phase concealed copper wiring of reputed make.
- Adequate number of points will be provided.
- DB's with MCB's of superior quality in each flat for safety.
- Modular switches and plugs of reputed make.



SANITARY FITTINGS

- All toilet provided with Western style water closets / commodes.
- Ceramic ware of ISI branded make.
- CP fittings of ISI branded make.



WALL FINISHES / PAINTS

All Internal Walls painted with OBD Paints.



EXTERNAL WALLS

- Weather proof cement / textured paint of reputed make.



ELEVATORS / LIFTS

Service & Goods Lifts along with Passenger Lifts for each Block of standard make will be provided.



BACKUP FOR POWER

Generator power backup for Lift, and Common area Lights with acoustic enclosure for uninterrupted power supply.



PARKING

One car parking for each flat.



OWNER'S COST

GST, Labour Cess & Registration Charges and all other Govt. charges.

Any changes or alterations against above said specifications will be extra cost.



Supermart

All in one
SUPERMARKET

Ambient
BANQUET HALL



Banquet Hall



Walking Track

Botanical
WALKING TRACK

Fully Equipped
GYM CENTER



Gym Center



Yoga Room

Peaceful
YOGA HALL