

Suchirindia has been a diversified business house since a decade and a half with interests in real estate, hospitality, construction and more. Found by **Dr. Y. Kiron**, Suchirindia has master planned luxury homes, resorts and railway infrastructure to name a few. We believe in living the future, today. And bring great customer experience every time.



Project by



suchirindia®

Come...
Live the Future!

Accolades. Applause. Appreciation.



Recognized as Asia's Greatest Brands - 2017 by Asia One Organization in Singapore
 Recognized as Asia's Greatest Leaders - 2017 by Asia One Organization in Singapore
 Recognized as Emerging Developer, 2018-19 by Common Floor
 Recognized as Extraordinary Brand, 2018-19 by Brand Vision Summit
 Recognized as India's Most Admirable Brand, 2019 by The Brand Story



Recognized as Extraordinary Brand, 2017-18 by Brand Vision Summit
 Recognized as Pride of Nation Award by Shri. Rajnath Singh
 Recognized as Emerging Developer, 2018-19 by Common Floor
 Recognized as The Most Dynamic Businessmen by The Biz Awards
 Recognized as Best Premium Lifestyle Project by Times Realty Icon - 2018

Turning Dreams Into Reality



Pharaoh Kingdom!

The Giza Polis by Suchirindia is a multi-million dollar luxurious home project. Spread over 11 acres of greenery, this Egyptian themed open plots project is near to the international airport and away from the hubbub of the city. It comes with the trust associated with Suchirindia, a trusted name in luxury housing. Ultra modern facilities and state-of-the-art amenities amidst lush greenery make life truly royal. Added to it the Egyptian theme makes The Giza Polis truly a Pharaoh Kingdom.

Suchirindia's
Papyrus Port
an egyptian resort



suchirindia®
www.suchirindia.in

Suchir Capital, 50-B, Journalist Colony,
Jubilee Hills, Hyderabad - 500096

Note: This brochure is purely a conceptual presentation and not a legal offering. The Developer reserves the right to make changes in elevation, specifications and plans as deemed fit.

Project by



suchirindia®

Come...
Live the Future!

A life of a Monarch in the city of Nizams

Suchirindia's
Giza Polis
The Pharaoh's Kingdom
Luxury Villa Plots at Kothur on Bangalore Highway



Welcome to Pharaoh Kingdom!

Your dream home is all set to invite you into a dream lifestyle. Themed on Egyptian royalty, The Giza Polis are open plots with ultra-modern facilities and amenities will give you a life that is no less than that of a King.

The Giza Polis by Suchirindia is a multi-million dollar luxurious home project. Spread over 11 acres of greenery, this Egyptian themed open plots project is near to the international airport and away from the hubbub of the city. It comes with the trust associated with Suchirindia, a trusted name in luxury housing. Ultra modern facilities and state-of-the-art amenities amidst lush greenery make life truly royal. Added to it the Egyptian theme makes The Giza Polis truly a Pharaoh Kingdom.



MASTER LAYOUT



Qualities that make your home, a palace

PROJECT HIGHLIGHTS:

- ▶ HMDA Layout
- ▶ Entire layout has been designed as per Vaastu
- ▶ All B.T. Roads
- ▶ Electricity
- ▶ Transformer & Street lights
- ▶ Underground Drainage
- ▶ Over Head Tank
- ▶ Children Park
- ▶ Avenue Plantation
- ▶ Compound wall for Entire layout with entrance gate
- ▶ Construction undertaken



Proposed Layout

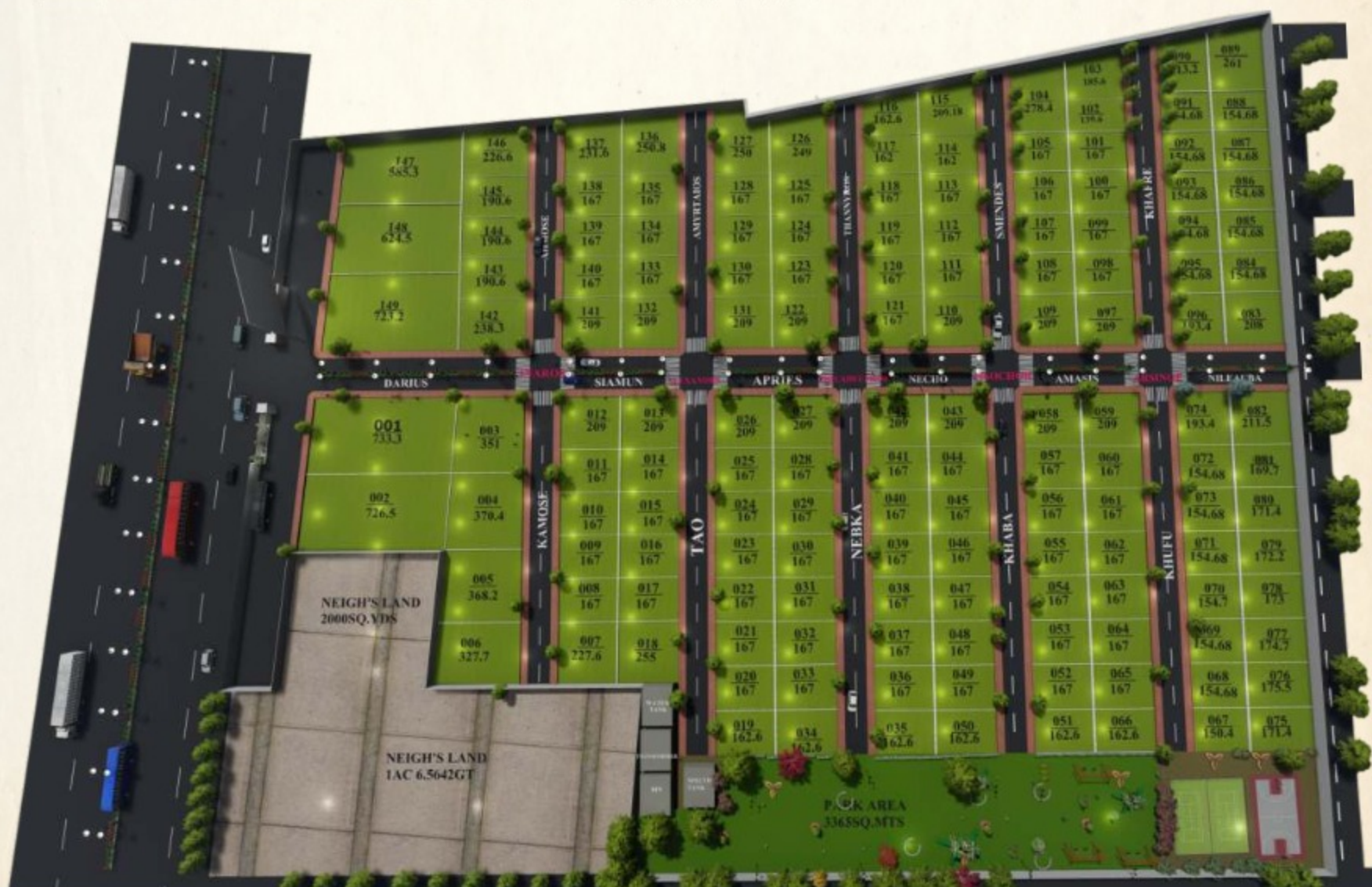

PLOT NO.	EXTENT	FACING	PLOT NO.	EXTENT	FACING
1	659	WEST	84	198	EAST
2	644	NORTH / WEST	85	196.05	EAST
3	644	NORTH/EAST	86	195	EAST
4	660	EAST	87	194	EAST
5	440.05	EAST	88	192.05	EAST
6	392	EAST	89	313	EAST
7	272.05	WEST	90	255	WEST
8 - 11	200	WEST	91 - 95	185	WEST
12	250	NORTH / WEST	96	231.05	SOUTH / WEST
13	250	NORTH / EAST	97	250	SOUTH / EAST
14 - 17	200	EAST	98 - 101	200	EAST
18	272.05	EAST	102	167	EAST
19	194.05	WEST	103	222	EAST
20 - 25	200	WEST	104	333	WEST
26	250	NORTH / WEST	105 - 108	200	WEST
27	250	NORTH / EAST	109	250	SOUTH / WEST
28 - 33	200	EAST	110	250	SOUTH / EAST
34	194.05	EAST	111 - 113	200	EAST
35	194.05	WEST	114	194	EAST
36 - 41	200	WEST	115	250.05	EAST
42	250	NORTH / WEST	116	195	WEST
43	250	NORTH / EAST	117	194	WEST
44 - 49	200	EAST	118 - 120	200	WEST
50	194.05	EAST	121	250	SOUTH / WEST
51	194.05	WEST	122	250	SOUTH / EAST
52 - 57	200	WEST	123 - 125	200	EAST
58	250	NORTH / WEST	126	298	EAST
59	250	NORTH / EAST	127	299.05	WEST
60 - 65	200	EAST	128 - 130	200	WEST
66	194.05	EAST	131	250	SOUTH / WEST
67	180	WEST	132	250	SOUTH / EAST
68 - 73	185	WEST	133 - 135	200	EAST
74	249	NORTH / WEST	136	300.05	EAST
75	205.05	EAST	137	277.05	WEST
76	210	EAST	138 - 140	200	WEST
77	209	EAST	141	250	SOUTH / WEST
78	207.05	EAST	142	647	SOUTH / EAST
79	206	EAST	143	567	EAST
80	205	EAST	144	593	EAST
81	203.05	EAST	145	531	WEST
82	253	NORTH / EAST	146	567	WEST
83	249	SOUTH/EAST	147	647	SOUTH / WEST



LOCATION MAP

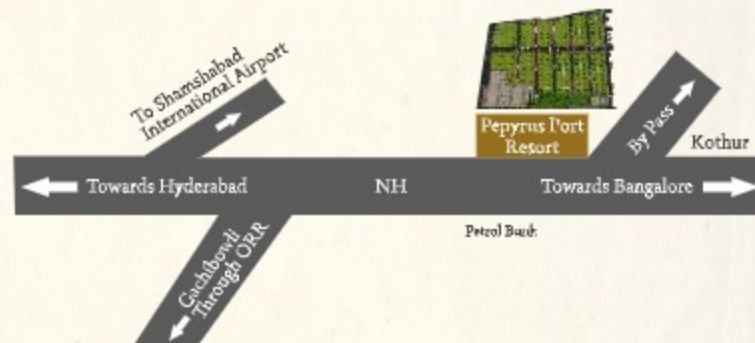

Near civilization, in nature's lap

LOCATION HIGHLIGHTS:

- ▶ Adjacent to Bangalore Highway
- ▶ Surrounded by Residential Townships
- ▶ Regional Ring Road (RRR)
- ▶ Outer Ring Road (ORR)
- ▶ P&G (Procter & Gamble)
- ▶ Johnson & Johnson
- ▶ amazon warehouse
- ▶ MY Home Townships
- ▶ GMR Townships
- ▶ NATCO Pharma
- ▶ LV Prasad Eye Hospital
- ▶ Shamsabad International Airport
- ▶ Shamsabad New Bus Terminal
- ▶ Timmapur New Railway HUB
- ▶ JIMS Hospital
- ▶ Chinnajeeyar Swami Ashram
- ▶ Swarna Bharat Trust
- ▶ MNC Companies near to our Project