

Delivering Value



Sadhgruha Projects is all about value for customers. The commitment and hard work is evident in every project and Sukeerthi Sadan is no exception. An improved quality of living is made possible through professional approach and value proposition.

Clear titles, value engineering and desirable amenities make the project eminent. Sukeerthi Sadan as investment or a carefree lifestyle. Sukeerthi Sadan is a matchless offer. You can't afford to ignore the fact that the city is rapidly developing.



Distances

- Beside Residential colonies like NGO Colony & Journalist Colony
- 1 Km from Kothavalasa to Vizianagaram 4 lane road
- 1.5 Km from Kothavalasa Sub Registrar's Office, MRO Office and Police Station
- 2 Km from 525 areas Central Tribal University
- 2.5 Km from Kothavalasa Junction
- 3 Km from Kothavalasa Rly.Station
- 7 Km from Anandapuram to Anakapalli 6 lane National Highway
- 10 Km from B R T S Road (Pendurti Junction)
- 20 Km from NAD Junction
- 29 Km from Vizag RTC Bus Station
- Surrounded by residential area
- 22 Km from Airport

THOUGHTFULLY INNOVATIVE THAT FULFILLS YOUR DREAMS



**Sukeerthi
Sadan**
24.5 Acres Gated Community
@ Kothavalasa



SADHGRUHA PROJECTS PVT. LTD.

స్వచ్ఛమైన మీ కలలకు... అచ్చమైన ప్రతిరూపం... “సద్గృహ”

D.No: 55-25-3&6, Dredge House, 1st Floor, North Wing,
HB Colony Main Road, Seethammadhara,
Visakhapatnam-530 022.



www.sadhgruha.com
sadhgruha@gmail.com



SADHGRUHA PROJECTS PVT. LTD.

స్వచ్ఛమైన మీ కలలకు... అచ్చమైన ప్రతిరూపం... “సద్గృహ”



SADHGRUHA PROJECTS PVT. LTD.

స్వచ్ఛమైన మీ కలలకు... అచ్చమైన ప్రతిరూపం... “సద్భూ”

About Us

In the supremely dynamic and competitive sphere of property development, one name has consistently been a trail blazer, setting the trends for others to follow. The innovation-led, future-focused Sadhgruha Projects Pvt Ltd was Established by Mr. D. Sudhakar, the company has been the pioneering force behind the rapidly changing Excutive Capital City - Visakhapatnam, with developments that span the residential, open housing layouts sector.

The company has been at the forefront over the past decade in the Real Estate segment under the able guidance of Mr. D. Sudhakar with his deep insight & rich experience of over 18 years, has been instrumental in framing the corporate structure of the company, which in turn has enabled the company to surpass many milestones. Their wealth of experience speaks volumes about the quality results of Real Estate. Our ventures are known for their strategic locations and excellent civic amenities.



Sadhgruha Projects is driven by quality, affordability, and customer centric. Sukeerthi Sadan is located in Nurture the nature and teach your kids how to enjoy the countryside adjacent to developed residential living area. Investing in Sukeerthi Sadan will give you high return on investment, and will be one of the best option for you to invest in Visakhapatnam

Sadhgruha is Launching it's New Exciting Venture Sukeerthi Sadan at Ralli Village, Kothavalasa Mandal, Vizianagaram Dist. The Venture has everything to Offer in terms of facilities and comfort. Sadhgruha develops in approximately 24.5 Acres at the best Residential Zone of Smart City Visakhapatnam.

Amenities:



Club House



Swimming Pool



Compound Wall for Entire Layout



40ft Wide Blacktop Roads



Underground Electricity



Underground Drainage



Indoor Games



Designed Entrance Arch



24x7 Security



Children Play Area



Rain Water Harvesting



Jogging Track



Park



Avenue Plantation



Vasthu Compliant



**RECREATE
RECHARGE
REFRESH**

Where
love, life and
laughter await.



Sukeerthi Sadan

24.5 Acres Gated Community
@ Kothavalasa



Welcome to Sprawling Nature



Where greens are a part of life

A place is something that is close to your heart while it's an added advantage if it's closer to nature as well. Keeping the same thought alive, Sadhgruha have planned housing site that are within the greens under the name Sukeerthi Sadan.

Now you've reached the most cherished spot on this lush green land. An address with a difference, the emphasis is on the outdoors, landscaping, family parks, pedestrian walkways and bicycle paths. Clearly, this is a place where you can remove yourself from the hustle and bustle of urban rush-hour



Just close your eyes,
Hold your breath in for a moment
now exhale as slowly as possible.
Relax your mind, body and soul,
And let everything else go.

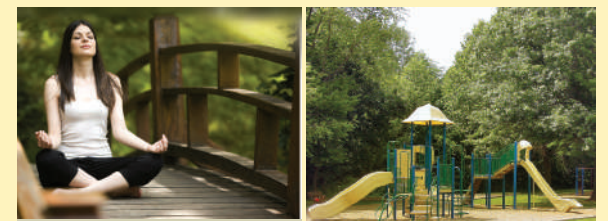



Sukeerthi Sadan

24.5 Acres Gated Community
@ Kothavalasa

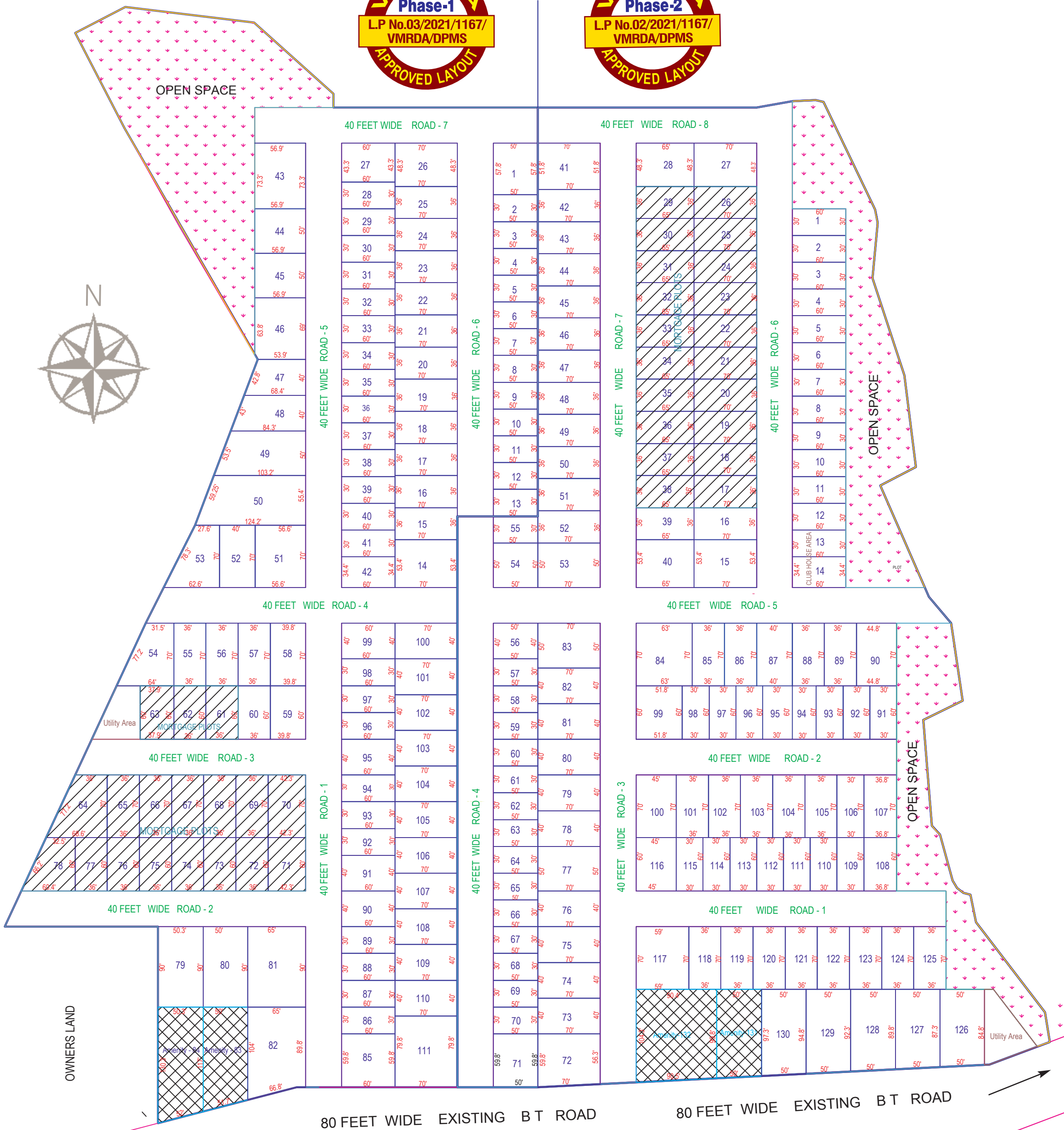

SADHGRUHA PROJECTS PVT. LTD.

స్వచ్ఛమైన మీ కలలకు... అచ్చమైన ప్రతిరూపం... “సద్భవా”

D.No: 55-25-3&6, Dredge House, 1st Floor, North Wing, HB Colony Main Road,
Seethammadhara, Visakhapatnam-530 022. www.sadhgruha.com