

A Lavish Launchpad for Elevated Living

Every bird is born to fly. So is your lifestyle. At Vihanga, we have curated the ultimate modern nest — a connected community where your life can truly take flight across 2 acres of expanse, and your spirit can breathe freely amidst 67% open spaces. Featuring a magnificent, masterpiece façade that redefines the skyline, Vihanga is a sanctuary meticulously crafted to be the perfect launchpad for elevated living.



HMDA & RERA APPROVED PROJECT

TOTAL AREA ABOUT 2 ACRES

279 UNITS

3 BHK PREMIUM RESIDENCES

UNITS AVAILABLE 1695 TO 2300SFT.

67% OPEN SPACE

PREMIUM CLUBHOUSE



SITE QR CODE

EDUZONE

- Meru Int. School - 1 Mins.
- Samshti Int. School - 4 Mins.
- Gaudium Int. School - 5 Mins.
- Glendale Int. School - 5 Mins.
- Narayana Jr College - 5 Mins.
- Birla Open Minds School - 8 Mins.
- Delhi Public School - 10 Mins.
- ICFAI Business School - 15 Mins.
- CBIT - 20 Mins.

GOSPOT

- Kollur ORR Exit - 2 Mins.
- Tellapur Railway Station - 4 Mins.
- Lingampally Railway Station - 15 Mins.
- Int. Airport - 30 Mins.

STARZONE

- My Home Mall (Proposed) - 1 Mins.
- Aparna Mall - 10 Mins.
- Skyzone - 15 Mins.
- Golkonda Resorts - 20 Mins.
- Sarath City Mall - 20 Mins.

TASKHUB

- Kollur IT Park (Proposed) - 8 Mins.
- Neopolis Kokapet SEZ - 13 Mins.
- Financial District - 14 Mins.
- Cyber Towers - 25 Mins.

HEALING

- Citizen Hospital - 9 Mins.
- Continental Hospitals - 15 Mins.
- AIG Hospitals - 20 Mins.



Corporate Office
Vaibhavi Infra Projects
Vamshiram Jyothi Celesta,
5th Floor, Plot No. 66, Kavuri Hills Rd,
Opp. D-mart, Madhapur, Hyderabad-81.
Email : vaibhaviprojects@gmail.com

Site Office
Silpa Vaibhavi Vihanga
Sy.No. 133/A/2,133/AA/2 of
Kollur-ORRGC Village,
Ramchandrapuram - ORRGC Mandal,
Sanga Reddy District, Telangana.

Architect
ARCHIWING Studio
Gachibowli, Hyderabad.

Spread your wings from Tellapur's Heart

Nestled in the planned, verdant environs of Tellapur, Vihanga offers unmatched connectivity. With the proposed Kollur IT Park nearby and easy access to Gachibowli and the Financial District via the ORR, premier education and healthcare facilities are within reach. Within just 15-20 minutes, enjoy fine dining, cafés, and mega malls — all seamlessly blending convenience with a lifestyle of distinction.

LOCATION PLAN (not to scale)

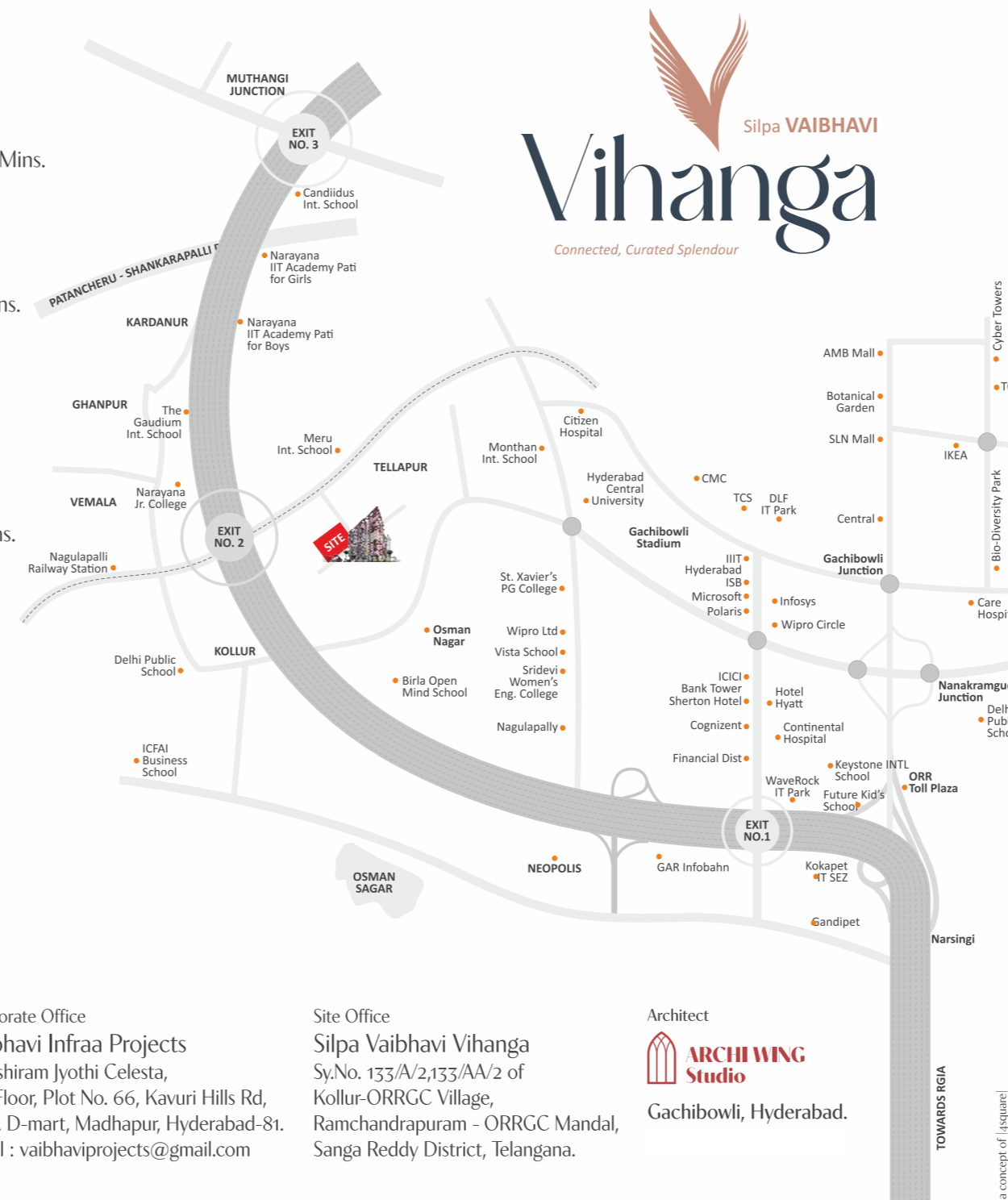

Nest in luxury.
Soar with connection



Richly Refined Lifestyle @ tellapur

Note: This document is for general information purposes only. The developer and its team do not guarantee the accuracy or completeness of the information provided. All images are artistic impressions for illustration purposes only. Designs, dimensions, fittings, and specifications are subject to change without notice. Furniture is not included. Prospective buyers should verify all details independently. This document does not constitute an offer or contract



spaces to soar, pleasures to savor

Vihanga is a sanctuary for every facet of your life. Energise in spacious fitness spaces and a resort-style swimming pool. Find focus in inspiring co-working lounge and quiet library, or host gatherings in the elegant party hall. Meander through lush green pathways to shaded seating nooks. With dedicated spaces for indoor/outdoor games, guest hospitality, and personal pampering, every detail is curated for a life of seamless luxury and connection.



- Grand Entrance
- Yoga Area
- Half Basket Ball Court
- Children's Play Area
- Multipurpose Lawn
- Jogging Track
- Cricket Net Practice
- Pickle Ball Court
- Outdoor Gym
- Seating Deck Under Pergola
- Elderly Seating
- Ev Charging Station
- Visitors Car Parking
- Waiting Pavilion
- Walkways



- Lounge Area
- Party Hall
- Well Equipped Gym
- Indoor Games
- Multipurpose Play Room
- Coworking Space & Library
- Creche
- Guest Rooms
- Gentleman Room
- Salon Provision
- Swimming Pool
- Kids Pool

4 EAST - 3BHK 2300 SFT



5 WEST - 3BHK 1930 SFT



6 WEST - 3BHK 1695 SFT



3 EAST - 3BHK 2012 SFT



7 WEST - 3BHK 1695 SFT



2 EAST - 3BHK 2012 SFT



8 NORTH - 3BHK 2000 SFT



1 EAST - 3BHK 2300 SFT



9 NORTH - 3BHK 2000 SFT

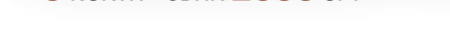

typical floor plan

13 EAST - 3BHK 1930 SFT



14 WEST - 3BHK 2300 SFT



12 EAST - 3BHK 1695 SFT



15 WEST - 3BHK 2012 SFT



11 EAST - 3BHK 1695 SFT



16 WEST - 3BHK 2012 SFT

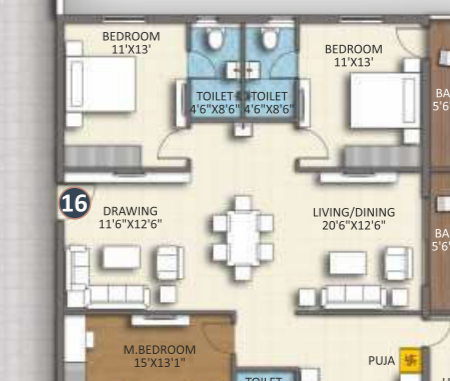

10 NORTH - 3BHK 2000 SFT



17 WEST - 3BHK 2300 SFT



10 NORTH - 3BHK 2000 SFT



17 WEST - 3BHK 2300 SFT



specifications

FOUNDATION : RCC Framed Structure.

WALLS : 8" thick CC/AAC blocks for External Walls. 4" and 6" CC/AAC blocks for internal Walls

PLASTERING : Cement Plastering with Smooth Finish.

PAINTING

Interior Painting : Smooth finish with putty and two coats of emulsion paint over a coat of primer reputed brands make.

Exterior Painting : Combination of branded putty and surface texture as per architecture specs 2 coats of exterior paint over a coat of primer reputed brands make.

DOORS

Main Door : Hardwood frame and designer veneered flush shutter finished with Melamine Spray polish.

Internal Doors : Factory made wooden frame and both side laminated/Veneer flush shutters with reputed hardware.

Balconies : Aluminium/UPVC glazed French sliding doors with mosquito mesh provision.

Windows : UPVC frames and shutters fitted with glass and mosquito mesh, necessary hardware.

KITCHEN : Granite platform, stainless steel sink level above the platform.

TOILET : Wall-mounted EWC in all bathrooms. Glazed wall tiling upto lintel level. Single lever bath and shower mixer. All sanitary fitting of reputed make.

Utility & Wash : Glazed tile dado up to 3ft height wherever possible.

ELECTRICAL

Power plugs for cooking range, chimney, refrigerator, microwave oven, water purifier, mixer/grinders in kitchen, washing machine and dish washer in utility area.

PLUMBING : Superior quality IS specified CPVC & PVC piping for water supply and sanitary/sewages respectively.

WATER PROOFING : For all toilets, wash areas and terrace.

LIFT

Lift of reputed make. Lift lobby cladding with vitrified tiles/granite.

POWER BACKUP

Common : Power backup for lift, water pumps and lights. Flats : All lights and fans in the flat.

INTERNET/TV

Provision for internet and DTH. Provision for TV points in All bedrooms and living.

SECURITY

Intercom facility to all units connecting to security. Security System with surveillance cameras at appropriate locations. Delivery packages drop off area.

FIRE SAFETY : Fire Alarms, Hydrants and sprinklers as per norms.

PNG/LPG : Centralized gas bank with piped gas to all flats.

STP : STP treated water for flushing and landscaping.