



TS RERA  
APPROVED  
P01400004223



# SANNIDHI WALDEN

Plotted Development @ Udityal



SANNIDHI  
VENTURES

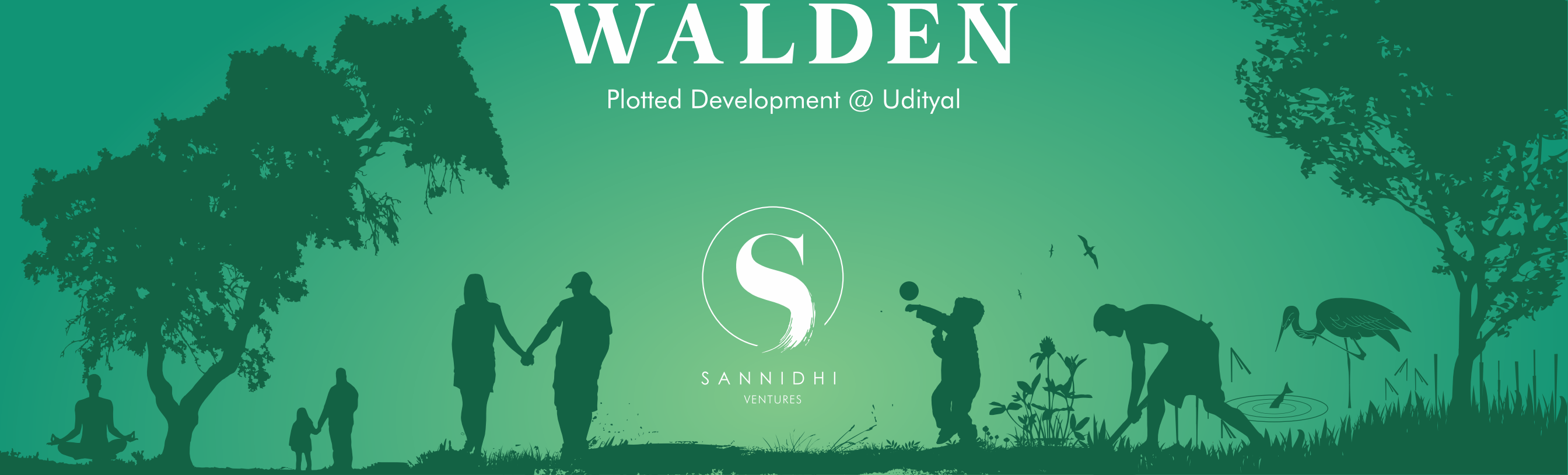



# SANNIDHI WALDEN

Plotted Development @ Udityal

## EMBRACE A BETTER LIFE

We all crave a living space that fosters a sense of pride and lets us live our life in comfort, peace and tranquility. We all want it to be a space that brings together the elements of luxury, nature and all other things that add quality to living and make life easy.

Welcome to a better life. Welcome to Sannidhi Walden.

A home that's more like a getaway, Walden is a sprawling plotted development where you can build your big, comfortable, healthy home, in a pollution-free environment, amidst all the conveniences. Come home to a better life, a life full of promise at Walden in Udityal, Hyderabad.





SANNIDHI  
VENTURES



# SANNIDHI WALDEN

OVERVIEW

**67.675** Acres  
Layout Area

**6.76** Acres  
Site Reserved for Open Space &  
Outdoor Amenities

**45.64** Acres  
Plotted Area

**186**  
Plots

**538-3086** Sq. Yds.  
Plot Sizes

## PROJECT HIGHLIGHTS

- DTCP Approved Layout
- Grand Entrance Arch
- Compound Wall with Solar Fencing
- 24x7 Security
- BT Roads
- Avenue Plantation
- Underground Drainage
- Designer Street Lights
- Over Head Tank with Viewing Deck
- Water Harvesting
- Cycling Track
- Water Connection to each Plot
- Sannidhi Retreat / Resort
- Over 25 Outdoor Amenities

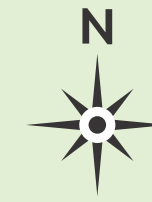

## Master Plan



SANNIDHI  
WALDEN

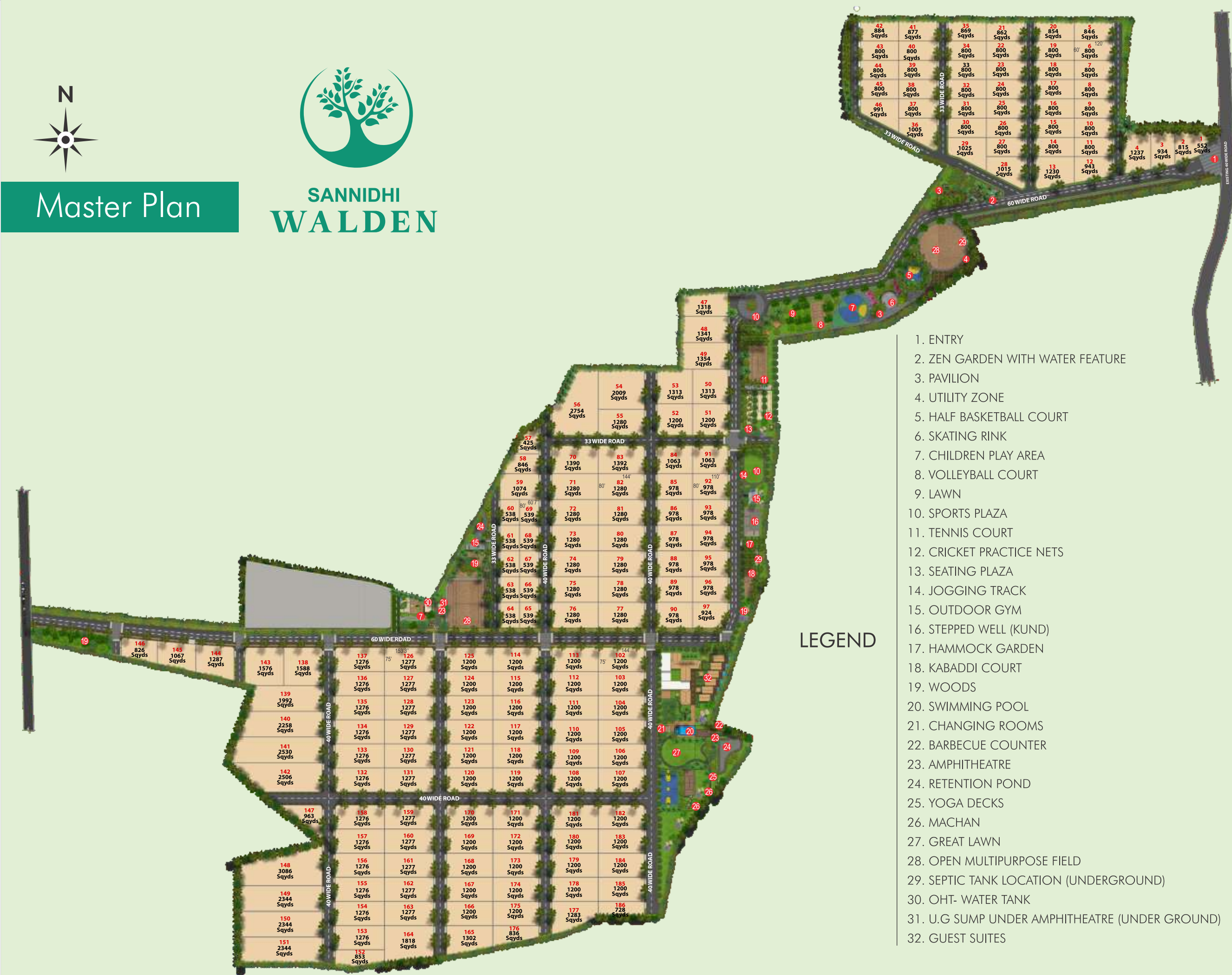

## LEGEND

1. ENTRY
2. ZEN GARDEN WITH WATER FEATURE
3. PAVILION
4. UTILITY ZONE
5. HALF BASKETBALL COURT
6. SKATING RINK
7. CHILDREN PLAY AREA
8. VOLLEYBALL COURT
9. LAWN
10. SPORTS PLAZA
11. TENNIS COURT
12. CRICKET PRACTICE NETS
13. SEATING PLAZA
14. JOGGING TRACK
15. OUTDOOR GYM
16. STEPPED WELL (KUND)
17. HAMMOCK GARDEN
18. KABADDI COURT
19. WOODS
20. SWIMMING POOL
21. CHANGING ROOMS
22. BARBECUE COUNTER
23. AMPHITHEATRE
24. RETENTION POND
25. YOGA DECKS
26. MACHAN
27. GREAT LAWN
28. OPEN MULTIPURPOSE FIELD
29. SEPTIC TANK LOCATION (UNDERGROUND)
30. OHT- WATER TANK
31. U.G SUMP UNDER AMPHITHEATRE (UNDER GROUND)
32. GUEST SUITES



## A WELCOME DISTINCT

Experience a majestic arrival in your own kingdom. With a grand front entrance, Walden welcomes you into a beautiful world of its own.

JOGGING TRACK



## GET YOURSELF GOING, WITH A NICE JOG.

Take a serene walk through the lush landscape and catch up with your neighbours. The exclusive jogging track around the community gives a place to walk your dog out and a space to stroll through in the mornings.



JUNCTION



## PAVING THE WAY FOR A SMOOTH RIDE

Find your way in and out of the community with ease as safe and efficient road junctions ensure a smooth, quick and comfortable flow of vehicles and make your drive enjoyable.

ZEN GARDEN



## CONNECT WITH YOUR INNER ZEN

Find a quiet escape that calms the mind and instills a sense of balance, right next to your home. Giving you a much-needed break from stress, the Zen Garden is the place to gather your thoughts and attain well-being.



SEATING SPACES



## INTERESTING CONVERSATIONS, IN THE LAP OF NATURE.

Awaken your senses with the vivid shades of green surrounding your residence. Socialize with friends, create memories and live life in solitude.



HALF BASKETBALL COURT



## GET THE BALL ROLLING

Take a pause from the bustling city life and shoot some games on the basketball court. Indulge in some fun game sessions with your friends and enjoy this beautiful sport right next to your home.



SKATING RINK



## A PERFECT SETTING FOR SKATING

Let your kids go for a spin in the rink and play to their will. Put on your skating shoes, glide through your free evenings with your kids and have a great time.



CHILDREN PLAY AREA



CHILDREN PLAY AREA



## BECAUSE, KIDS DESERVE IT.

Let your kids enjoy their after-school time, playing and growing in their own dedicated area. Give them a break from virtual life and introduce them to the real world. The exclusive children's play area is theirs and theirs alone; a private escape after school.



VOLLEYBALL COURT



## SERVE THE BALL RIGHT

Stay on top of your volleyball skills. Enjoy playing with friends while maintaining your fitness. Play it for fun or play to win.



PARTY LAWN



## SO MUCH MORE THAN A BEAUTIFUL LAWN

Satiate all your senses and enjoy a scenic haven spread across acres, where every feature gives you pleasure. Let the green and open spaces bring in the peaceful joys of life.



SPORTS PLAZA

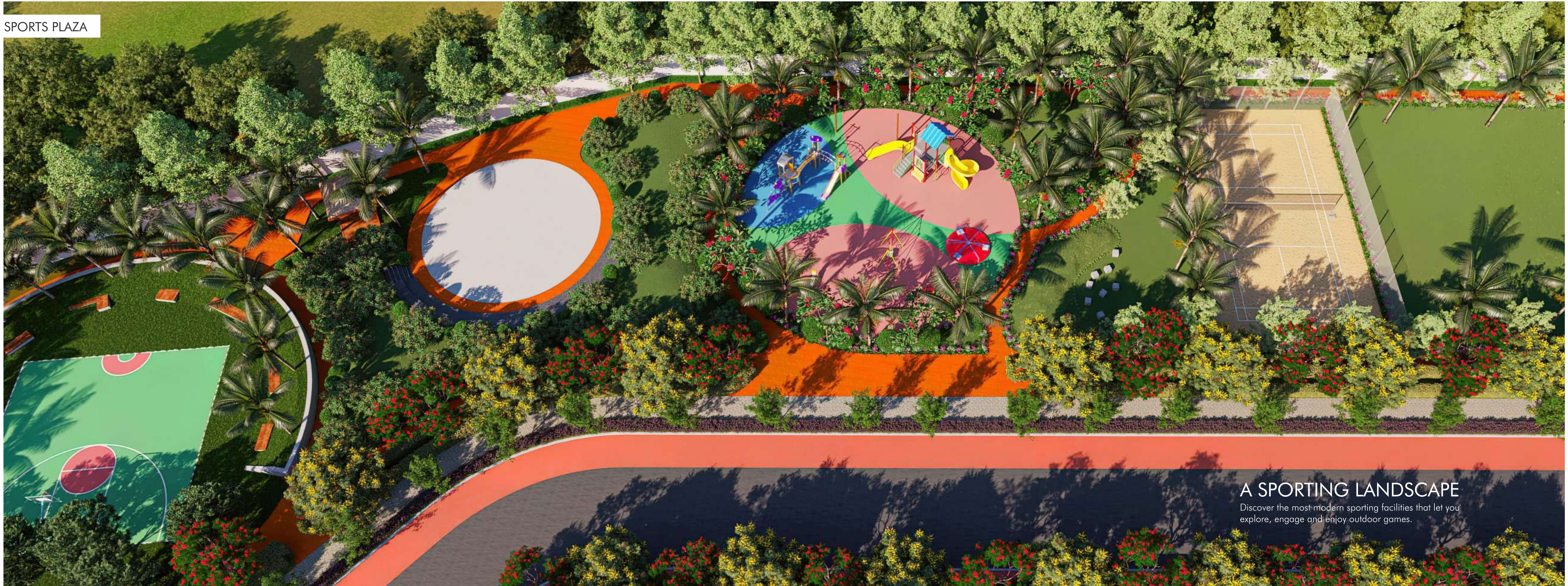

## A SPORTING LANDSCAPE

Discover the most modern sporting facilities that let you explore, engage and enjoy outdoor games.

SPORTS PLAZA ENTRY



## A VENUE FOR EVERY SPORT

Experience exclusive sports facilities and lifestyle spaces in a calm, pleasant community. Relax & recharge with unique amenities that bring the world of sport to your doorstep.



SPORTS PLAZA LAWN

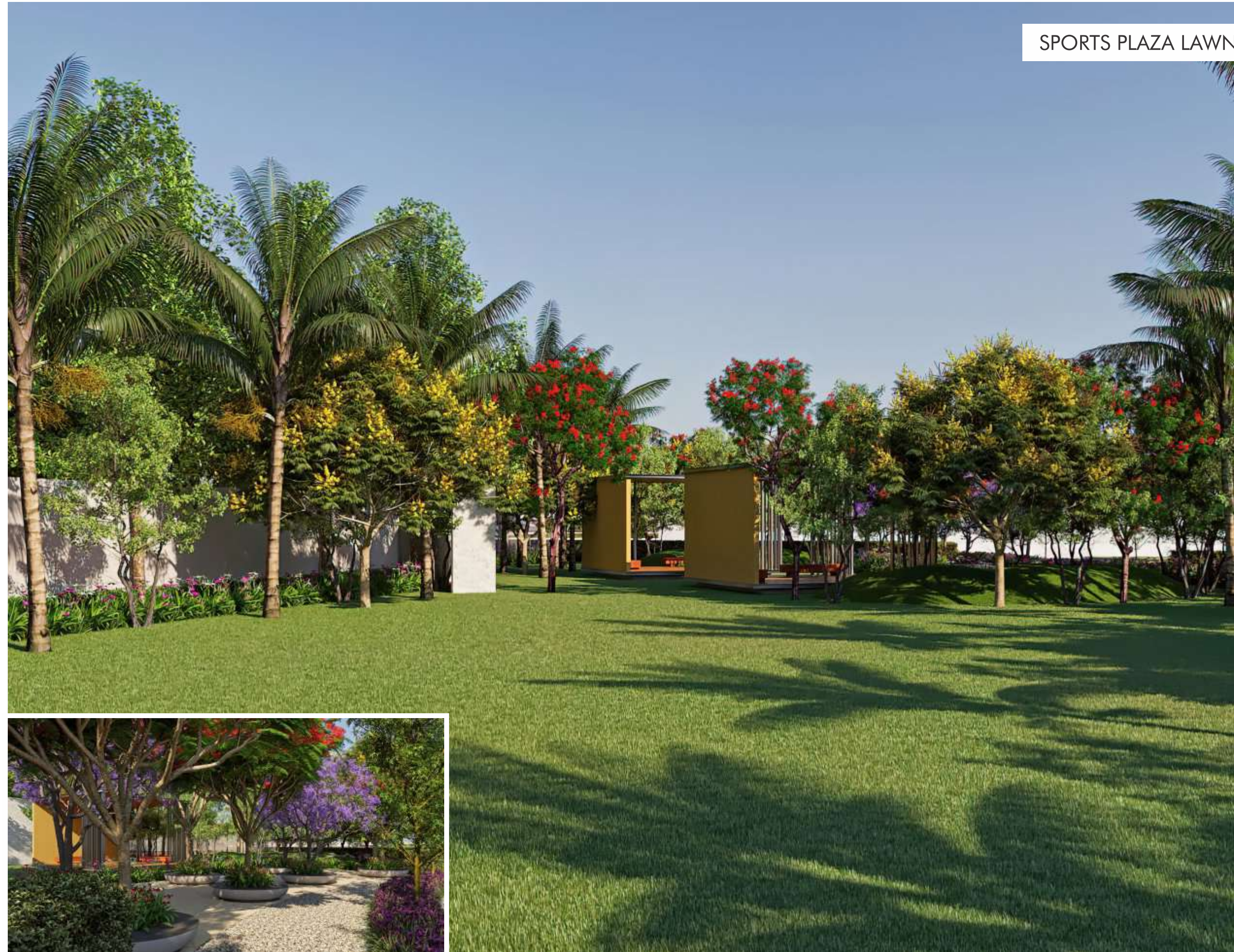

TENNIS COURT



## GAME, SET, MATCH!

Get sporty in your free time and smash away at the Tennis Court. Gear up for singles or doubles match with family & friends and have a ball of time.



CRICKET NET



## KNOCK IT OUT OF THE PARK

Bring out the batsman in you at the cricket practice nets. Improve your cricketing techniques, perfect your shots and enjoy some game time with your friends.

OUTDOOR GYM



## OPEN-AIR WORKOUT

Exercise, not just for your physical well-being, but also your mental health. Work out in a natural and calm, motivating environment under the open sky.



STEPPED WELL

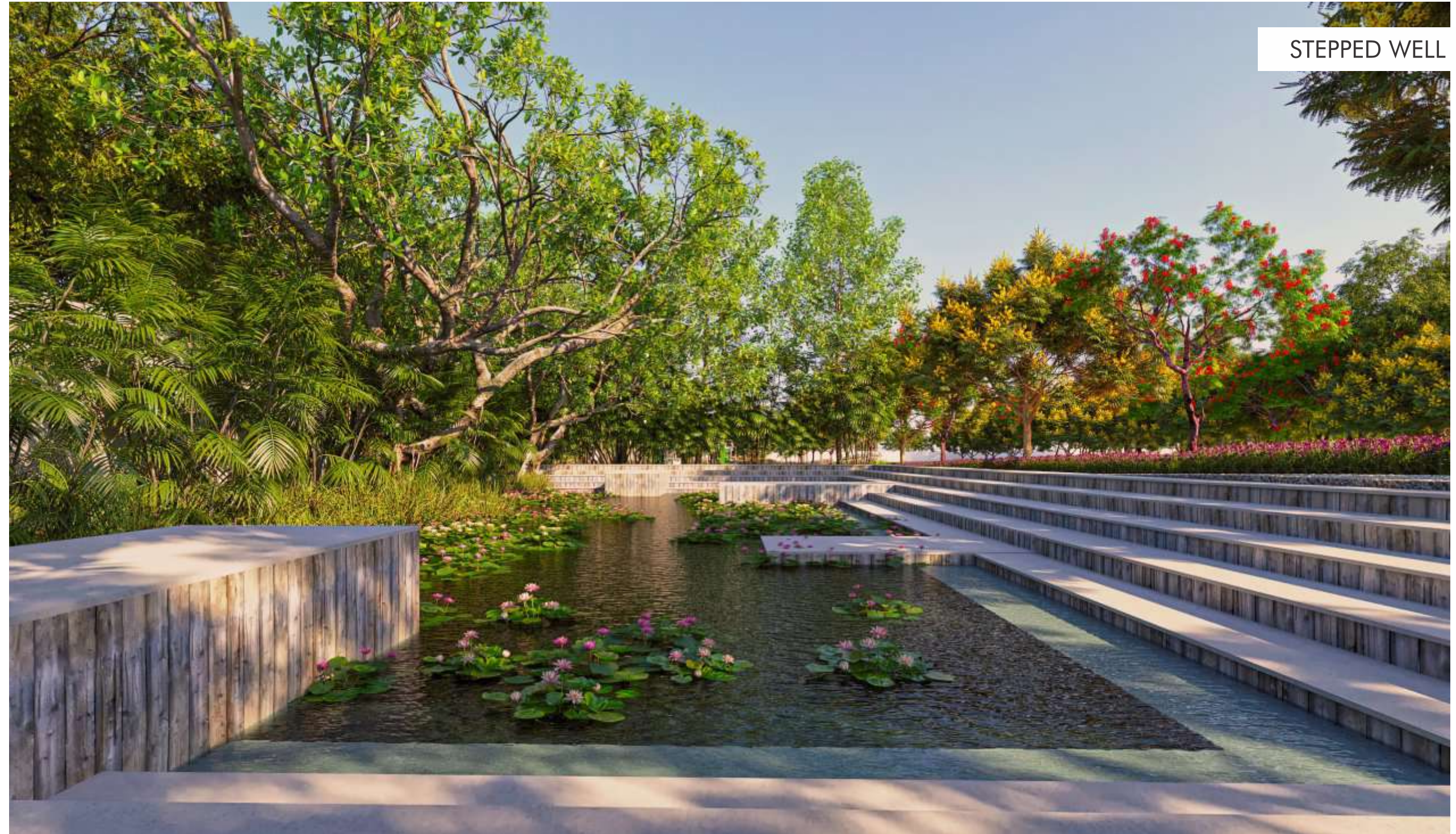

## A VISUAL EXTRAVAGANCE

Experience a quiet escape right next to home. The beautifully built stepped well in the community is not only an exquisite area to relax by, but also adds to the aesthetics.



HAMMOCK PARK

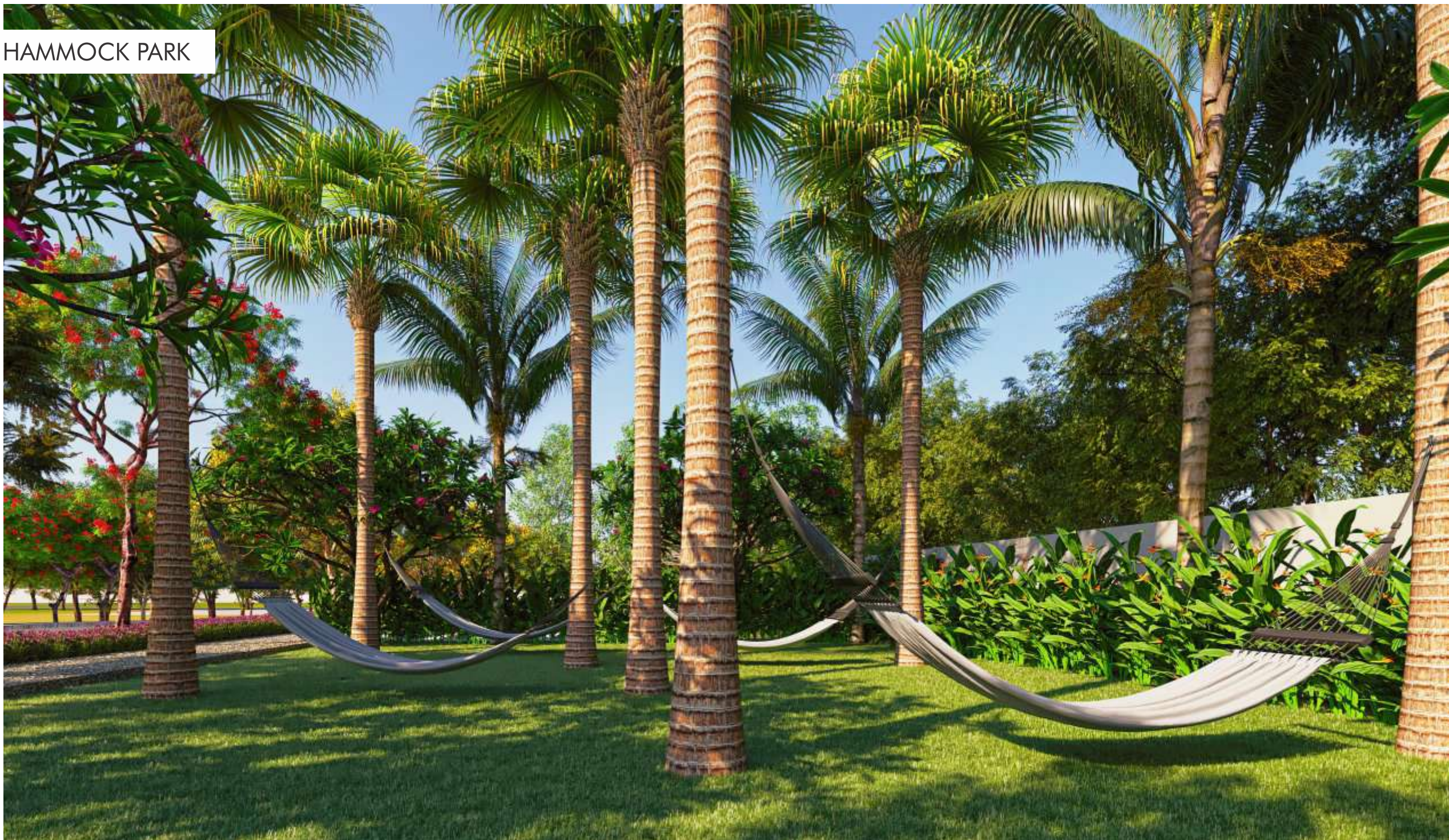

## THE PERFECT HIDEOUT AMIDST NATURE

Take a stroll in the garden and breath in the nature around you. Tune out from the world for some time, feel the sunshine and simply unwind whenever you needed.



WOODS

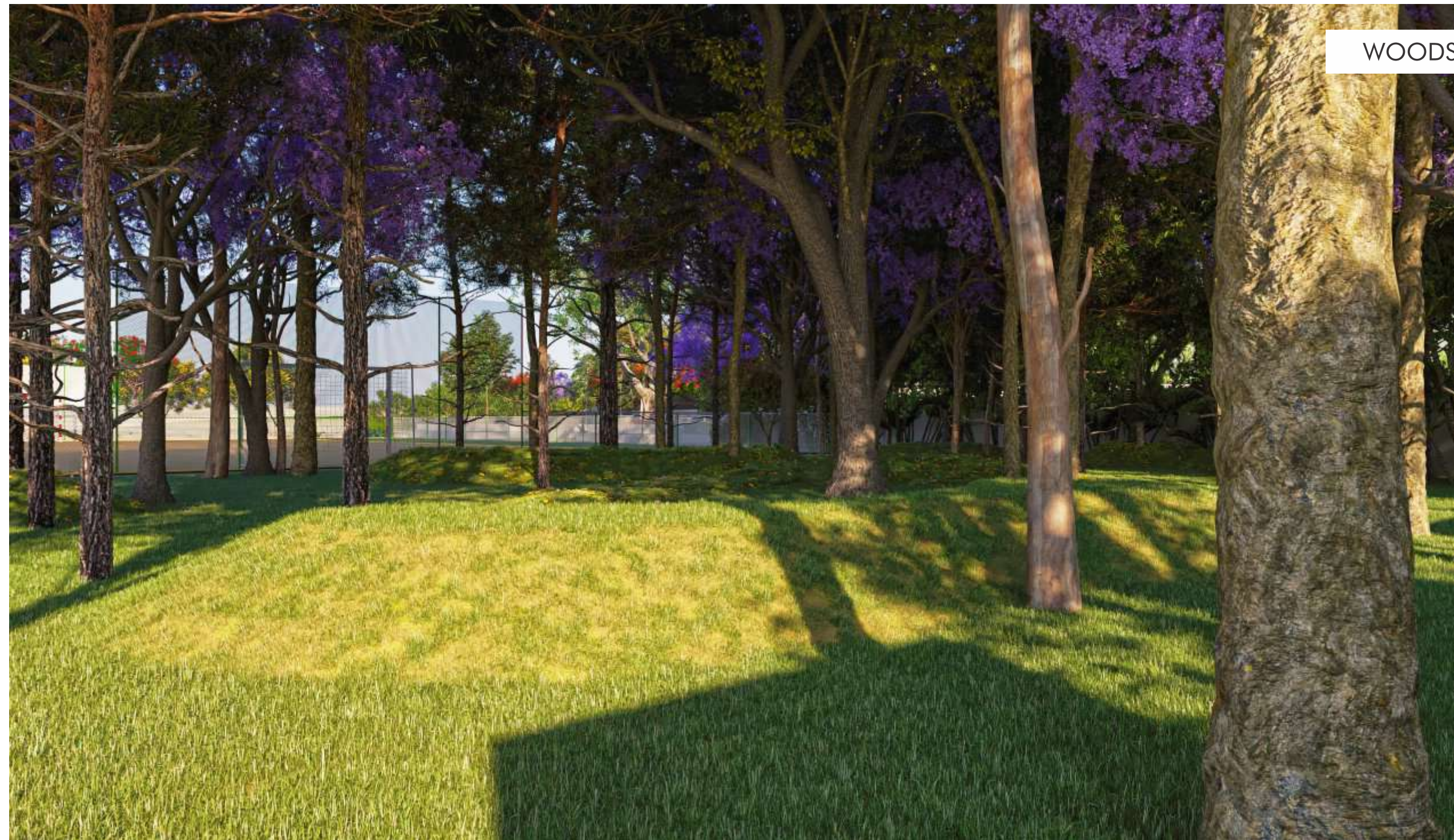

## GREEN WONDERS TO BRIGHTEN THE MIND

Walk in the woods, smell flowers in the backyard and embrace the soothing power of greenery all around you. Find a connection with nature and enjoy the serene moment in the hectic urban life.

KABADDI GROUND



## GAME OF THE MASSES

Stay fit and healthy like never before by playing kabaddi every day. Master your skills or enjoy some fun and intimate sporting moments with family and friends.



AMPHITHEATRE



## WHERE LIFE IS TO LIVE

Breathe in some fresh air after spending the day indoors at work. Pursue favourite hobbies, build friendships, bond with neighbours and enjoy entertained evenings outdoors.



RETENTION POND



## A RETREAT FROM THE BUSTLE OF CITY LIFE

Revel in your own private paradise with a relaxing and aesthetic retention pond in the comfort of your home. As a Walden resident, the exclusive resort lifestyle comes to you.



YOGA



## SPEND TIME ON YOUR MAT

Leave behind the chaos of deadlines at work and experience moments of tranquility amidst nature. Find that ideal yoga spot to clear out your worries and be the most productive version of yourself.



PAVILION



## HAPPINESS EXTENDS BEYOND YOUR HOME

Re-energize and rejoice your mind in a spectacular open-air venue. Take a short walk, soak in the sun, look at the blue sky and treasure the true green life of Sannidhi Walden.



OUTDOOR MULTIPURPOSE FIELD



## PLAY TO YOUR HEART'S CONTENT

Come build your home at Sannidhi Walden and experience vast, well-maintained areas designated especially for sports. At Walden, we have a space for all and all your sports activities.

## AN EXPERIENCE OF A RESORT

Stay one step ahead of luxury in all aspects with our truly lavish, state-of-the-art resort. Be it for recreation, relaxation or celebration, you're sure to find everything you need at Sannidhi Retreat.





SANNIDHI  
RETREAT



INDOOR GAMES



## A FUN WAY TO SPEND TIME INDOORS

Play and discover a variety of board games, tabletop games and more all in one place. Spend quality time with friends & family-play just for fun or test your skills.

## Ground Floor Plan



## First Floor Plan



### LEGEND

1. DROP-OFF
2. ENTRY LOBBY
3. LOUNGE
4. READING LOUNGE
5. BADMINTON
6. SERVICES/  
STAFF LOUNGE
7. KITCHEN
8. BANQUET
9. ALFRESCO
10. SWIMMING POOL
11. BARBEQUE COUNTER
12. WATER RETENTION POND
13. TENNIS COURT
14. GUEST SUITES
15. GYM
16. YOGA / AEROBIC
17. LOCKERS

SWIMMING POOL



## UNWIND AND RELAX

Take out the stress and make your body more flexible and strong swimming in the clean and fresh waters of the pool.



RECEPTION



## READY TO WELCOME YOU

Step into your own private retreat through an elegant & welcoming space that not only makes a great first impression but also compliments your lifestyle with its lovely warm ambience.



GYM

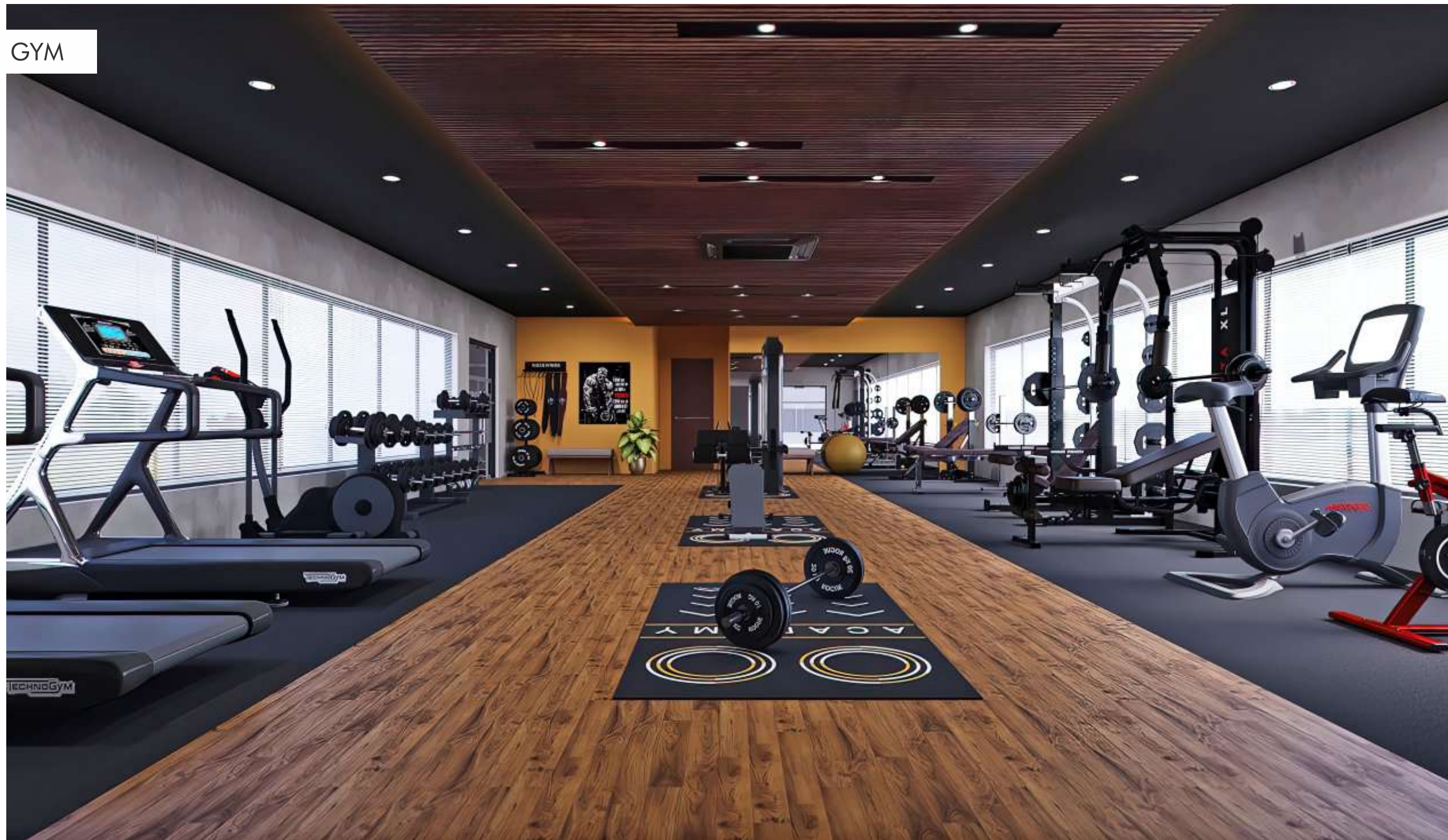

## CHOOSE HEALTH, ABOVE ALL ELSE.

Keep fit and stay rejuvenated mentally- indulge in some form of physical activity daily. Choose fitness regimes that help you balance your work-life stress.



INDOOR BADMINTON COURT

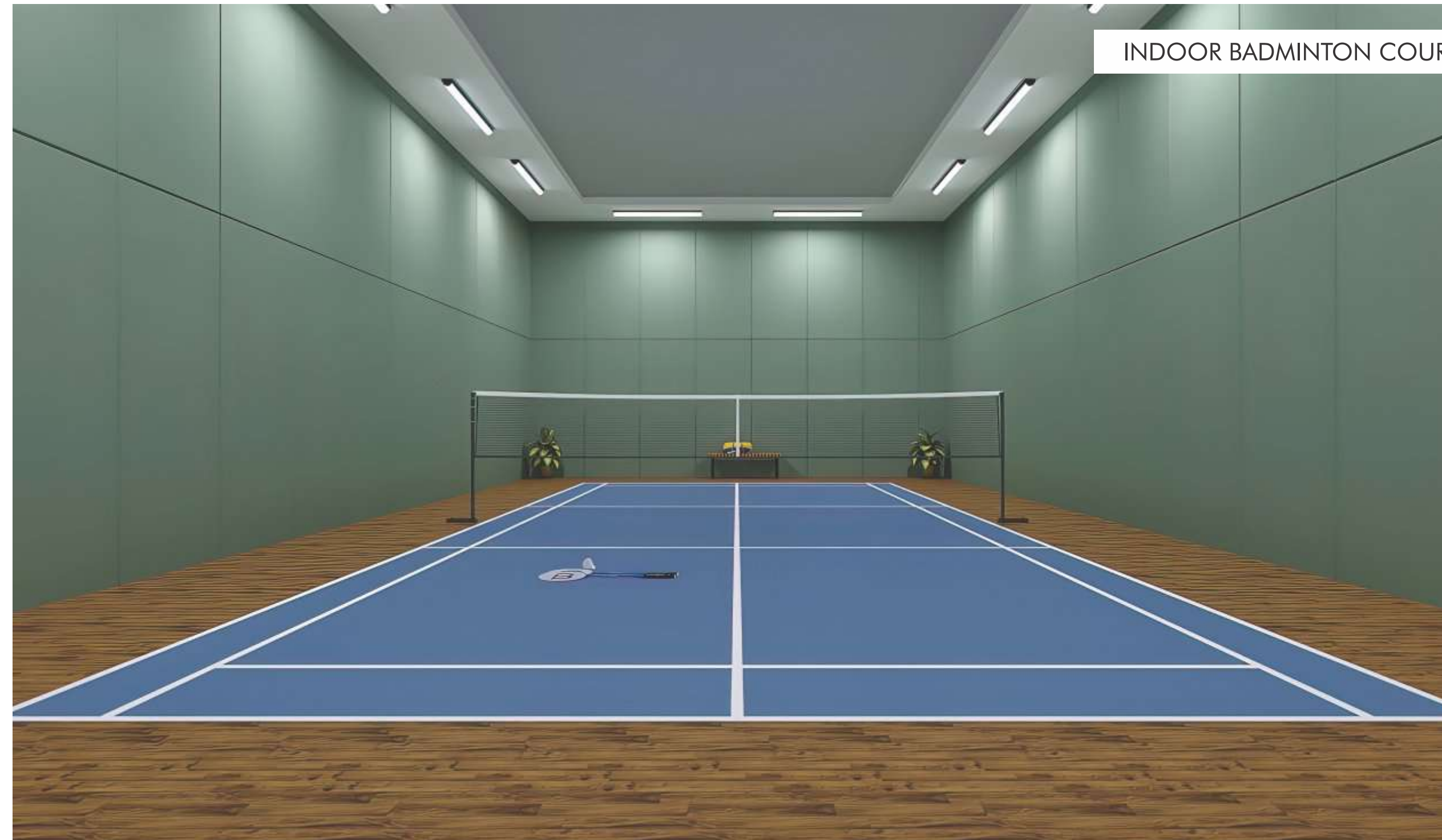

## ACE THE FIT LIFE

Grab your racquet & ball and rally up an intense game. Smash the extra pounds while also improving your badminton skills.

MULTIPURPOSE HALL



## A VENUE PERFECT FOR ANY EVENT

Celebrate parties, gatherings and your special occasions at the stunning multipurpose hall - the perfect space for every occasion.



CAFETERIA



## EAT, DRINK & UNWIND

Hang out with friends for those never-ending conversations or just sit in peace and enjoy that fresh breakfast you have ordered. Relax and unwind after work, over a cup of evening tea or fresh juice.

GUEST ROOM



LIBRARY



## PRIVATE. COSY. INTIMATE.

Treat your guests to a warm and welcoming space that they love. The exclusive interior and exterior guest bedrooms at Sannidhi Retreat offer a space that you can be proud to offer your guests.



## A RESPITE FROM EVERYDAY LIFE

Satisfy your love of reading and get surrounded by people who love books at the peaceful library. Spend some time for yourself every day, reading your favourite book.







Statue of Equality

Hyderabad-Bengaluru Highway

400 Years Old Venkateshwara Temple



Symbiosis University

P & G Amazon

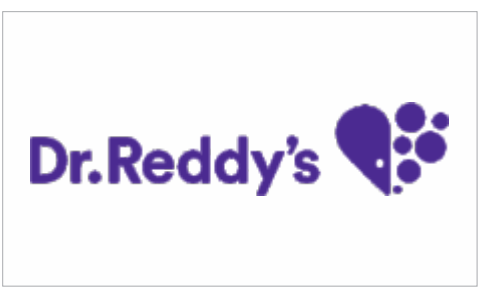

NATCO and LV Prasad Eye Hospital

Amazon Data Centre

ISRO Centre



Symbiosis University



## A LOCATION THAT RESONATES GROWTH

Build your home in an alluring location that delights you in every way, every day. Located in close proximity to the thriving Hyderabad-Bengaluru highway, Udityal has a huge scope for development in and around the area, enabling Sannidhi Walden to be a highly potential residential space for its unique location.



SANNIDHI  
VENTURES

### SCULPTURING DREAMS WITH UTMOST QUALITY

We as a group have been in the real estate business for nearly two decades now. We have, over the years, earned a resounding reputation for building the finest homes in the choicest locations. We present the custom of framing foremost homes with alluring amenities and unique infrastructure and the same applies to our newest venture, Sannidhi Walden.

#### PROJECT CONSULTANTS

ARCHITECTS



LANDSCAPING



NEW MEDIA



your new media partner

GROUP COMPANY



## OUR GROUP PROJECTS

### ONGOING PROJECT



Live Life, King Like

28 Premium Luxurious Villas  
Lo@ Gopanapally, Near Wipro SEZ.

### FEW OF OUR COMPLETED PROJECTS



@ Kondapur



Apartments @ S R Nagar



SERENITY  
HOMES

Villas Layout @ Rajahmundry



3 BHK Apartments  
@ Suncity Bandlaguda



SAISHAKTI'S

AVALON COURT

Commercial Spaces @ Kondapur



Apartments @ Chandanagar



Associate Partner



ROYAL NIRMAN  
FOR A BETTER FUTURE

H.No: 1, MPR Arcade, 98/69/3/53/35, Silicon Valley, Madhapur, Hyderabad, Telangana 500081

Ph: +91 9858718888 | 7337322592

email: [sales@royalnirmangroup.com](mailto:sales@royalnirmangroup.com) | [www.royalnirmangroup.com](http://www.royalnirmangroup.com)

DISCLAIMER: All dimensions are in square feet and square yards excluding construction tolerances. All materials, dimensions, and drawings are approximate only. Information is subject to change without notice, at developer's absolute discretion. Actual area may vary from the stated area. All images used are for illustrative purposes only and do not represent the actual size, features, specifications, plants etc. The developer reserves the right to make revisions / alterations, at it's absolute discretion, without any liability whatsoever.