

Site Address :

Vivanta Elite – 2, Near KP Luxuria, FP No.68/2, Survy No.235/B, Bhayli TP-3, Vasna Bhayli Road, Bhayli, Vadodara 390012, Gujarat.

Contact Details :

+91 75678 68992

+91 88664 31716

Architect :

Hitesh Chokshi & Associates

Structure Consultant :

ZARNA ASSOCIATES

E-mail :

shreemrealty1407@gmail.com

RERA Reg. No :

W: gujrera.gujarat.gov.in

Developers

Shreem Realty

Vivanta

Elite II

3 bhk Lavish Apartments

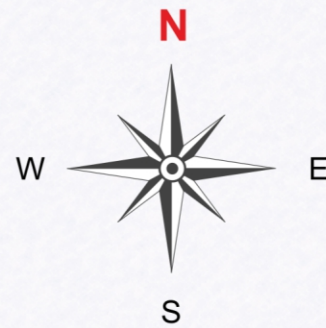
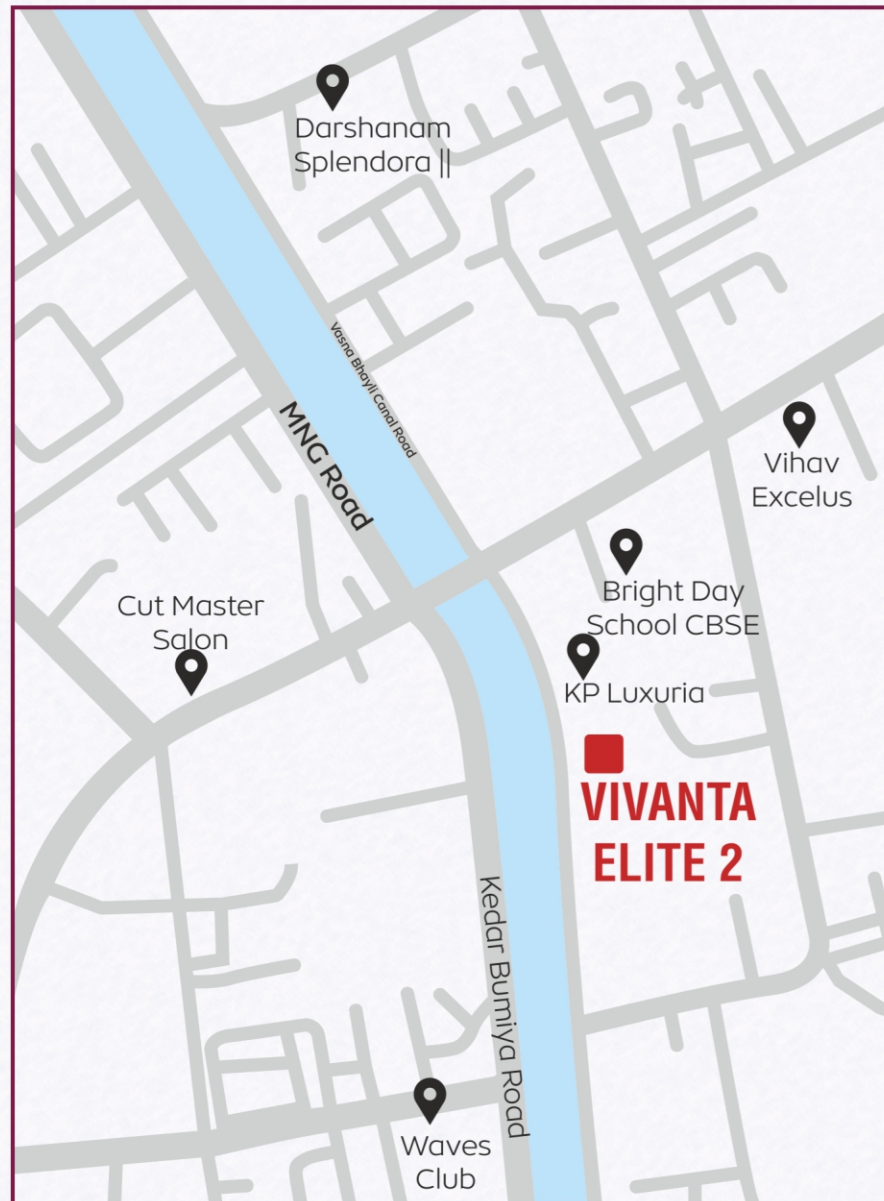

Vivanta

Elite II

3 bhk Lavish Apartments

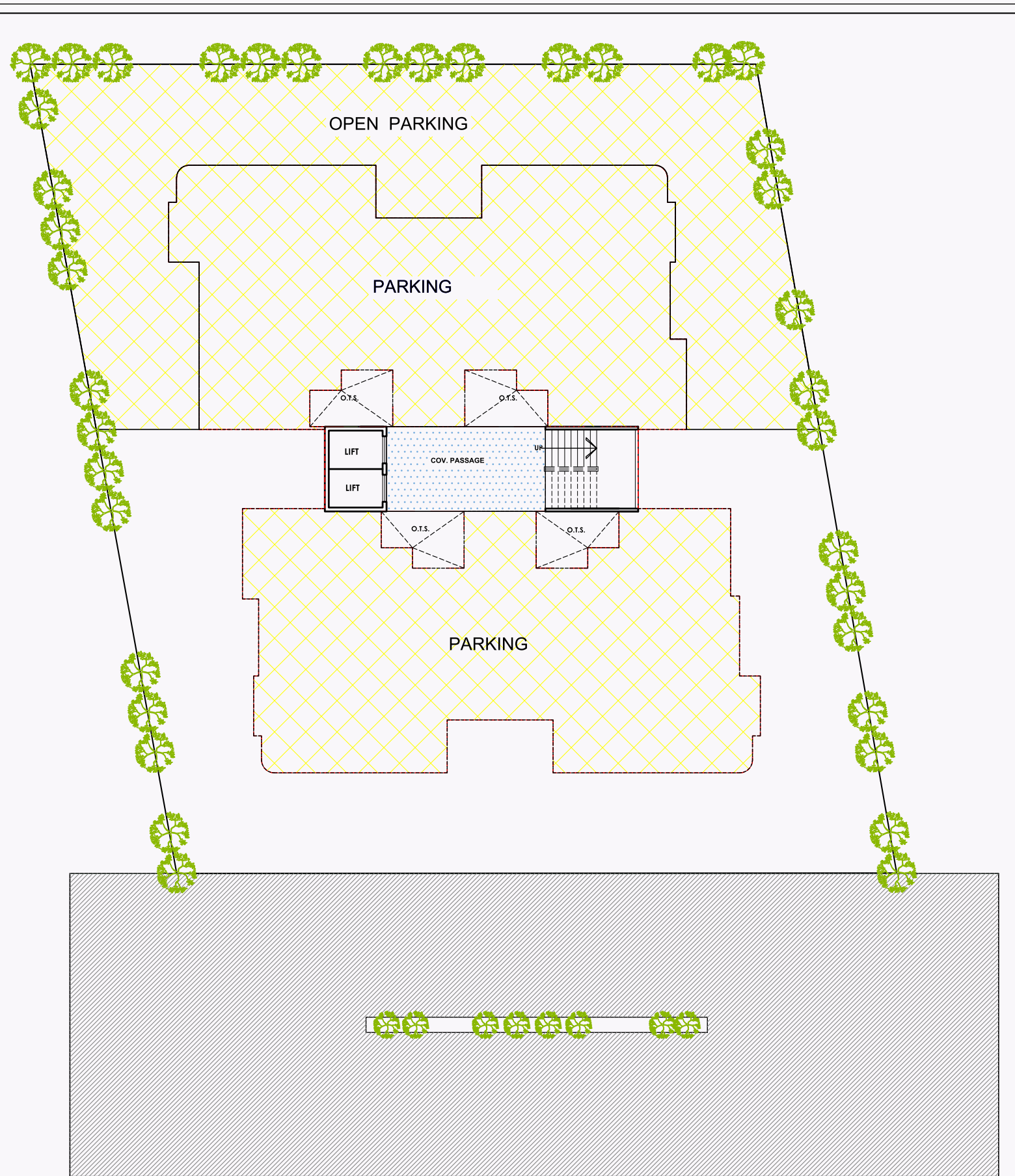

LAY-OUT PLAN

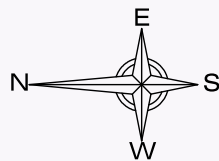

**PROP. LAYOUT & BUILDING PLAN ON T. P. NO. :- 03, F. P. NO. :- 68/2,
AT:- BHAYLI, VILLAGE :- BHAYLI , VADODARA.**

Hitesh Chokshi & Associates
Phone : (M) 982403399
B - 31, Dhankari Apartments,
CSP, Royal Enfield Showroom,
Rajpur Circle,
Vadodra - 390015.
Mail : hiteshchokshi@gmail.com

Floor Plan



Amenities

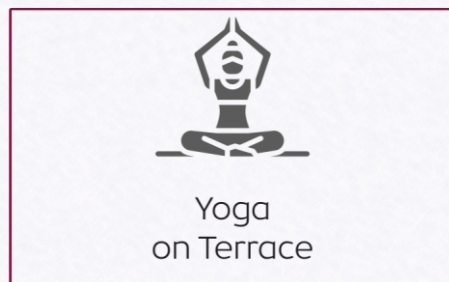

Specification

- STRUCTURE** : Well designed RCC frame structure with good quality material as per structural Engineer's design and specifications.
- FLOORING** : Vitrified tiles flooring with skirting in entire Apartment.
- DOORS** : Elegant entrance door and flushed interior door with wooden figure laminated.
- WINDOWS** : UPVC sliding windows.
- PAINTS** : Interior walls painted with plastic emulsion, exterior paint with water proof and fungal resistant paint.
- WATER SUPPLY** : Underground and overheated tank 24 hours water supply with auto control system.
- KITCHEN** : Premium quality granite platform with ss sink & full Height dado with designer tiles above platform.
- ELECTRIFICATION** : Branded ISI concealed copper wiring with suitable MCB'S in each flats and elegant modular switches. Provisions for cable tv in drawing room and master bedroom. A. C point in all master bedroom.
- BATHROOM & TOILET** : Concealed plumbing with branded fittings and sanitary vessels. Designer toilet with ceramic tile flooring and glaze tiles upto slab level.
- ENTRANCE GATE** : Aesthetically designed compound wall with Ms gate.
- LOBBY** : Well decorated entrance lobby.
- TERRACE** : Heat and water proofing treatment at the terrace.
- LIFT** : Standard quality lift with power backup.
- SECURITY** : Fast and efficient communication & security through intercom system in all flats.
- PAYMENT MODE:**
 - As per RERA Rules.
- DISCLAIMER**
 - G. E. B., V. M. C., Legal and other govt. charges shall be paid separately.
 - Maintenance deposit shall be paid separately.
 - Any additional liabilities due to change in the by laws, stamp duty govt. laws shall be borne by the members.
 - Right of any changes in dimension, elevation, FSI statement & specification will be reserved with the developers, which shall be binding for all members.
 - External changes shall not be allowed.
 - Possession of apartments shall be given one month after the completion of construction & settlement of all due payments to the developers.
- GOVT. LEVIES & LEGAL CHARGES**
 - Taxes like GDT/ CGST or any other charges or taxes levied by any govt. authority has to be borne by the member separately.
 - Stamp duty & registration charges are not included in the basic cost & has to be paid by the member separately as applicable.
- NOTE**
 - This Brochure is. Meant for information, presentation. & guidance purpose only. it is not agreement or authorised document