

VASISHTA
INFRA PROJECTS

On A Mission To Raise Standards And Deliver Class

Vasishta Infra Projects is a new real estate development company built on years of experience and understanding of what makes a happy home. The organisation's keen sense of quality, dedication to its customers, and focus on future-centric construction techniques are the pillars that make it a trusted dream home builder.

In the coming years, the organisation plans to scale new heights in the luxury residential space by delivering upscale lifestyles adorned with quality and convenience. Olympia is the first step towards this journey. It's time to turn the page and immerse yourself in what superior living feels like.

A project by
VASISHTA

Welcome To Your Sanctuary Of Luxury

Step into the finest abode in Vijayawada and prepare to own it with pride.

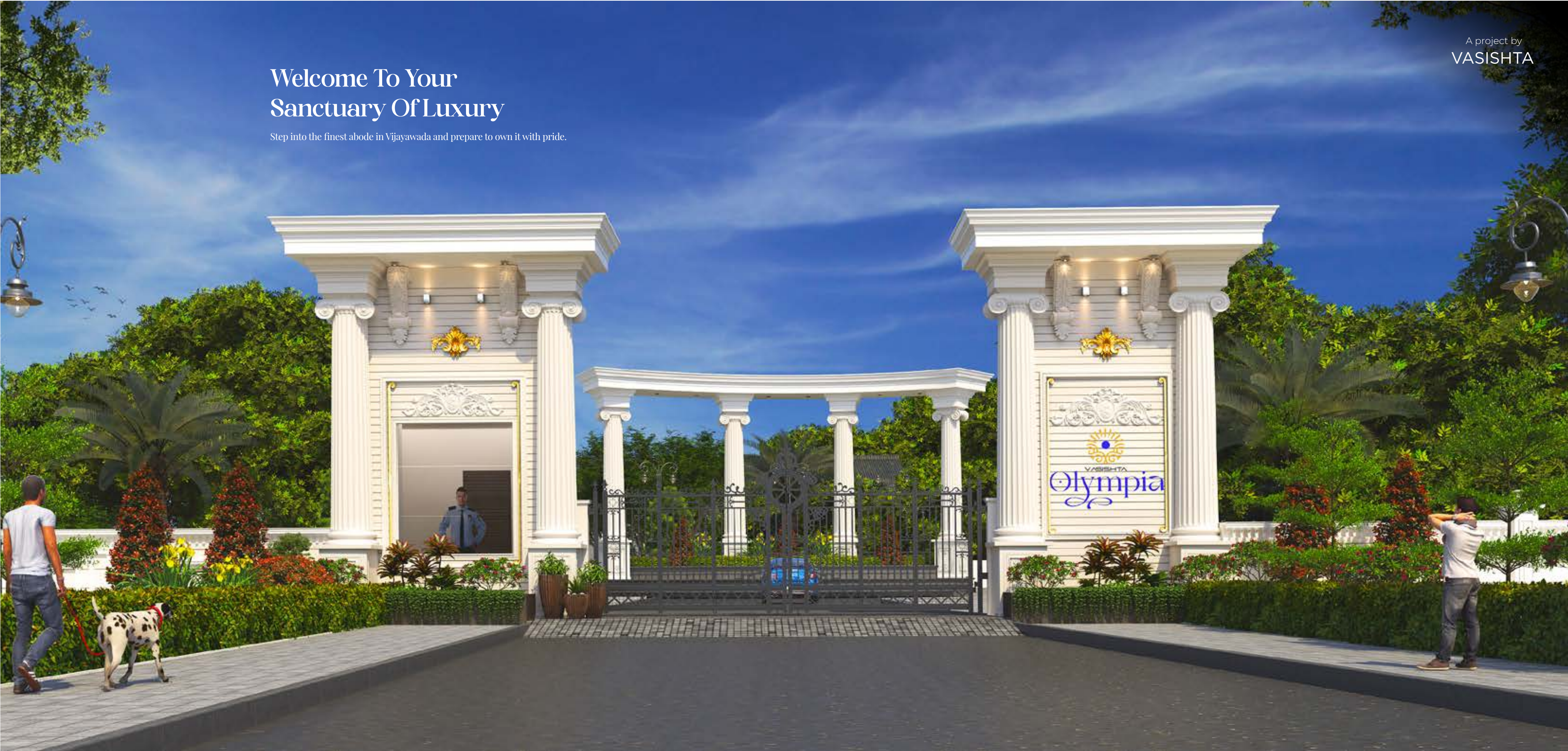

A project by
VASISHTA

A Touch Of Europe In Vijayawada

Nestled amidst 4 acres of serenity, Olympia redefines luxury living with its European-inspired architecture and unparalleled amenities. Each spacious home is meticulously crafted to the highest standards, offering the ultimate in comfort and style. Immerse yourself in an ambience that reflects your great taste, where every detail is thoughtfully curated to elevate your lifestyle.

PROJECT OVERVIEW

30 *Blocks*

150 *Units*

G+5 *Floors*

04 *Acres*

TOWARDS PORANKI

TOWARDS NIDAMANURU

Designed To
Deliver Royal Comfort



MASTER PLAN

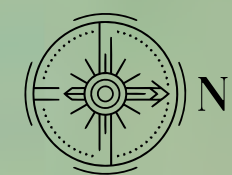

Where Love & Growth
Flourish In Harmony



A project by
VASISHTA



EAST FACING (2800 SFT)

AREA STATEMENT

Plinth Area : 2105 SFT

Built-up Area : 2529 SFT

Total Area : 2800 SFT

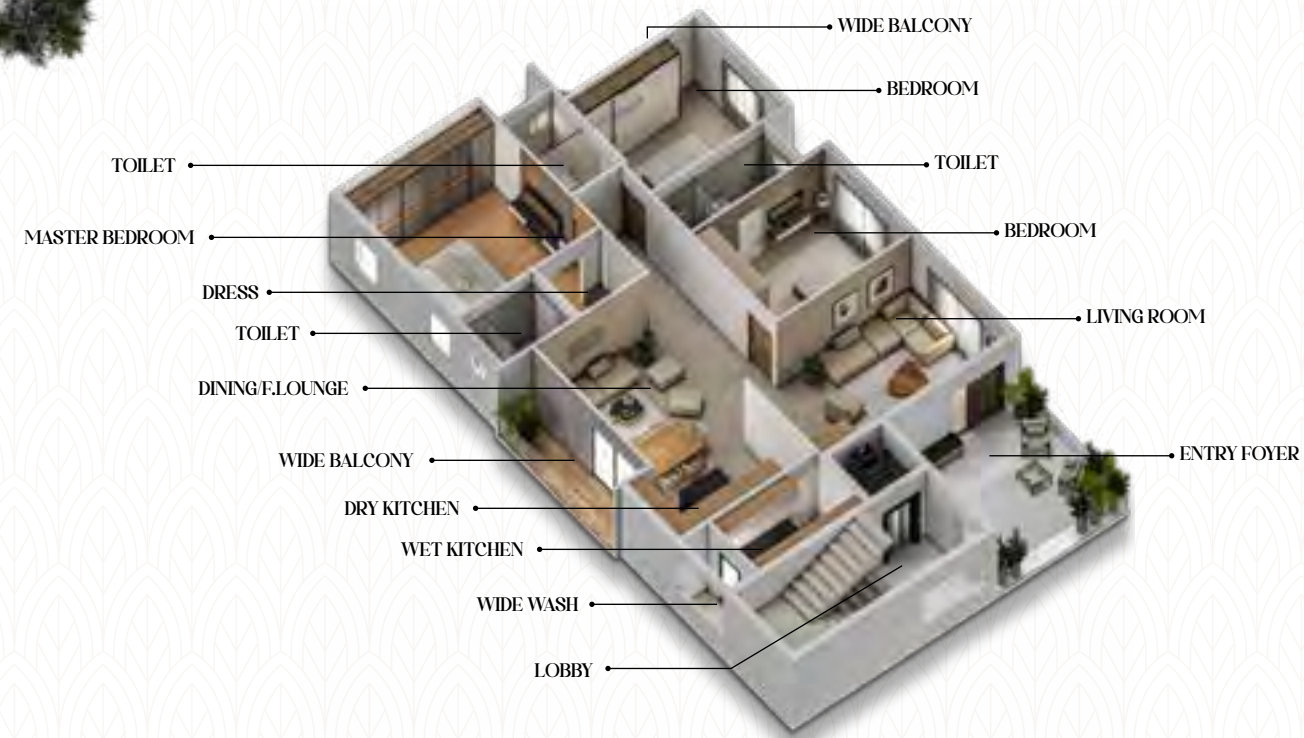

A project by
VASISHTA



WEST FACING



WEST FACING (3060 SFT)

AREA STATEMENT

Plinth Area : 2526 SFT

Built-up Area : 2549 SFT

Total Area : 3060 SFT





The Gateway To An Elite Lifestyle

Olympia isn't just a flourishing community full of luxury and comfort. It is the crown jewel of exceptional living. It seeks to go beyond opulence to provide a life that's fulfilling and engaging. This is where life finds the ideal conditions to flourish brilliantly.



A project by
VASISHTA



NORTH FACING
(3060 SFT)

AREA STATEMENT

<i>Plinth Area</i>	: 2290 SFT
<i>Built-up Area</i>	: 2549 SFT
<i>Total Area</i>	: 3060 SFT



Redefining Luxury Indoors & Outdoors

The European styling of Olympia extends beyond the exteriors and into the interiors of your home here. Each room reflects the refinement and grandness you deserve thanks to the premium materials used to craft each home. You don't just experience the luxury here, you live it daily.



Entry Foyer



Wet Kitchen



Living Room



Master Bedroom

Absolutely
Stunning
Interiors

**All interior renders are for illustrative purposes only.*



Kitchen



The Art Of Design

Interiors

**All interior renders are for illustrative purposes only.*



Timeless Comfort

Living at Olympia is a dream come true because of the amazing attention to detail that has gone into crafting each home. The sleek and vibrant interiors make your home here a class apart. Live in style and own it with pride only at Olympia.





A Green & Serene Space Of Your Own

Imagine having a terrace garden of your own! Each block at Olympia gets an exclusive one that lets you and your family enjoy the fresh air, spectacular views and greenery right at home. The spacious terrace garden is a great place to unwind, find your peace and engage neighbours in a comfortable setting outside the confines of your home.





A project by
VASISHTA



Where Your Lifestyle Becomes Grand

The clubhouse is an extension of your home, designed to help you connect, engage, and unwind. Olympia's 12,000 sft clubhouse offers a range of activities and amenities, ensuring you never have to step outside for entertainment or leisure. It's a haven for relaxation, recreation, and connection right at your doorstep.

CLUBHOUSE AMENITIES



Entry Foyer



Banquet Hall



Library



Guest Rooms



Cafeteria



Mini Theatre



Sitting Lobby



Indoor Games



Yoga



Gym



Dining Hall



Swimming Pool



Designed To
Entertain



Mini Theatre



Library

Shaped With
Care

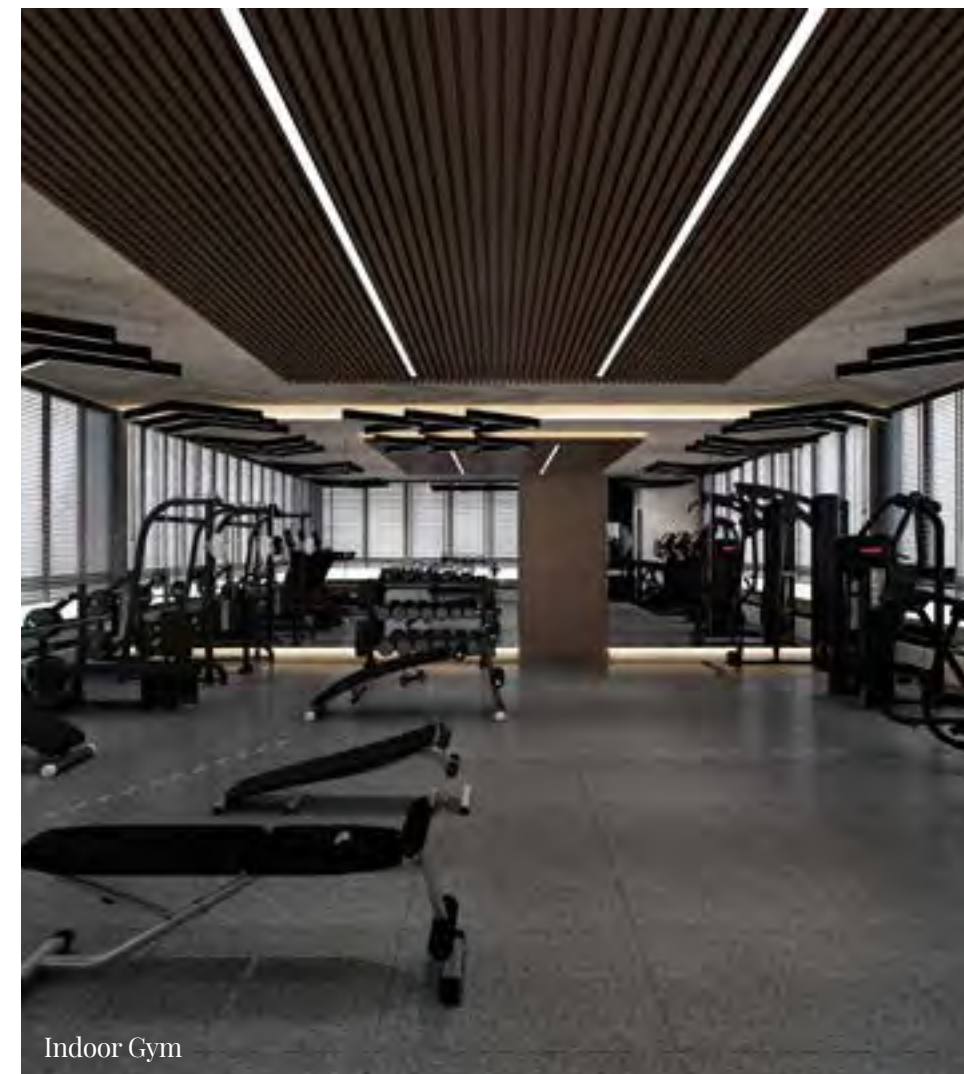

Indoor Gym

Amenities Tailored
To Elevate You

The secret behind a wonderful life is the balance you achieve at home. At Olympia, we have brought all the luxurious elements you will need to embrace that balance. Settle down into a new high where your family lives easily and blooms naturally.

The graphic has a solid brown background. At the top center is the Vasishtha logo. Below it, the title "Amenities Tailored To Elevate You" is written in a white serif font. Underneath is a paragraph of white text.

Yoga

Perfected
For Balance



Banquet Hall

Crafted For
Royalty

A project by
VASISHTA

A Lively Environment To Thrive In

The community's green cover is another stellar reason to make Olympia your home. The sprawling lawns, tall trees, and budding plants all over the community bring a sense of purity and natural beauty to the project. Let Mother Nature's loving embrace nurture you in a pollution-free cocoon here.





Walking Path



Kids' Play Area



Walking Path



Amphitheatre



Water Fountain

Your Sanctuary Of Luxury Awaits Your Arrival

When you bring it all together, Olympia is the perfect home for families of all sizes. It has everything you and your loved ones need to grow and prosper in a safe and secure environment. The European aesthetics add a layer of luxury to an already superior home. This is one of Vijayawada's most elite homes beyond a doubt.





Dive Into A Life Of Style & Luxury

The luxury and comfort on offer at Olympia extend beyond your home here. From the feature-rich clubhouse to the soothing swimming pool, life in this magnificent community is exceptional because of the amazing conveniences you experience here. You don't just live here, you flourish.

SPECIFICATIONS



STRUCTURE

- RCC framed structure
- Walls: 9" thick external & 4.5" internal walls

CEMENT

- Zuari, Raasi, Maha, Deccan or equivalent

STEEL

- Simhadri TMT or equivalent

BRICK

- Red Brick (Country Brick)



DOORS

- Main Door: Teak wood frame with teak wood shutter polished and fitted with reputed make hardware
- Other Doors: Made with engineered wood frames and flush doors



FRENCH DOORS & WINDOWS

- French Doors: UPVC sliding door complete with 6 mm toughened glass of reputed make and provision for fly-proof shutter.
- Windows: UPVC window with 5 mm plain glass with provision for mosquito mesh shutter.
- Grills: Aesthetically designed, MS grills with enamel paint finish.



FLOORING

- 600 mm x 1200 mm Glazed Vitrified Tiles (GVT) of reputed make for Living/Drawing/Bedrooms and Kitchen of AGL/Somany/Varmora or equivalent . 600 x 600 mm size ceramic tiles in washroom & balconies.
- Staircase: Granite flooring



TOILETS

- Anti-skid glazed vitrified tiles for flooring, glazed ceramic tile dado up to 8ft height in toilets of AGL/Somany/Varmora or equivalent make.



KITCHEN

- Granite platform with stainless steel sink, 2' height ceramic tiled dado above platform.



PARKING

- 2 car parking spaces for each flat.



CHARGING POINT

- Charging provision for e-vehicles in the parking areas.



SANITARY

- Kohler/American Standard/Grohe/Sanitaryware or equivalent make CP fittings



ELECTRICAL

- Concealed copper wiring & switches of Legrand/Polycab/Panasonic or equivalent make



FALSE CEILING

- False ceiling with 30 LED lights in the entire flat. Entry foyer ceiling: engineered wood finish



PAINTING

- Asian/Berger or equivalent emulsion paint for interiors, waterproof emulsion paint for exterior. Putty/Wallcare - Asian/Berger or equivalent



TERRACE GARDEN

- Pergola/Barbeque/Sit-out in every block



AIR CONDITIONING

- Provision for split AC system for living, dining, and all bedrooms with electrical and drain provision



TV & TELEPHONE

- TV point in Living/Dining & all Bedrooms



POWER BACKUP

- Generator for lights, fans & common services



LIFT

- Johnson/OTIS/Altis or equivalent



SECURITY

- Intercom facility, surveillance cameras at staircase, lifts and main gate
- Biometric: Biometric access control at entrance gate

LOCATION MAP

(Not to Scale)

Vijayawada
Railway Station



Vijayawada
International Airport

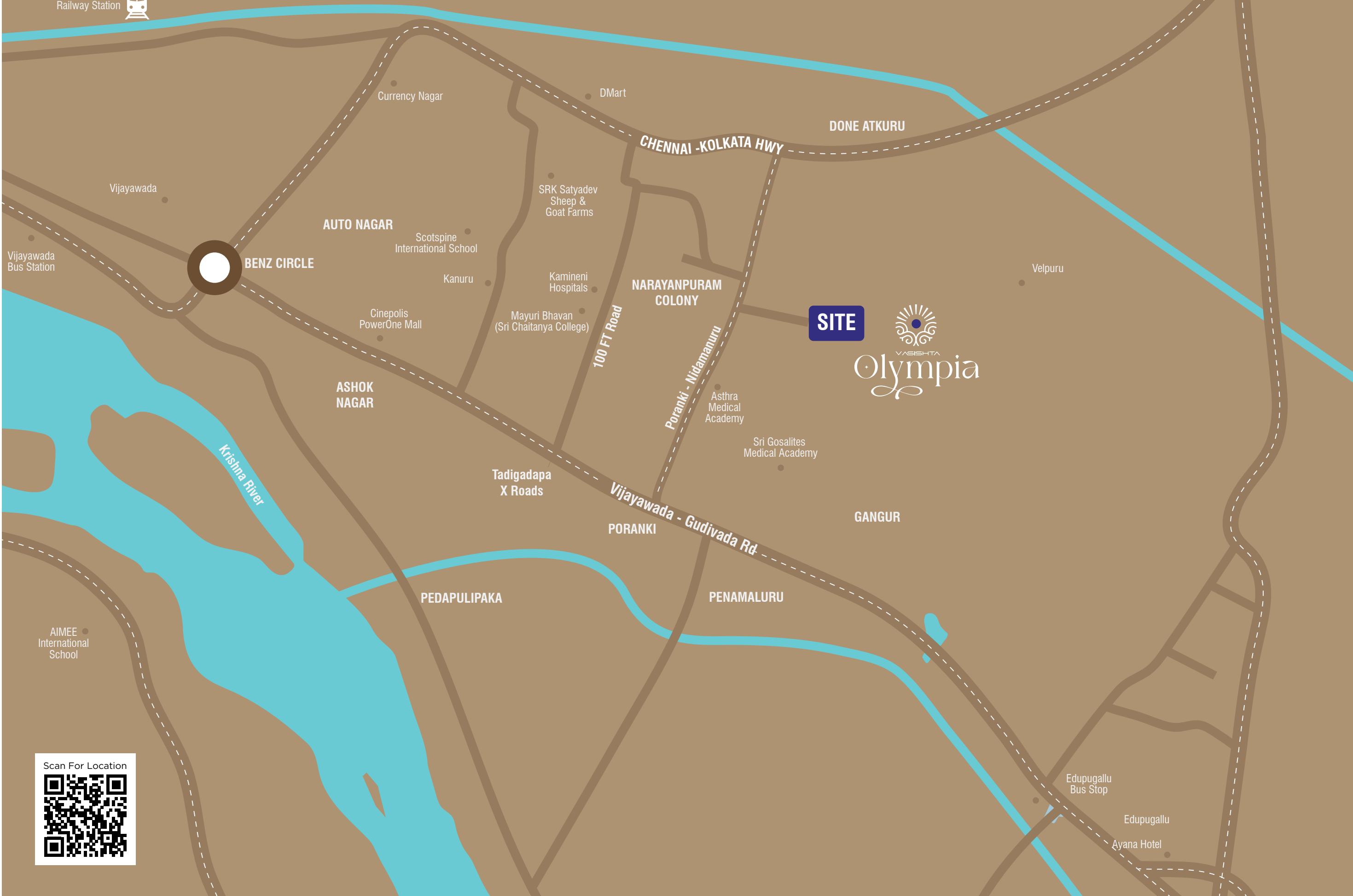

Scan For Location

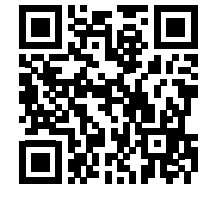

CONNECTIVITY



EDUCATION INSTITUTES

- Bloomingdale International School
- Delhi Public School
- Bhashyam Blooms The Global School
- Slate School
- Sidhartha Engineering College
- Shamrock International school



IT HUB

- Best Price
- Medha IT Park
- Ushodaya Mart



HOSPITALS

- Kamineni Hospital
- Capital Hospital
- Anu My Baby
- Nagarjuna Hospital



CONNECTIVITY

- Bandar Road
- Eluru Road

AP RERA NO: P06180064465 | LP NO: 40/2023/1192/APCRDA/DPMS

Scan For Website



Site Address:

VASISHTA INFRA PROJECTS
Beside Murali Resort Function Hall,
Poranki - Nidamanuru Road, Poranki,
Krishna District, Vijayawada, A.P.

OUR PARTNERS

ARCHITECTS



3D RENDERERS &
WALKTHROUGH BY



BRAND PARTNER



NOTE: This brochure is purely conceptual and not a legal offer. Area is tentative and actual areas arrived at completion of the flat may differ. The promoters reserve the right to make changes in elevation, plans & specifications as deemed fit.